

The

WOLSELEY

21/60 H.P. SIX-CYLINDER CAR
“COUNTY” MODEL

SPARE PART LIST No. 942

WOLSELEY MOTORS (1927) LTD.
BIRMINGHAM, 8

WOLSELEY MOTORS (1927) LIMITED

Governing Director . . . SIR WILLIAM R. MORRIS, BT.

.....

The

WOLSELEY

21/60 H.P. SIX-CYLINDER CAR
"COUNTY" MODEL

SPARE PART LIST No. 942

Head Office and Works - - DREWS LANE, WARD END, BIRMINGHAM, 8
Telegrams: "EXACTITUDE, BIRMINGHAM" *Telephone:* BIRMINGHAM EAST 1501 *Telex Telephone:* EAST TELEX 0404
London Repair Works - - - - EUSTACE WATKINS LTD., MANOR STREET, CHELSEA, S.W.

WOLSELEY MOTORS (1927) LIMITED

Governing Director . . . SIR WILLIAM R. MORRIS, BT.

.....

The

WOLSELEY

21/60 H.P. SIX-CYLINDER CAR
"COUNTY" MODEL

SPARE PART LIST No. 942

Head Office and Works - - DREWS LANE, WARD END, BIRMINGHAM, 8
Telegrams: "EXACTITUDE, BIRMINGHAM" *Telephone:* BIRMINGHAM EAST 1501 *Telex Telephone:* EAST TELEX 0404
London Repair Works - - - - EUSTACE WATKINS LTD., MANOR STREET, CHELSEA, S.W.

CONTENTS

	Page		Page
AXLES AND WHEELS		ELECTRICAL EQUIPMENT	
Front Axle	25	Battery	15, 35
Front Hub	25	Dynamo	15
Rear Axle	27	Distributor	15
Rear Hub	27	Electric Horn	15, 31
Road Wheels	27	Instrument Panel	15
BUMPERS AND FITTINGS	35	Lamps	15, 31
BRAKES		Starter	15
Front Wheel Brake	29	Indicators	15
Rear Wheel Brake	29	FREE WHEEL	21, 23, 31
BONNET	39	FRAME AND FITTINGS	35
CARRIAGE FITTINGS	40	FOOT CONTROL	
CLUTCH	19	Accelerator	17
DASHBOARD	39	Brakes	33, 37
ENGINE		Clutch	19, 33
Air Cleaner	9	GREASERS AND FITTINGS	37
Crankcase and Cylinders	5	GEARBOX	
Cylinder Head	9	Bearings	21
Crankshaft and Bearings	7	Free Wheel	21, 23, 31
Camshaft and Bearings	9	Gearcase and Covers	19, 21
Connecting Rods and Pistons	7	Gears and Shafts	19, 21
Carburetter	17	HAND CONTROL	
Chains and Chain Wheels	11	Brake	33
Coil	15	Change Speed	23
Dynamo	15	Free Wheel	23, 31
Damper on Crankshaft	7	Ignition	31
Distributor	15	Jet	31
Exhaust Manifold	39	Throttle	31
Engine Support Details	5	IGNITION	15, 31
Fan	9	LOCKHEED PIPES	33, 37
Flywheel	19	LUGGAGE GRILLE	40
Ignition	15, 31	PROPELLER SHAFT AND UNIVERSAL JOINTS	23
Inlet Manifold	17	PETROL TANK	
Oil Base	5	Petrol Tank	39
Oil Pump	11	Petrol Pipes	39
Oil Strainer	13	ROAD SPRINGS AND SUSPENSION	35, 37
Oil Cleaner	13	RADIATOR AND FITTINGS	39
Oil Filler	13	STEERING	25, 31
Oil Pipes	13	SILENCER AND EXHAUST PIPES	39
Valves and Valve Springs	9	SHOCK ABSORBERS AND FITTINGS	35
Valve Rockers and Shaft	9	SPARE WHEEL CARRIER	40
Water Inlet Pipe	5	TOOL KIT	41
Water Pump	11	WINGS AND RUNNING-BOARDS	40
Water Outlet Pipe	9		

WOLSELEY 21/60 H.P. (SIX-CYLINDER) COUNTY MODEL

INTRODUCTION

THIS list of Spares for the Wolseley 21/60 h.p. Cars has been compiled in order to facilitate the ordering of parts which require replacement. The parts are grouped into components, and all the principal pieces are illustrated. When ordering, clients should quote the Service Number, together with the description of the part, in order to minimise the possibility of error.

We would particularly impress upon clients the importance of always quoting the MAKER'S CAR NUMBER (not Registration Number), which will be found on the metal name-plate on the Dashboard Shroud under the Bonnet. The ENGINE NUMBER will be found on the Engine Case (Near-side Rear), and should be quoted in addition to the Car Number when ordering Engine spares. The CHASSIS NUMBER will be found on the Dashboard Shroud under the Bonnet and should be quoted in addition to the Car Number when ordering Chassis spares.

We reserve to ourselves the right to alter any part as may be considered advantageous, and therefore it is possible that illustrations shown in this book may not in all cases exactly resemble the actual part required.

All parts sent to be repaired must be forwarded carriage paid. These may be forwarded to either of the addresses on the title page, and must bear the Sender's Name, Address, and Maker's Car Number.

All parts sent for repairs are acknowledged as soon as received.

To avoid delay, customers with whom we have no ledger account should send cash with order.

See separate Schedule for Prices.

Instruction Manual shows List of Service Stations for Proprietary Articles.

In order to assist customers who desire to send a telegram, we give below the telegraphic codes referring to service matters—

NMMAE	...	Wolseley 21/60 h.p. Car No.....
SEREB	...	Referring to your communication Service Manager dated.....
SEREM	...	Referring to your communication Estimating dated.....
SEREP	...	Referring to your communication General Office dated.....
SERFU	...	Despatch immediately per post and charge our account for Car No.....
SERGI	...	Despatch immediately per passenger train and charge our account for Car No.....
SERJO	...	Despatch per post direct to Customer and charge our account for Car No.....
SERKS	...	Despatch per passenger train direct to Customer and charge our account for Car No.....
SERMY	...	Advise delivery date for our Order No.....
SERNA	...	Please quote but do not supply pending official order for following spares for Car No.....
SEROT	...	Can you supply from stock for Car No.....
SERSK	...	Priced invoice to be sent with spares.
SERTE	...	Complete with all fittings.
SERUS	...	With studs and nuts only.
SERYL	...	Complete with bearings.
C.O.D.	...	Cash on Delivery.

WOLSELEY MOTORS (1927) LTD.

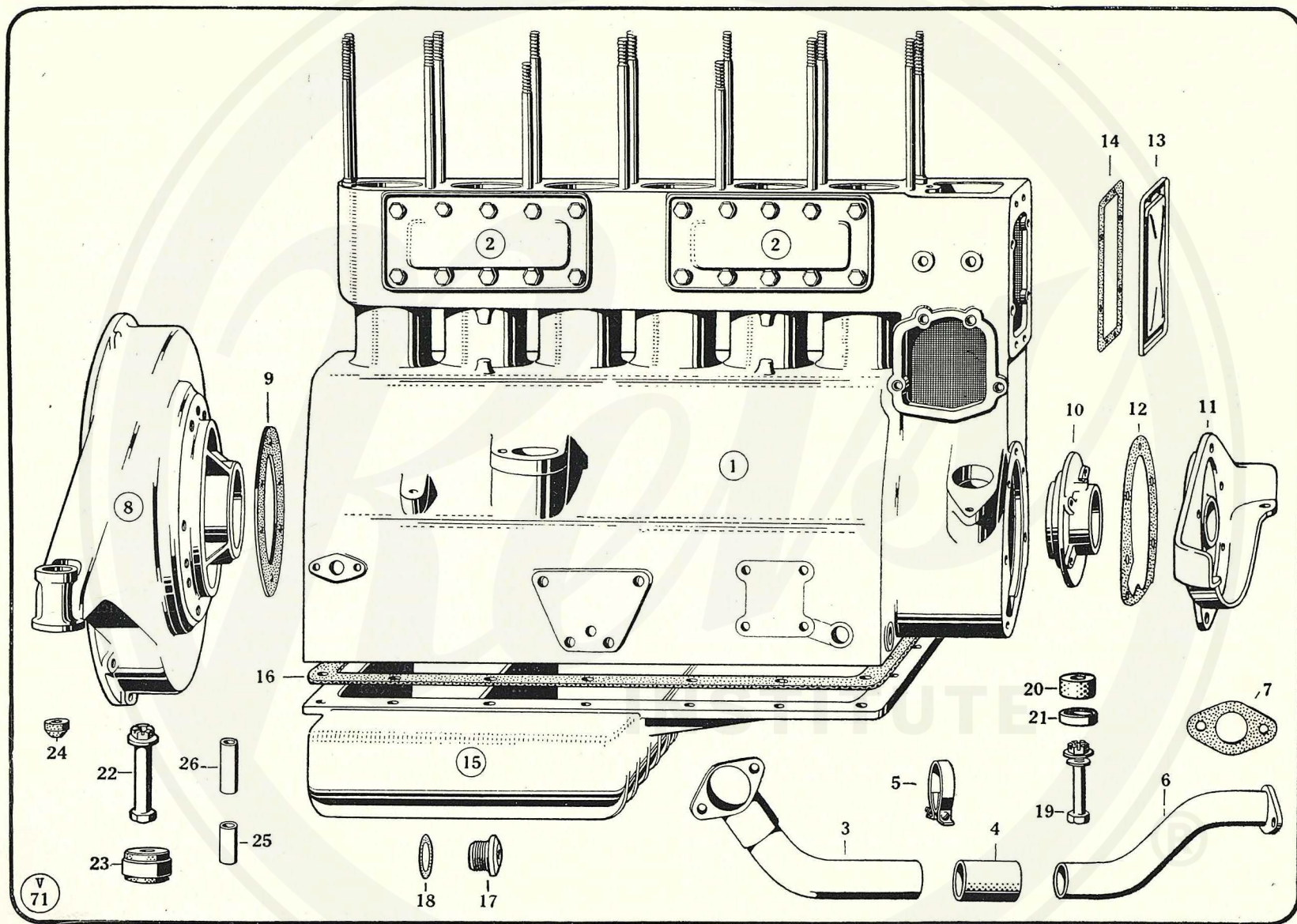

WOLSELEY 21/60 H.P. (SIX-CYLINDER) COUNTY MODEL

Crankcase, Oil Base and Engine Support Details

No. of Illustration.	Service No. for Ordering.	Description of Part.	No. of Illustration.	Service No. for Ordering.	Description of Part.
Crankcase and Cylinders			13	V3019	Cover for Chain Case
1	V5001A	Crankcase and Cylinders complete with Water Jacket, Covers and Main Bearings ("A" Type)	14	V3020	Joint for Chain Case Cover
	V5002A	Crankcase and Cylinders complete with Water Jacket, Covers and Main Bearings ("B" Type)	<i>Note :—For Engine Chains and Wheels see Page 11.</i>		
2	M7	Cover-plate for Cylinder Jacket (Front or Rear)	Oil Base		
—	M9—1	Joint for Cover-plates (Front or Rear)	15	V3031A	Oil Base complete
—	M10	Set Screw for Cover-plates	16	G27	Joint for Oil Base
—	V3007	Set Screw for Cover-plate and Ignition Coil	17	G29	Drain Plug for Oil Base
3	V3008A	Water Inlet Pipe (Rear Portion)	18	G30	Washer for Drain Plug
4	V3009	Rubber Hose for Inlet Pipes	Engine Support Details		
5	M1511	Clip for Rubber Hose	19	V3041A	Front Engine Holding-down Bolt, Nut, Washer and Split Pin
6	V3011A	Water Inlet Pipe (Front Portion)	20	V42	Rubber Seating Block for Engine (Front)
7	M12	Joint for Water Inlet Pipe (Front or Rear)	21	V43	Cup for Seating Block (Front)
		<i>Note :—For Rubber Hose to Radiator see Page 39.</i>	22	V3044A	Rear Engine Holding-down Bolt, Nut, Washer and Split Pin
8	V5013A	Bell Housing complete with Main Bearing	23	G46	Rubber Seating Block for Rear Engine Arm complete with Metal Ring
9	G11	Joint for Bell Housing	24	G48	Coned Rubber Seat for Rear Engine Holding-down Bolt
—	V3015	Set Screw for Bell Housing to Crankcase	25	V3047	Distance Piece for Bolt (Rear) (Short)
10	V3016	Housing for Front Crankshaft Bearing	26	V3048	Distance Piece for Bolt (Rear) (Long)
11	V5017A	Front Cover and Engine Front Support			
12	V3018	Joint for Front Cover			

Please state maker's CAR NUMBER and ENGINE NUMBER when ordering. See note on Page 3. Prices of Spare Parts are shown on separate list.

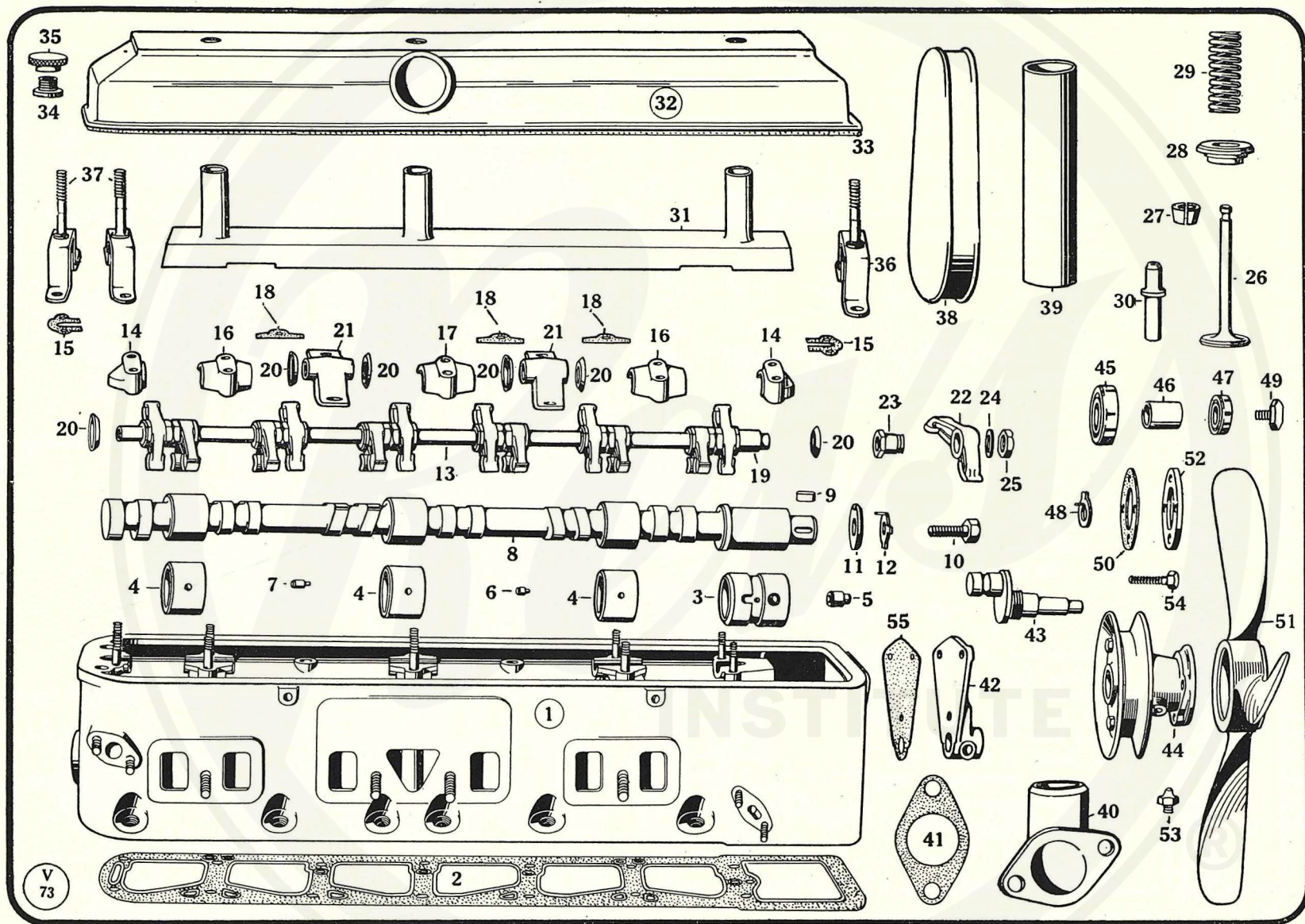

WOLSELEY 21/60 H.P. (SIX-CYLINDER) COUNTY MODEL

Cylinder Head, Camshaft, Valves, Air Cleaner and Fan

No. of Illustration.	Service No. for Ordering.	Description of Part.	No. of Illustration.	Service No. for Ordering.	Description of Part.
Cylinder Head and Camshaft					
1	V5201A	Cylinder Head (Studded)	33	V3247	Joint for Cylinder Head Cover
2	V5202	Joint for Cylinder Head	34	V3248	Cover Nut for Cylinder Head
3	V3203	Bearing Bush for Camshaft (Front End)	35	E97—J	Head for Cover Nut
4	V3204	Bearing Bush for Camshaft (Intermediate or Rear)	36	V3249A	Strap for Cylinder Head Cover (Front) with Stud
5	V3205	Dowel for Front Bearing Bush	37	V3250A	Strap for Cylinder Head Cover (Intermediate or Rear) with Stud
6	V3206	Dowel for Intermediate or Rear Bearing Bush	38	V3251A	Air Cleaner Banjo
7	V3206	Dowel for Centre Bearing Bush	39	V3252	Hot Air Pipe
8	V3208	Camshaft	Water Outlet Pipe		
9	V3209	Key for Camshaft Chain Wheel	40	V5261	Water Outlet Pipe
10	V3210	Set Screw for Camshaft	41	V3262	Joint for Water Outlet Pipe
11	V3211	Washer for Camshaft	Fan		
12	V3212	Tab Washer for Camshaft	42	V5265A	Fan Pulley Bracket
<i>Note :—For Camshaft Chain Wheel see Page 11.</i>			43	V5266	Fan Spindle
Valves and Valve Rockers			44	V5267A	Fan Pulley complete
13	V3213	Shaft for Valve Rockers	45	V5268	Rear Ball Bearing for Fan
14	V3214	Cap for Rocker-shaft (Front or Rear)	46	V5269	Distance Piece for Fan Bearings
15	V3215	Joint for Cap (Front or Rear)	47	V5270	Front Ball Bearing for Fan
16	V3216	Cap for Rocker-shaft (Intermediate)	48	V5271	Locking Washer for Bolt
17	V3218	Cap for Rocker-shaft (Centre)	49	V325	Bolt for Fan Spindle (Front End)
18	V3217	Joint for Cap (Intermediate or Centre)	50	V380	Joint for Fan Centre
19	V3219	Distance Piece for Rocker-shaft (Front End)	51	V5274	Fan
20	V3220	Belleville Washer for Rocker-shaft	52	V5275	End Cover for Fan Centre
21	V3221A—1	Steady Bracket for Rocker-shaft	—	V5276	Fan Belt
—	V3232	Packing Shim for Steady Bracket	53	TG101	Greasers for Fan
22	V3222	Valve Rocker-arm (Inlet)	54	M817	Pinch Bolt for Fan Spindle
—	V3223A	Valve Rocker-arm (Exhaust)	55	V3242	Joint for Fan Bracket
23	V3224	Eccentric Bush for Valve Rocker	Sub-Assemblies		
24	V3225	Locking Washer for Eccentric Bush	—	V5281A	Cylinder Head complete with Camshaft, Valves, etc. (less Cover and Water Outlet Pipe)
25	V3226	Locking Nut for Eccentric Bush	—	V3282A	Valve Rocker complete with Eccentric Bush and Lock Nut (Inlet)
26	V3227	Inlet or Exhaust Valve	—	V3283A	Valve Rocker complete with Eccentric Bush and Lock Nut (Exhaust)
27	V3228	Split Collar for Valve (two halves)	—	V5284A	Fan complete (less Bracket)
28	V3229	Valve Spring Cup	<i>Note :—For Fan Pulley on Dynamo see Page 15.</i>		
29	V3230	Valve Spring			
30	V3231	Valve Guide			
Cylinder Head Cover and Air Cleaner					
31	V3244A	Air Cleaner Cover-plate			
32	V3246A	Cylinder Head Cover with Joint and Holding-down Nuts			

Please state maker's CAR NUMBER AND ENGINE NUMBER when ordering. See note on Page 3. Prices of Spare Parts are shown on separate list.

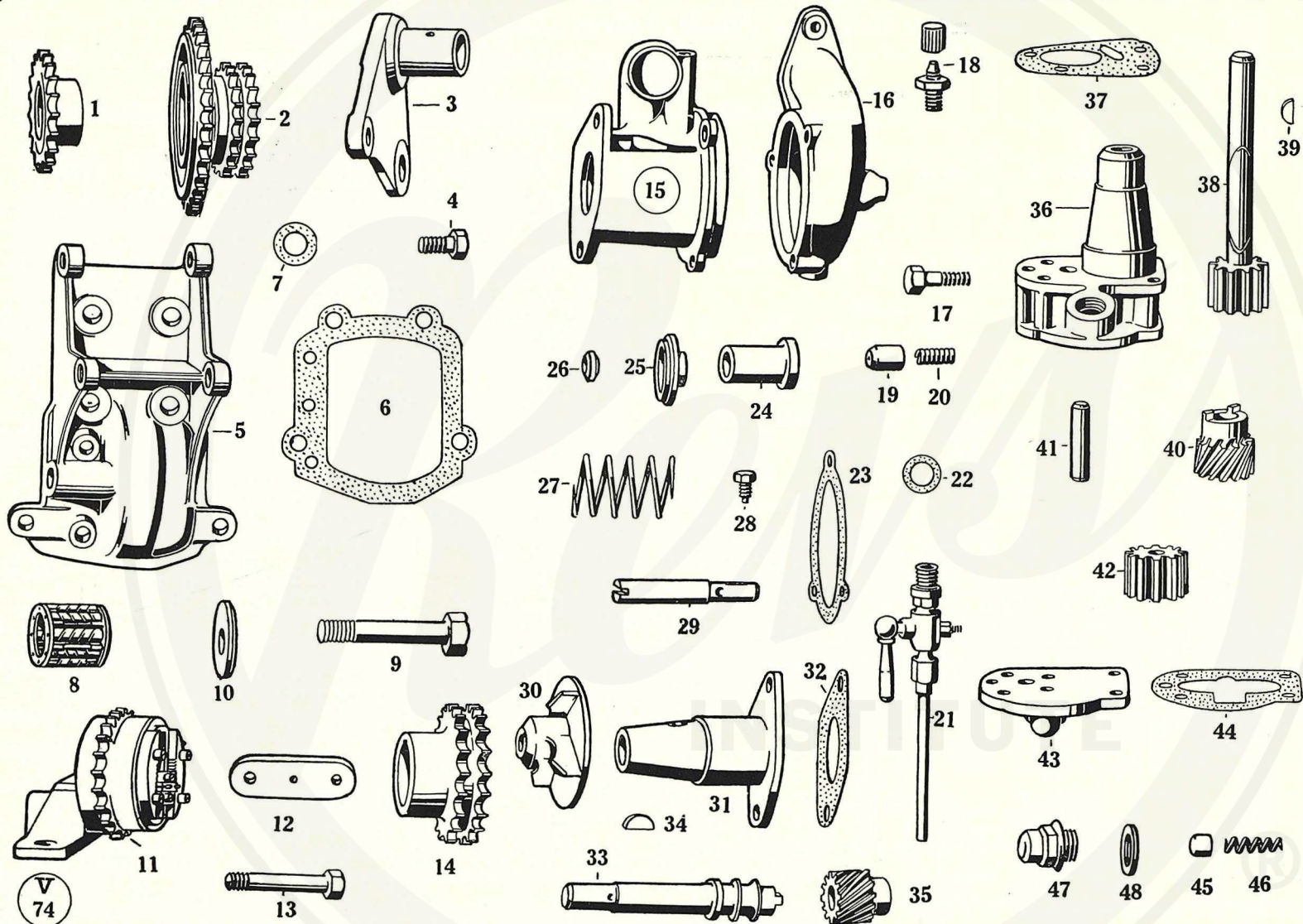

WOLSELEY 21/60 H.P. (SIX-CYLINDER) COUNTY MODEL

Engine Chains, Chain Wheels and Fittings, Water Pump and Oil Pump Details

No. of Illustration.	Service No. for Ordering.	Description of Part.	No. of Illustration.	Service No. for Ordering.	Description of Part.
Engine Chains and Wheels					
1	M2301—1	Crankshaft Chain Wheel	24	M2340—1	Bush in Pump Body
—	V3302	Single Roller Chain (Endless)	25	M2352	Gland Collar
2	M2303A	Countershaft Chain Wheel complete	26	M2353	Gland
3	V3304	Support Bracket for Countershaft Chain Wheel	27	M2354	Spring for Gland
4	V3305	Set Screw for Support Bracket	28	F125	Locking Screw for Bush
5	V3306A	Bracket for Chain Tensioner and Dynamo	29	M2342	Water Pump Spindle
6	M2025	Joint for Bracket	30	M2344	Pump Rotor
7	M2026	Shim for Bracket	—	M2345A	Pump Spindle assembled with Rotor
8	V3309	Hyatt Roller Bearing for Countershaft Chain Wheel	31	M2346	Bracket for Water Pump Spindle
9	M2308	Locking Bolt for Countershaft Chain Wheel	22	M2347	Joint for Bracket
10	V3311	Thrust Washer for Locking Bolt	33	M2348—1	Driving Shaft for Water Pump
—	M2310	Tensioner Chain Wheel	34	M189	Key for Driven Gear
11	M2318A	Chain Tensioner complete with Wheel and Bracket	35	M2350	Spiral Driven Gear for Water Pump
—	V3313	Joint for Chain Tensioner Packing Block	—	M2351A	Driving Shaft complete with Spiral Gear
12	V3314	Packing Block for Chain Tensioner	—	M2361A	Water Pump complete
13	V3315	Bolt for Tensioner Bracket	Oil Pump		
—	V3316	Duplex Roller Chain	36	V3361	Oil Pump Body
—	M2315	Connecting Link and Spring Clip for Duplex Chain	37	V3362	Joint for Oil Pump Body
—	M2317	Spring Clip for Connecting Link	38	V3363	Oil Pump Spindle
14	V3319	Camshaft Chain Wheel	39	H189	Key for Spindle
Water Pump			40	V3365	Oil Pump Spiral Driven Gear
15	M2331A	Water Pump Body (Bushed)	41	V347	Idle Spindle for Driven Gear
16	M2332A	Cover for Water Pump Body (Studded)	42	E2031	Oil Pump Driven Gear
17	M2333	Bolt for Water Outlet Flange	43	V3368—1	Oil Pump Cover
18	M2334	Greaser Nipple for Body or Cover	44	V3369	Joint for Oil Pump Cover
19	M2336	Plunger for Pump Rotor	45	M361—1	Relief Valve
20	M2337	Spring for Plunger	46	M362	Spring for Relief Valve
21	M1504	Drain Tap for Water Pump Cover	47	V3371—1	Plug for Relief Valve
22	GD12	Washer for Drain Tap	48	E24	Washer for Plug
23	M2339	Joint for Pump Body and Cover	—	V3381A	Oil Pump complete with Relief Valve and Spiral Gear
			<i>Note :—For Oil Pipes see Page 13.</i>		

Please state maker's CAR NUMBER and ENGINE NUMBER when ordering. See note on Page 3. Prices of Spare Parts are shown on separate list.

Diagrammatic View of Offside of Engine.

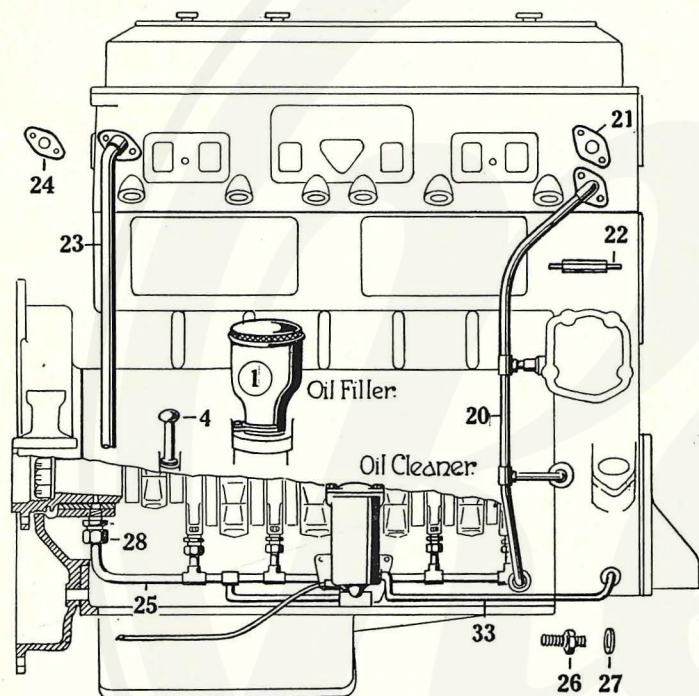

Diagrammatic View of Nearside of Engine.

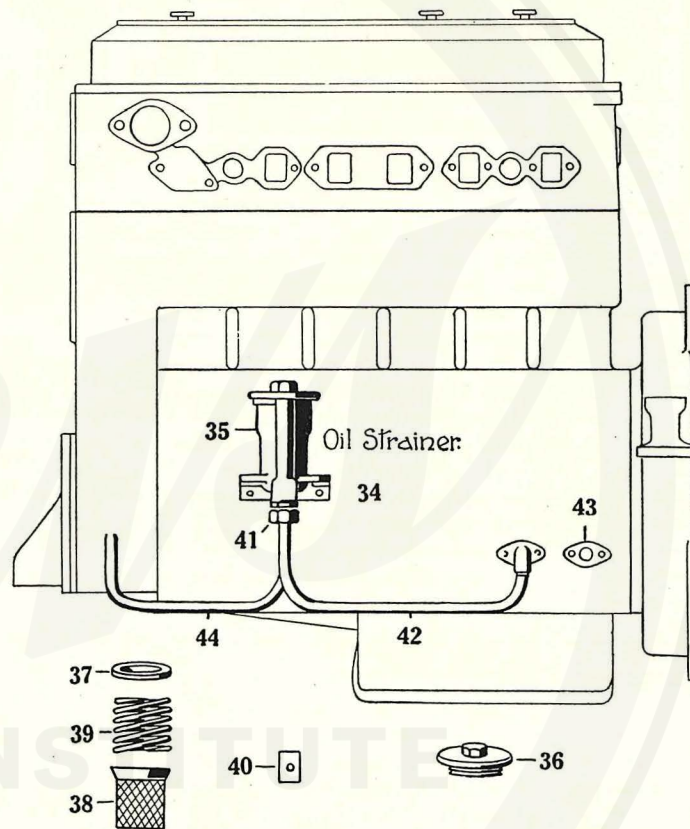

WOLSELEY 21/60 H.P. (SIX-CYLINDER) COUNTY MODEL

Oil Strainer, Oil Filler, Oil Cleaner and Oil Pipes

No. of Illustration.	Service No. for Ordering.	Description of Part.	No. of Illustration.	Service No. for Ordering.	Description of Part.
OFF-SIDE OF ENGINE					
Oil Filler			24	V426	Joint for Drain Pipe Flanges
1	V3401A	Oil Filler complete with Cap	25	V3440A	Main Feed Oil Pipe complete with Equalising Valve, Tee Pieces, Nuts and Nipples
2	V3402	Cap for Oil Filler complete	26	V3441	Union in Crankcase for Main Feed
3	V3403	Clamp Plate for Oil Filler	—	V3442	Joint (Equalising Valve Body)
—	M271	Set Screw for Oil Filler	27	V3427	Washer for Main Feed Pipe Union
Dipstick			28	V3443	Union in Bell Housing for Main Feed (also forms Dowel for Bearing)
4	V3410A	Oil Level Dipstick	29	V3444	Control Plunger
Oil Cleaner			30	M2381	Spring for Plunger
—	V3413	Joint (Cleaner Case to Crankcase)	31	V3446	Plug
5	V3415A	Oil Cleaner Case (Studded) with Union	32	V451	Washer for Plug
6	V3416	Cap for Oil Cleaner	33	V3448A	Oil Pipe (Pump to Cleaner) with Nuts and Nipples
7	M2465	Joint for Cap	NEAR-SIDE OF ENGINE		
8	V3418	Oil Relief Valve Body	Oil Strainer		
9	M2467	Bronze Ball ($\frac{1}{8}$ in. dia.)	34	V3451	Bracket for Strainer
10	V3371	Spring for Relief Valve	—	E192	Screw for Bracket
11	M2469	Plug for Relief Valve	—	E29A—1	Oil Strainer complete
12	M2470	Socket for Cleaner Element	35	E30—2	Oil Strainer Body
13	V3423	Plate for Cleaner	36	E31—3	Cover for Oil Strainer
14	V3424	Oil Cleaner Element	37	E32	Washer for Cover
15	M2473	Spring for Element Location	38	E37A—2	Oil Strainer Gauze
16	V3426	Union for Oil Pump Pipe	39	E39	Spring for Strainer
17	V3427	Washer for Union	40	E83	Locking Plate for Union
18	M422	Union for Pressure Gauge Pipe	41	G305—1	Union for Strainer
19	V3429	Washer for Union	—	V3461A	Bolt, Nut and Washer (Strainer to Bracket)
—	V3430A	Oil Cleaner complete	—	M442	Screw for Locking Plate
Oil Pipes			Oil Pipes		
20	V5435A	Cylinder Head Oil Feed Pipe complete with Pipe to Chain Tensioner, Top Flange, Nuts and Nipples	42	V3465A	Oil Suction Pipe (Strainer to Crankcase) complete with Nut and Flange
21	G317	Joint for Feed Pipe Flange	43	V464	Joint for Oil Suction Pipe Flange (one inside Crankcase)
22	V437	Oil Feed Restrictor	—	V3467A	Oil Suction Pipe (inside Crankcase) with Flange
23	V5438A	Cylinder Head Oil Drain Pipe complete with Flanges	44	V3468A	Oil Suction Pipe (Strainer to Pump) complete with Nuts

Please state maker's CAR NUMBER and ENGINE NUMBER when ordering. See note on Page 3. Prices of Spare Parts are shown on separate list.

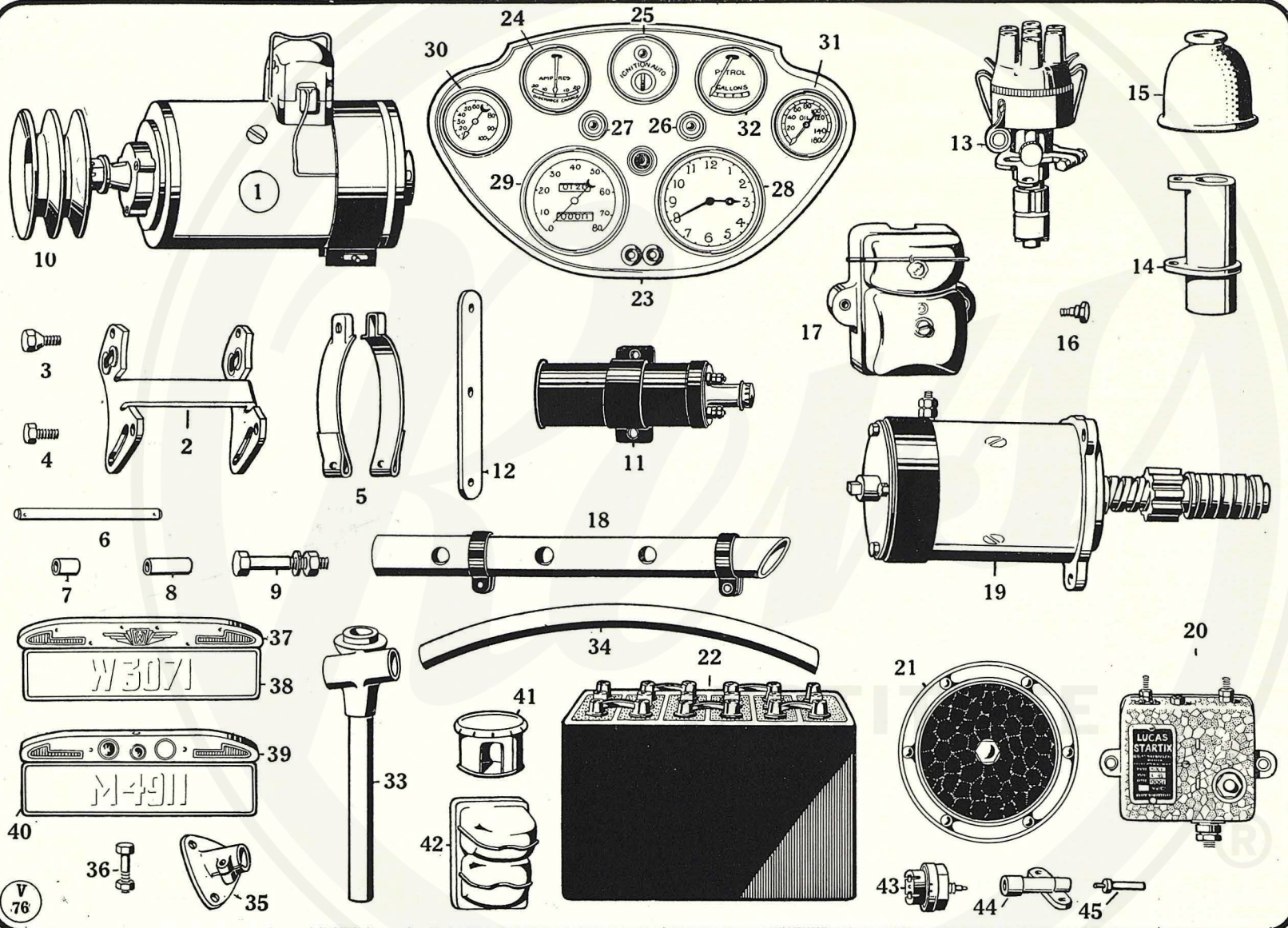

WOLSELEY 21/60 H.P. (SIX-CYLINDER) COUNTY MODEL

Electrical Equipment, also Instrument Board Fittings

No. of Illustration.	Service No. for ordering.	Description of Part.	No. of Illustration.	Service No. for ordering.	Description of Part.
Dynamo and Fittings					
1	V3501	Dynamo (Type C.45A), 12-volt	25	V3543—1	Combined Ignition and Starter Switch
2	V3502	Dynamo Cradle	26	V3544	Fog Lamp Switch
3	V3503	Set Screw for Cradle (Top)	27	V3545	Panel Light Switch
4	V3504	Set Screw for Cradle (Bottom)	28	V3546	Clock
5	V3505	Strap for Dynamo	29	V5547	Speedometer Head (Smith's "Nemag")
6	V3506A	Pin for Dynamo Straps with Washers and Split Pins	30	V3548	Thermometer complete with 6 ft. of Tube
7	V3507	Distance Piece for Strap Pin	31	V3549	Oil Pressure Indicator
8	V3508	Distance Piece for Strap Pin	32	V5550	Petrol Gauge
9	V3509A	Pinch Bolt, Nut and Washer for Straps	—	V3551	Flexible Drive for Speedometer 5 ft. long
10	V5510	Pulley on Dynamo	—	M2550	Bulb for Warning Light (3.5-volt, .15 amp.)
—	V5511	Dynamo Driving Belt	—	M554	Bulb for Panel Light (B.A.S.10S, 12-volt, 6-watt)
—	V5272	Fan Driving Belt			
		<i>Note :—For Dynamo Driving Pulley see Page 7.</i>			
		<i>For Fan Details see Page 9.</i>			
Distributor and Coil and Ignition Wires					
11	V3520	Ignition Coil (Model Q/12), 12-volt	—	V5561	Headlamp (Type P/100 D.B.) O/S or N/S
12	V3521	Bracket for Ignition Coil	—	V5562	Bulb for Headlamp Projector (12-volt, 48-watt)
13	V3522A	Distributor (D.J.6A) with Lever	—	V5563	Bulb for Headlamp Dipping Beam (12-volt, 48-watt Transverse Filament)
14	V3523	Adapter for Distributor	33	V5564A	Bracket for Headlamp (O/S)
—	V3007	Set Screw for Adapter	—	V5565A	Bracket for Headlamp (N/S)
15	V3524	Rubber Cap for Distributor	34	V5566	Headlamp Cross Tube
16	M503	Securing Screw for Distributor	35	V5567A	Wing Bracket for Headlamp Cross Tube (O/S)
—	V3527A	Set of Ignition Wires (High-tension)	—	V5568A	Wing Bracket for Headlamp Cross Tube (N/S)
17	V3528	Distribution Board and Cut-out	36	V5569	Pinching Screw for Wing Bracket
18	V3529	Ignition Wire Tube	—	V3569	Sidelamp with Ruby Glass
—	V3530	Cover for Sparking Plugs	—	M554	Bulb for Sidelamp (B.A.S.10S, 12-volt, 6-watt)
			—	V3572	Fog Lamp complete with Bracket
			—	M2563	Bulb for Fog Lamp (B.A.S.10S No. 4, 12-volt, 36-watt)
			37	V3573—1	Front Direction Indicator (Type D.F.21A) complete with Badge
			38	V3574	Front Number-plate
			39	V3575—1	Rear Direction Indicator (Type D.T.21A) including Stop, Tail and Reverse Lights
19	V5531	Starter (Type M.418 S.F.), 12-volt	—	M552	Bulb for Direction Indicators (B.A.S. No. 3, 12-volt, 24-watt)
20	V3532—1	"Startix" Unit (Model S.X.4), 12-volt	—	M554	Bulb for Tail or Stop Light (B.A.S.10S, 12-volt, 6-watt)
			—	M552	Bulb for Reverse Light (B.A.S. No. 3, 12-volt, 24-watt)
			40	V5576	Rear Number-plate
			41	V3581	Auxiliary Junction Box
			42	V3582—1	Relay for Indicators
			43	V3583	Switch for Reverse Light
21	V3535	Electric Horn (Type H.F.722), 12-volt	44	V5584	Bracket for Reverse Light Switch
22	M519—1	Battery (Type S.T.W.11A/12)	45	V5585	Plunger for Reverse Light Switch
			—	M4584	Medallion for Radiator
			—	M4585	Bulb for Medallion (6-watt, 12-volt, Festoon)
			—	M4583	Operating Switch for Indicators (Model S.D.W.12)
			—	M4586	Bulb for Indicator Warning Light (2.5-volt, 2-amp.)
			—	M4587	Auxiliary Fuse and Container
23	V3541—1	Instrument Panel complete with Ammeter, combined Ignition and Starter Switch, Red Warning Light, Fog Lamp Switch, Panel Lights and Switch, and Inspection Lamp Sockets	—	M4588	Auxiliary Fuse (25-amp.)
24	V3542	Ammeter	—	M4558	Fuse for Distribution Board and Cut-out
					<i>Note :—For Headlamp Control see Page 31.</i>

Please state maker's CAR NUMBER and ENGINE NUMBER when ordering. See note on Page 3. Prices of Spare Parts are shown on separate list.

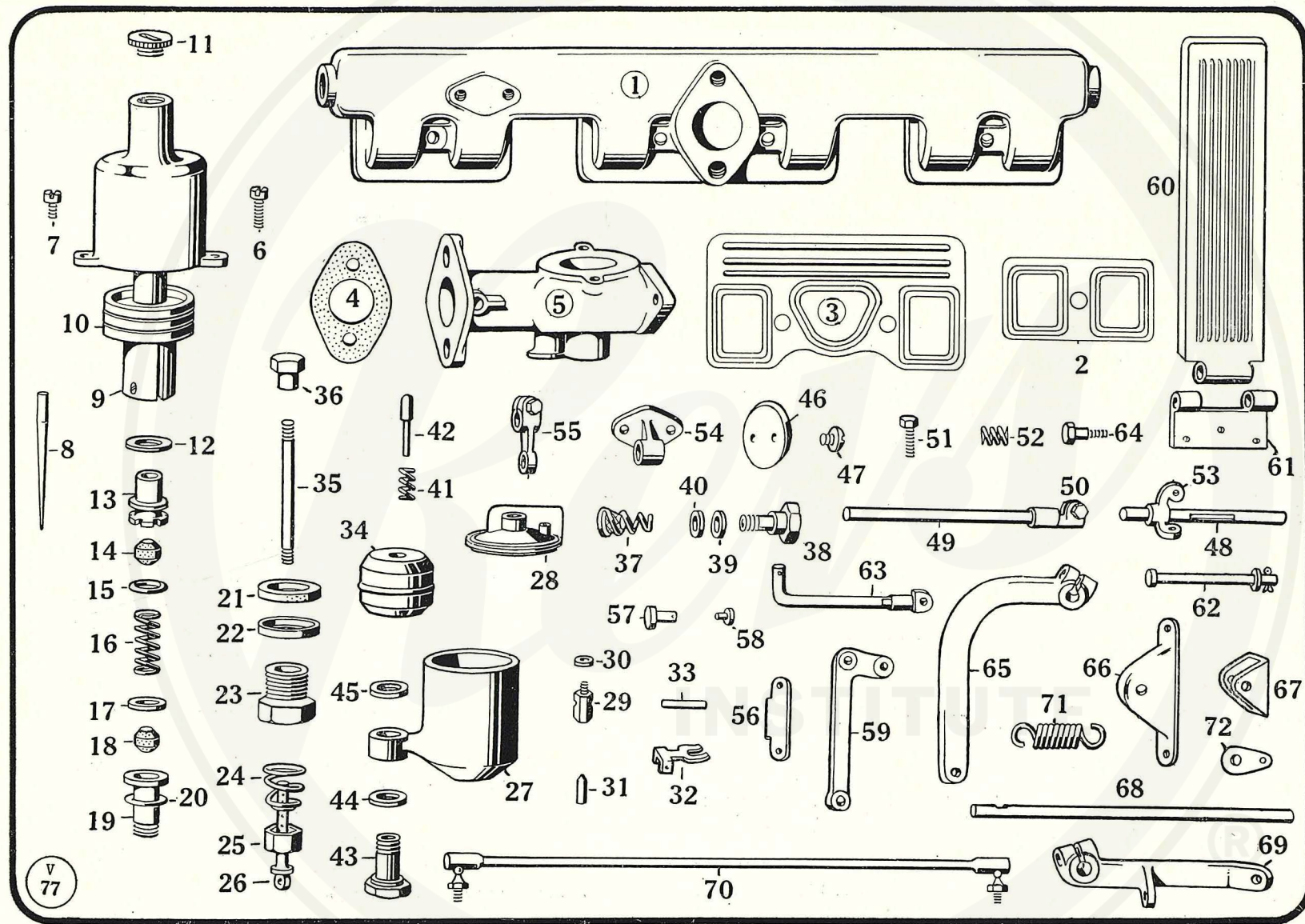

WOLSELEY 21/60 H.P. (SIX-CYLINDER) COUNTY MODEL

S.U. Carburetter (Adjustable Jet) and Accelerator Pedal

No. of Illus- tration.	Service No. for Ordering.	Description of Part.	No. of Illus- tration.	Service No. for Ordering.	Description of Part.
Inlet Branch and Joints					
1	V3601A	Inlet Branch	37	G472A	Strainer Gauze and Spring
2	V3602	Joint for Inlet Branch (Front or Rear Ports)	38	M4637	Banjo Pin for Float-chamber
3	V3603	Joint for Inlet Branch (Centre)	39	M4638	Washer for Banjo Pin (Outer)
4	M605	Joint for Carburetter Body	40	G474	Washer for Banjo Pin (Inner)
Carburetter					
—	V3605A	Carburetter complete	41	M4640	Spring for Float Tickler
5	V3606	Carburetter Body	42	M4641	Float Tickler
6	E394	Screw for securing Dashpot Cover (Long)	43	M639	Holding-up Bolt for Float-chamber
7	E426	Screw for securing Dashpot Cover (Short)	44	M640	Washer for Holding-up Bolt (Outer)
8	V3609	Carburetter Needle	45	H397	Washer for Holding-up Bolt (Inner)
9	G483	Screw for Needle	46	G510	Throttle Disc
10	V3611A	Dashpot Piston and Dashpot	47	E427	Screw for Throttle Disc
11	E398	Oil Cap	48	V3648	Throttle Spindle
12	E424	Copper Washer (Top of Jet)	49	V3649	Throttle Spindle Extension Rod
13	E399	Jet Bearing (Top Half)	50	G480A	Coupling for Extension Rod with Bolt and Nut
14	E400	Cork Gland Washer (Top)	51	V3650	Throttle Stop Screw
15	E401	Brass Gland Washer (Top)	52	M635	Spring for Throttle Stop Screw
16	E402	Bronze Gland Spring	53	G469	Throttle Stop Lever
17	E401	Brass Gland Washer (Bottom)	54	V3651	Throttle Shaft Bracket
18	E400	Cork Gland Washer (Bottom)	55	G470A	Throttle Control Lever
19	E403	Jet Bearing (Bottom Half)	56	M644	Connecting Link for Jet Operating Lever
20	E425	Copper Packing Washer for Bottom Bearing	57	V3653	Pin for Connecting Link (Long)
21	E404	Jet Sealing Washer (Cork)	58	E422	Pin for Connecting Link (Short)
22	E405	Jet Sealing Washer (Brass)	59	V3655	Jet Operating Lever
23	E406	Jet Screw	Accelerator Pedal		
24	E407	Jet Adjusting Spring	60	V3671A	Accelerator Pedal
25	E408	Jet Adjusting Nut	61	V3672	Hinge for Accelerator Pedal
26	E409	Jet	62	V3673A	Hinge Pin for Pedal with Washer
27	V3628	Float-chamber	63	V5674A	Control Rod (Pedal to Pedal Lever) with Eye Piece, Nut, Washer and Split Pin
28	V3629	Lid for Float-chamber	64	V3675A	Bolt for Eye Piece with Nut and Washer
29	V3630	Float Needle Seat	65	V5676A	Accelerator Pedal Lever with Pinch Bolt and Nut
30	V3631	Copper Washer for Needle Seat	66	V3677	Dash Bracket for Throttle Control (O/S)
31	V3632	Float Needle	67	V3678	Dash Bracket for Throttle Control (N/S)
32	V3633	Hinged Lever for Float	68	V3679	Throttle Control Shaft
33	V3634	Pin for Hinged Lever	69	V5680A	Throttle Shaft Operating Lever with Pinch Bolt and Nut
34	V3635	Float	70	V5681A	Throttle Connecting Link with Nuts
35	V3636	Fixing Stud for Float-chamber Lid	71	E784—1	Throttle Control Return Spring
36	M4635	Fixing Nut for Lid	72	V3683	Eye Piece for Return Spring

Note:—For Throttle and Jet Controls see Page 31.

Please state maker's CAR NUMBER and ENGINE NUMBER when ordering. See note on Page 3. Prices of Spare Parts are shown on separate list.

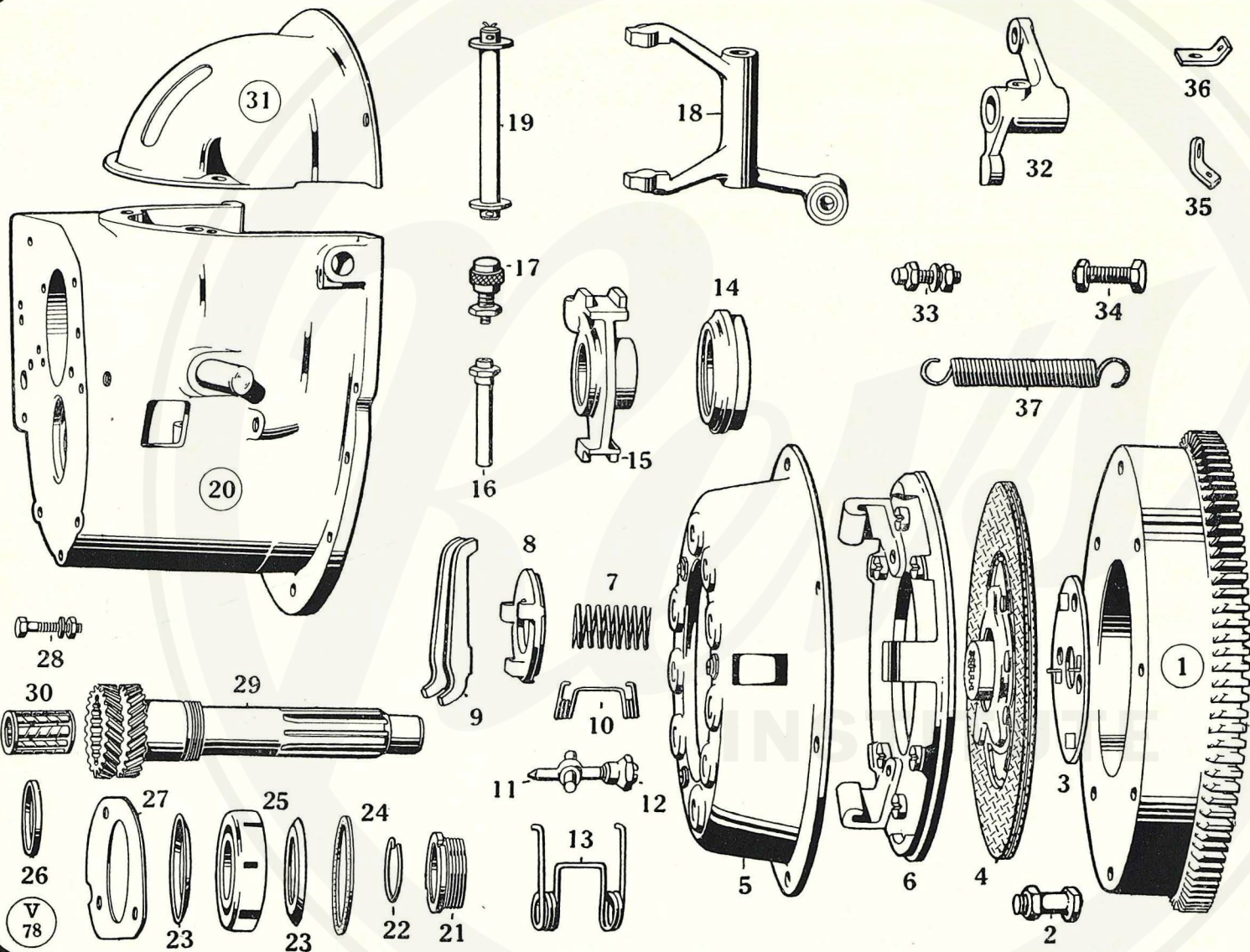

WOLSELEY 21/60 H.P. (SIX-CYLINDER) COUNTY MODEL

Flywheel, Clutch, Clutch Casing and Clutch Operating Lever

No. of Illus- tration.	Service No. for Ordering.	Description of Part.	No. of Illus- tration.	Service No. for Ordering.	Description of Part.
Flywheel and Clutch			Clutch Pit and First Motion Shaft		
1	V3701	Flywheel	—	V3721A	Clutch Pit complete with First Motion Shaft and Pedal Fulcrum Pin
2	G701A	Bolt and Nut for Flywheel			
3	G702	Lock Plate for Flywheel Bolts	20	V3722A	Clutch Pit with Pedal Fulcrum Pin
4	V3702A	Clutch Plate complete with Centre and two Fabrics	21	V3723	Bearing Adjusting Nut
—	V3703A	Clutch Cover complete with Springs, Finger Levers and Friction Plate	22	V3724	Spring Ring for Adjusting Nut
5	V3704	Clutch Cover	23	V3725	Oil Thrower for First Motion Shaft
6	V3705	Clutch Pressure Plate	24	V804	Bearing Packing Joint
7	V3706	Clutch Spring	—	V3735	Packing Washer for Bearing
8	V3707	Clutch Release Lever Plate	25	F656	Ball Bearing for First Motion Shaft
9	V3708	Clutch Release Lever (set of 3)*	26	V3728	Distance Piece for Ball Bearing
10	V3709	Release Lever Retaining Wire	27	V3729	Retaining Plate for Ball Bearing
11	V3710	Clutch Release Lever Pin and Eye Bolt (set of 3)*	28	V3730A	Bolt, Nut and Washer for Retaining Plate
12	V3711	Nut for Clutch Eye Bolt	29	V3731	First Motion Shaft
13	V3712	Clutch Anti-Rattle Spring	30	GD737	Spigot Bearing in First Motion Shaft
14	V3713	Clutch Thrust Race	31	V3733	Cover for Clutch Pit
15	V3714	Clutch Operating Sleeve	—	V3734	Set Screw for Cover
16	V3715A	Extension for Clutch Thrust Greaser			Clutch Operating Mechanism
17	SG2	Greaser for Clutch Thrust Bearing	32	V5745	Clutch Operating Lever
18	V3716	Clutch Operating Fork	33	V3746A	Clutch Stop Pin and Nut
19	V3717A	Pin for Clutch Operating Fork with Washers and Split Pins	34	V3747A	Adjusting Screw for Clutch Pedal with Nut
—	V3718A	Clutch Operating Sleeve complete with Thrust Bearing and Greaser	35	V3748	Spring Eye for Adjusting Screw
			36	V3749	Spring Anchor on Clutch Pit
			37	V3750	Return Spring for Clutch Pedal
			—	TG105	Greaser for Clutch Operating Lever
			—	TG116	Adaptor for Greaser
		<i>* Note :—Either of these parts are only supplied in sets (3 per set).</i>			<i>Note :—For Clutch Pedal and Link see Page 33.</i>

Please state maker's CAR NUMBER and CHASSIS NUMBER when ordering. See note on Page 3. Prices of Spare Parts are shown on separate list.

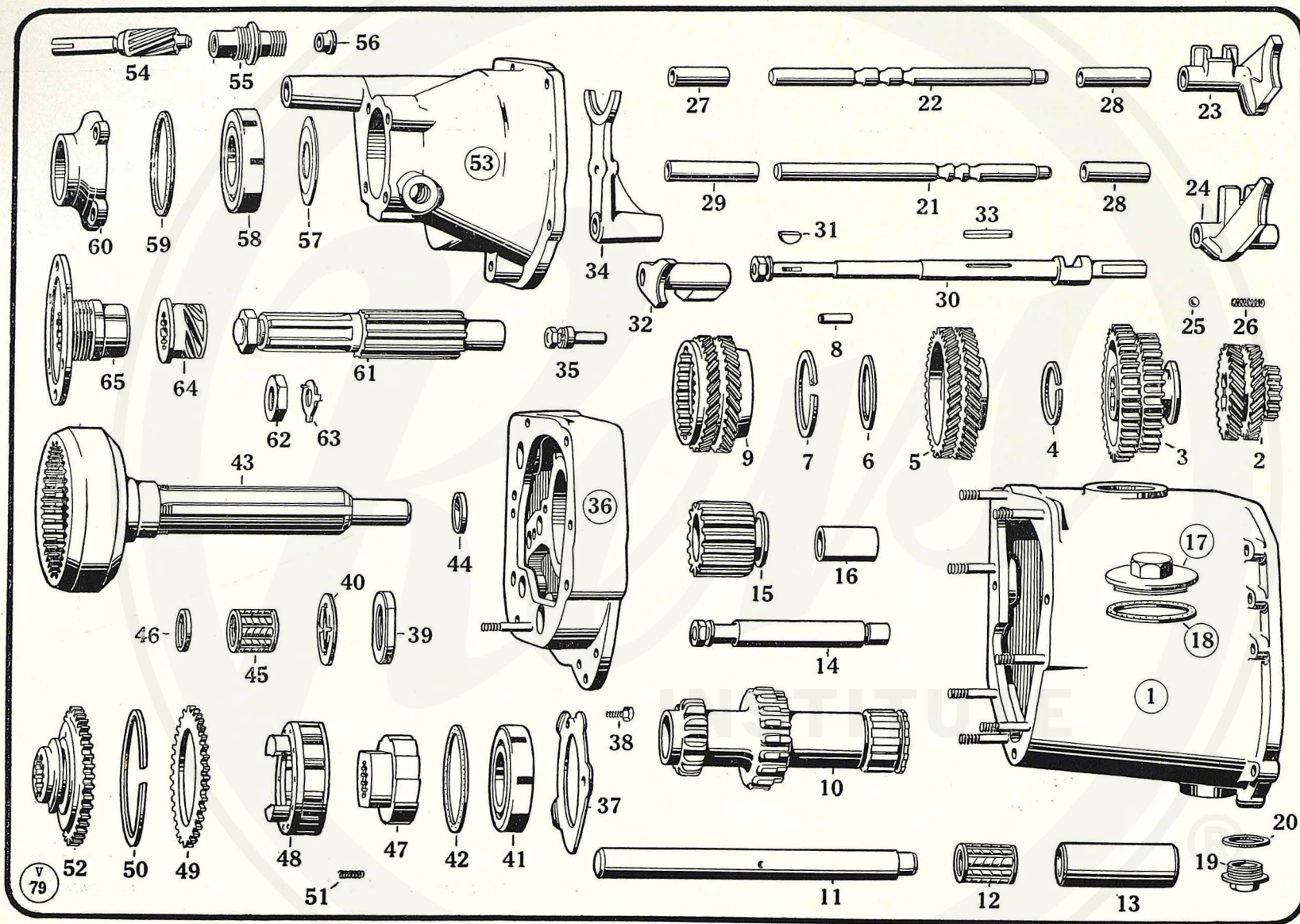

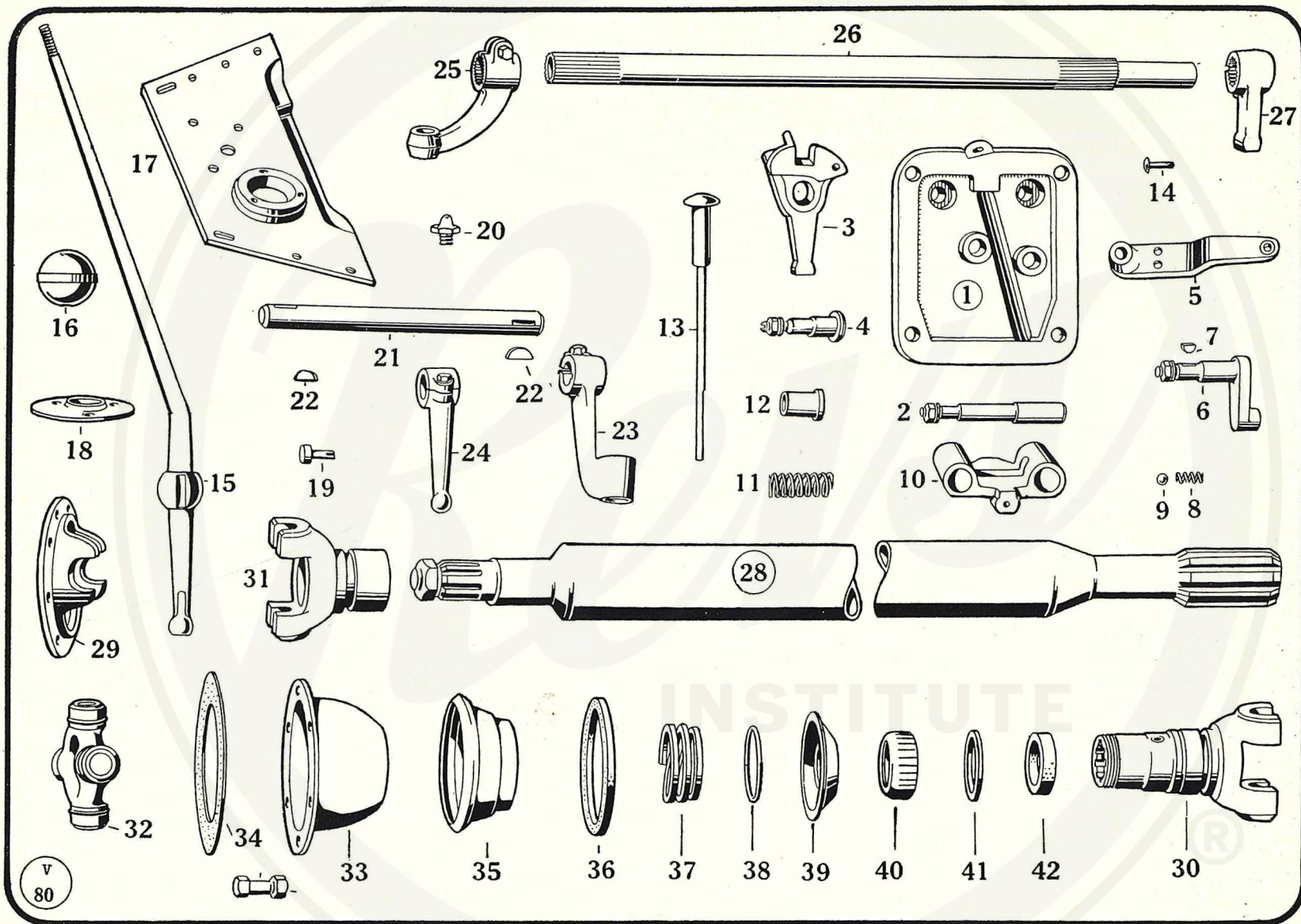

WOLSELEY 21/60 H.P. (SIX-CYLINDER) COUNTY MODEL

Change Speed and Free Wheel Operating Mechanism, also Propeller Shaft

No. of Illus- tration.	Service No. for Ordering.	Description of Part.	No. of Illus- tration.	Service No. for Ordering.	Description of Part.
		Gearcase Side Door with Levers and Change Speed Lock			
1	V3901	Side Door for Gearcase	—	V3931	Pinch Bolt for Levers on Cross Shaft
2	V3902A	Pin for Change Speed Lock with Nut and Washer	24	V3932A	Lever on Cross Shaft (N/S) with Pinch Bolt
3	V3903A	Reverse Operating Lever	25	V3933A	Lever on Operating Tube (Outer) with Pinch Bolt, Nut and Washer
4	V3904A	Pin for Reverse Operating Lever with Nut and Washer	—	V3934A	Pinch Bolt, Nut and Washer for Outer Lever on Tube
5	V3905	Control Lever for Free Wheel (Outer)	26	V5935A	Change Speed Operating Tube
6	V3906A	Control Lever for Free Wheel (Inner) with Nut, Washer and Key	27	V3936A	Finger Lever on Operating Tube (inside Gearcase) with Pinch Bolt
7	H189	Key for Free Wheel Control Lever (Outer)	—	M26	Pinch Bolt for Finger Lever
8	V3908	Plunger Spring for Outer Free Wheel Lever	—	V5938A	Change Speed Hand Lever assembled with Cross Shaft, Levers and Cover
9	M734	Plunger Ball for Outer Free Wheel Lever	—	V5939	Packing Piece for Support and Cover
10	V3910	Change Speed Lock			
11	V3911	Spring for Lock			Propeller Shaft and Universal Joint
12	V3912	Distance Piece for Lock	28	V5954A	Propeller Shaft with Splined Ends
—	V3913	Joint between Side Door and Gearcase	29	V5955	Universal Joint Flange Yoke (Front or Rear)
—	V3914A	Side Door assembled with Levers and Lock Pins (less Dipstick)	30	V5956	Universal Joint Sleeve Yoke (Front)
13	V3915A	Oil Level Dipstick	31	V5957	Universal Joint Ball Yoke (Rear)
14	V3916	Rivet for Reverse Operating Lever	32	V5958	Universal Joint Journal (Bushed) (Front or Rear)
		Change Speed Hand Lever and Rods	33	V5960	Inner Casing (Front or Rear)
15	V3921A	Change Speed Hand Lever with Knob	34	V5961	Gasket for Yoke and Inner Casing (Front or Rear)
16	M2724	Knob for Change Speed Hand Lever	35	V5962	Outer Casing (Front or Rear)
17	V5923A	Bracket for Change Speed complete with Cross Shaft and Bracket	36	V5963	Packing for Casing
18	V3925	Cover for Change Speed Lever Ball	37	V5964	Retaining Spring for Outer Casing (Front or Rear)
19	V3926	Locking Rivet for Ball	38	V3966	Baffle Spring (Front or Rear)
20	TG101	Greaser for Change Speed Cross Shaft	39	V5966	Baffle Cup (Front or Rear)
21	V3928	Change Speed Cross Shaft	40	V5967	Dust Cap for Splined Yoke (Front)
22	G227	Key for Cross Shaft	41	V5968	Steel Washer
23	V3930A	Lever on Cross Shaft (O/S) with Pinch Bolt	42	V5969	Felt Ring
			—	V5973A	Propeller Shaft complete
			43	TG108	Greaser for Propeller Shaft
			44	V5975A	Bolt, Nut and Washer for Universal Joints

Please state maker's CAR NUMBER and ENGINE NUMBER when ordering. See note on Page 3. Prices of Spare Parts are shown on separate list.

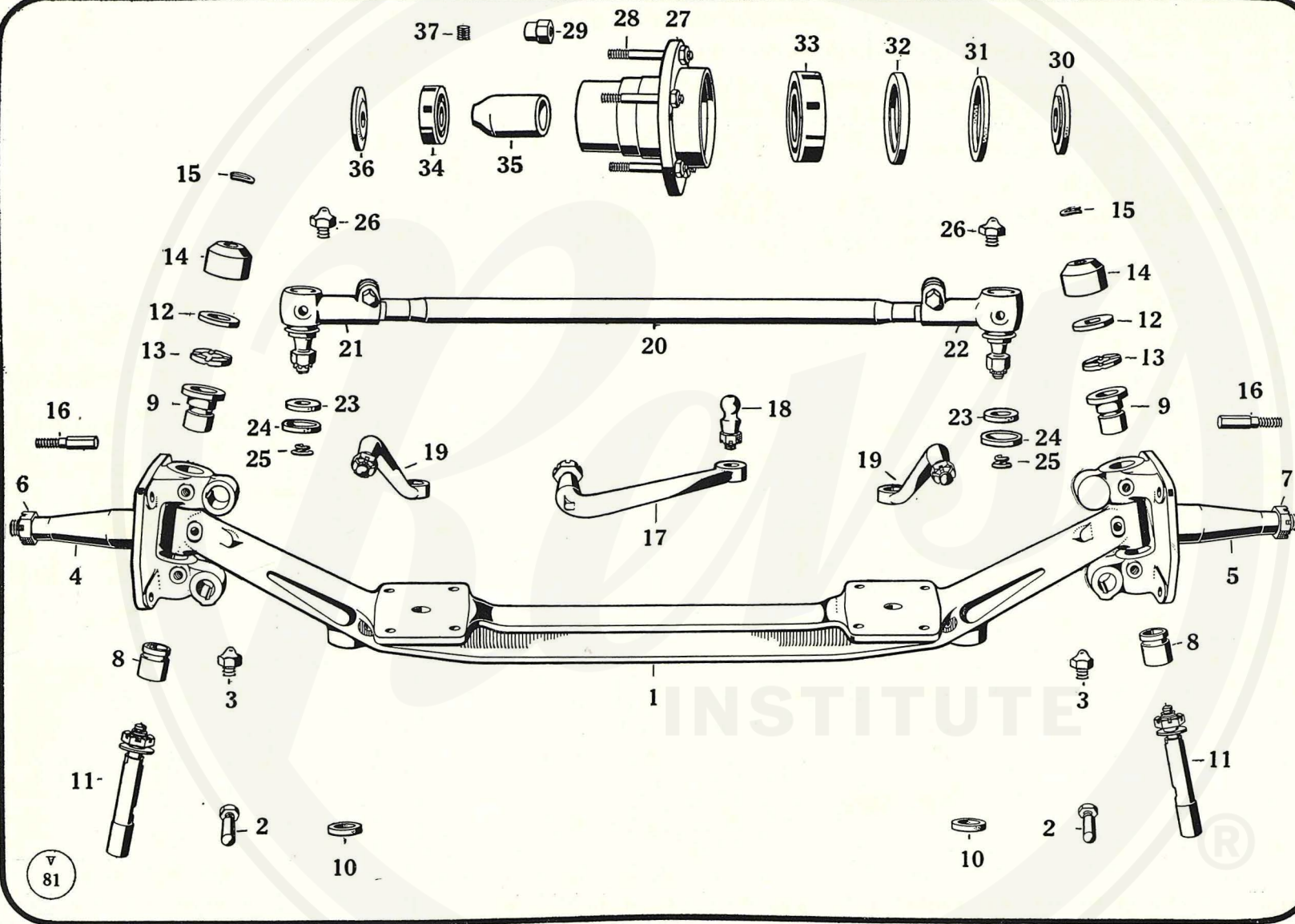

WOLSELEY 21/60 H.P. (SIX-CYLINDER) COUNTY MODEL

Front Axle, Front Hub and Steering Track Rod

No. of Illustration.	Service No. for Ordering.	Description of Part.	No. of Illustration.	Service No. for Ordering.	Description of Part.
Front Axle					
1	V6001	Front Axle Beam	20	V6022	Track Rod
2	E1503A	Cotter Pin and Nut for Swivel Pin	21	V4023A	End for Track Rod (R.H. Thread) complete with Ball Pin
3	TG101	Greaser for Swivel Bushes	22	V4024A	End for Track Rod (L.H. Thread) complete with Ball Pin
4	GD1005A	Swivel Axle (O/S) (Bushed) with Nut and Greasers	23	V4025	Felt Washer
5	GD1006A	Swivel Axle (N/S) (Bushed) with Nut and Greasers	24	V4026	Dust Cover for Felt Washer
6	DG1022	Nut for Swivel Arm (O/S)	25	V4027	Spring for Dust Cover
7	GD1023	Nut for Swivel Arm (N/S)	26	TG102	Greaser for Track Rod
8	GD1007	Bush for Swivel Axle (Bottom)	Front Hub		
9	V6008	Bush for Swivel Axle (Top)	27	V6034A	Front Hub (Studded)
10	G1042	Leather Washer for Swivel Pin	28	V6035A	Stud for Front Hub with Nut
11	V6009A	Swivel Pin, with Nut and Washer	29	V964	Nut for Road Wheel
12	V6010	Lock Washer for Swivel Pin	—	TG105	Greaser for Front Hub (loose in Tool Kit)
13	V6011	Thrust Washer for Swivel Pin	—	GD1036	Plug for Grease Hole in Front Hub
14	V6012	Cover for Swivel Pin	30	GD1015	Distance Washer for Swivel Arm
15	GD1013	Grip Piece for Cover	31	GD1016	Felt Washer for Swivel Arm
16	GD1014A	Steering Lock Stop with Nut	32	GD1017	Retainer for Felt Washer
17	V6015A	Steering Lever (O/S only) with Nut, Split Pin and Key	33	G735	Ball Bearing for Hub (Large)
18	V6016A	Ball Pin and Nut for Steering Lever	34	GD1019	Ball Bearing for Hub (Small)
19	V6017A	Steering Arm (O/S or N/S) with Nut, Split Pin and Key	35	GD1029	Distance Tube between Bearings
Steering Track Rod			36	GD1021	Bearing Retaining Washer
—	V6021A	Track Rod complete	<i>Note :—For Front Wheel Brake see Page 29. For Road Wheels see Page 27.</i>		

Please state maker's CAR NUMBER and CHASSIS NUMBER when ordering. See note on Page 3. Prices of Spare Parts are shown on separate list.

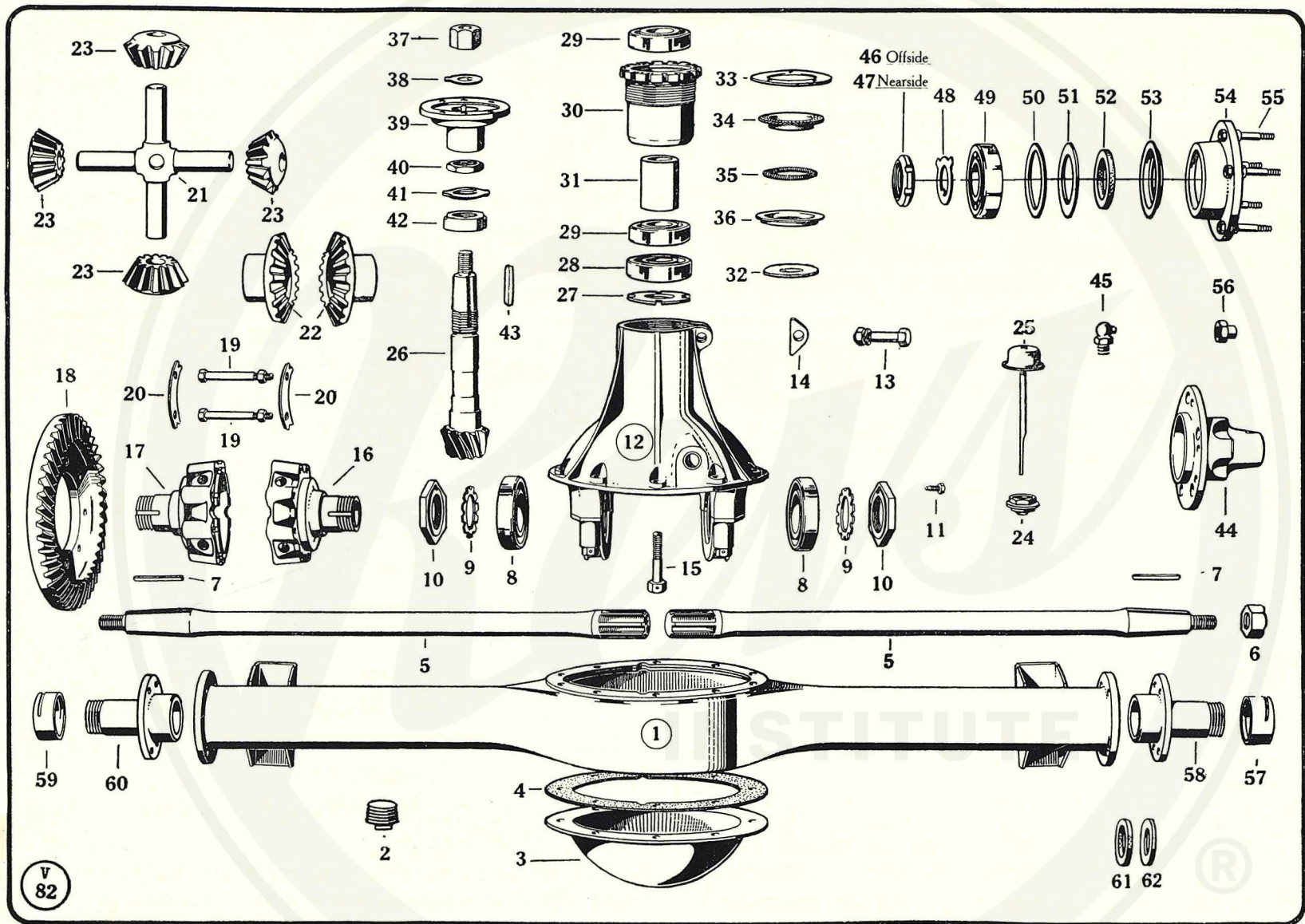

WOLSELEY 21/60 H.P. (SIX-CYLINDER) COUNTY MODEL

Rear Axle, Rear Hub and Road Wheels

No. of Illustration.	Service No. for Ordering.	Description of Part.	No. of Illustration.	Service No. for Ordering.	Description of Part.
		Rear Axle			
1	GD902A	Axle Banjo complete with Spring Seats	38	V6152	Washer for Bevel Pinion Nut
2	G809	Drain Plug for Axle Banjo	39	V6153	Universal Flange on Bevel Pinion
3	V6103	Rear Cover for Axle Banjo	40	G2840	Lock Nut for Adjusting Nut
4	G2807	Joint for Covers (Front or Rear)	41	G2839	Locking Washer for Pinion Adjusting Nut
		Differential Shaft	42	GD933	Pinion Adjusting Nut
5	G2810A	Differential Shaft with Nut and Washer	43	G843	Key on Bevel Pinion for Universal Spider
6	V911	Nut for Differential Shaft			Rear Hub
7	G811	Key for Differential Shaft	44	GD946A	Rear Hub with Greaser
		Front Cover, Differential Cage and Bearings	45	TG105	Greaser for Rear Hub
8	GD912	Ball Bearing for Differential Housing	46	GD948	Lock Nut for Wheel Bearing O/S
9	G2817	Adjusting Washer for Differential Cage Bearing	47	GD949	Lock Nut for Wheel Bearing N/S
10	G2816	Adjusting Nut for Differential Cage Bearing	48	GD950	Locking Plate for Lock Nut
11	G2818	Locking Screw for Adjusting Nut	49	GD951	Ball Bearing for Rear Hub
12	V6119A	Front Cover complete with Differential Bearing Caps (less Dipstick)	50	GD998	Spacing Washer for Ball Bearing
13	GD919A	Pinch Bolt, Nut and Washer for Front Cover	—	GD999	Packing Shim for Ball Bearing
14	GD920	Locking Piece for Pinch Bolt	51	GD953	Oil Retaining Plate
15	G2823	Bolt for Differential Bearing Cap	52	GD954	Cork Washer for Oil Retainer
16	GD923	Differential Cage (O/S)	53	GD955	Oil Retainer Cup
17	GD924	Differential Cage (N/S)	54	V6162A	Housing for Wheel Bearing assembled with Wheel Studs
18	GD925	Crown Wheel (11/53 ratio)	55	V6164A	Wheel Stud with Nut
19	GD926A	Bolt and Nut (Crown Wheel to Differential Cage)	56	V964	Nut for Road Wheel
20	GD927	Lock Washer for Crown Wheel Bolts	57	V6166	Distance Piece for Wheel Bearing (O/S)
21	G2833	Differential Star Piece	58	V6167	Distance Piece for Wheel Bearing (N/S)
22	G2831	Differential Wheel	59	GD961	Support for Wheel Bearing (O/S)
23	G2823	Differential Pinion	60	GD962	Support for Wheel Bearing (N/S)
24	V6129	Filler Plug	61	V6170	Oil Retaining Washer
25	V6130A	Oil Level Dipstick with Knob and Spring	62	V4177	Oil Retaining Plate
		Bevel Pinion and Bearings			Road Wheels
26	GD932A	Bevel Pinion (11 teeth) with Nut and Washer	—	V6175	Road Wheel
27	GD942	Washer for Bevel Pinion	—	V6176	Hub Cap
28	GD940	Pinion Roller Bearing			Sub-Assemblies
29	V6143	Pinion Ball Bearing	—	V6185A	Front Cover complete with Crown Wheel, Pinion and Differential Gears and Universal Joint Flange
30	V6144	Housing for Pinion Bearings	—	V6186A	Front Cover complete with Pinion and Bearings and Universal Flange (less Crown Wheel and Differential Gears)
31	GD941	Distance Piece for Pinion Bearings			
32	V932	Shim for Distance Piece	—	GD921A	Differential Cage with Crown Wheel and Differential Gears
33	GD935	Cover-plate for Oil Retainer	—	GD922A	Differential Cage with Crown Wheel (less Differential Gears)
34	GD936	Oil Retaining Felt Ring			
35	GD937	Endless Spring for Oil Retainer			
36	GD938	Retainer for Endless Spring			
37	V6151	Nut for Bevel Pinion			

Please state maker's CAR NUMBER and CHASSIS NUMBER when ordering. See note on Page 3. Prices of Spare Parts are shown on separate list.

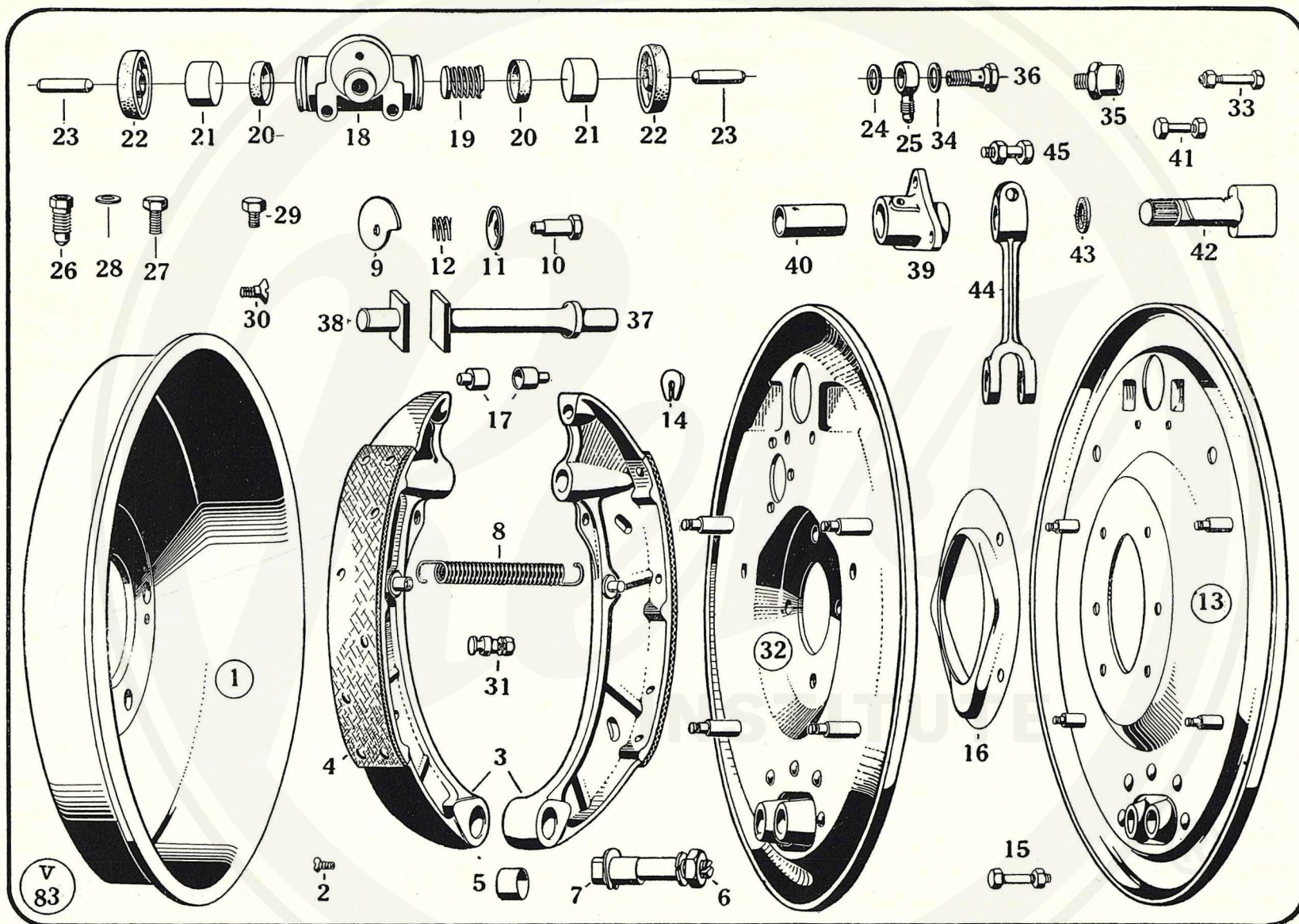

WOLSELEY 21/60 H.P. (SIX-CYLINDER) COUNTY MODEL

Brakes (Front and Rear)

No. of Illustration.	Service No. for ordering.	Description of Part.	No. of Illustration.	Service No. for ordering.	Description of Part.
Front Wheel Brake					
1	GD963	Brake-drum	7	GD969	Grip Piece for Fulcrum Pin
2	G2878	Screw for Brake-drum	8	V4209	Pull-off Spring for Brake-shoes
3	GD965A	Brake-shoe complete with Lining (pair)	31	GD1072A	Pin for Pull-off Spring with Nut and Washer
4	GD966—2	Lining for Brake-shoe	9	GD971	Adjusting Cam for Brake-shoes
5	GD967	Bush for Brake-shoe	10	GD972	Pin for Cam
6	GD968A	Fulcrum Pin for Brake-shoe with Nut, Washer and Grip Piece	11	GD973	Washer for Cam Pin
7	GD969	Grip Piece for Fulcrum Pin	12	GD974	Spring on Cam Pin
8	GD970	Pull-off Spring for Brake-shoe	32	GD975A—1	Bracket for Brake-shoes O/S (forming Dust Cover for Drum, complete with Fulcrum Pin Bracket, Adjusting Cams and Brake-shoe Steady Pins)
9	GD971	Adjusting Cam for Brake-shoe	—	GD975A—2	Bracket for Brake-shoes N/S (forming Dust Cover for Drum complete with Fulcrum Pin Bracket, Adjusting Cams and Brake-shoe Steady Pins)
10	GD972	Pin for Cam	14	GD976	Grip Piece for Steady Pins
11	GD973	Washer for Cam Pin	33	GD977A	Bolt, Nut and Washer for Brake Bracket to Axle Tube
12	GD974	Spring on Cam Pin	16	GD978	Socket in Brake-shoe for Push Rod
13	GD1046A	Bracket for Brake-shoes (forming Dust Cover for Drum, complete with Fulcrum Pin Bracket, Adjusting Cams and Brake-shoe Steady Pins)	—	GD979A	Wheel Cylinder assembled complete
14	GD976	Grip Piece for Steady Pin	17	GD980	Wheel Cylinder
15	V6215A	Bolt, Nut and Split Pin (Bracket to Swivels)	18	GD981A	Spring with Retainer
16	GD1048	Oil Drain for Front Hub	19	GD982	Cup for Wheel Cylinder
17	GD978	Socket in Brake-shoe for Push Rod	20	GD983	Piston for Wheel Cylinder
—	GD1049A	Wheel Cylinder assembled complete	21	GD984	Boot for Wheel Cylinder
18	GD980	Wheel Cylinder	22	GD985	Push Rod
19	GD981A	Spring with Retainer	23	GD986	Washer for Inlet Connection
20	GD982	Cup for Wheel Cylinder	25	GD990	Bleeder Screw
21	GD983	Piston for Wheel Cylinder	26	GD991	Set Screw for Bleeder Screw
22	GD984	Boot for Wheel Cylinder	27	GD992	Spring Washer for Set Screw
23	GD985	Push Rod	28	GD993	Screw for attaching Wheel Cylinder to Brake Bracket
24	GD986	Washer for Inlet Connection	37	GD1061	Thrust Piece for Hand Brake Cam (Long)
25	GD1057	Inlet Connection	38	GD1062	Thrust Piece for Hand Brake Cam (Short)
26	GD990	Bleeder Screw	39	GD1063A	Bracket for Hand Brake Cam (O/S) (Bushed)
27	GD991	Set Screw for Bleeder Screw	—	GD1064A	Bracket for Hand Brake Cam (N/S) (Bushed)
28	GD992	Spring Washer for Set Screw	40	GD1065	Bush for Cam Bracket
29	GD993	Screw for Attaching Wheel Cylinder to Brake Bracket	41	GD1073A	Bolt, Nut and Split Pin for Brake Cam Bracket
<i>Note :—For Foot Brake Control see Page 33.</i>			<i>Note :—For Greaser Details see Page 37.</i>		
<i>For Hand Brake Control see Page 33.</i>					
Rear Wheel Brakes (Hand and Foot)					
1	GD963	Brake-drum	42	GD1067	Hand Brake Cam
30	GD964	Screw for Brake-drum	43	GD1068	Felt Washer for Cam
3	GD965A—1	Brake-shoe complete with Lining (pair)	44	V1112A	Hand Brake Operating Lever (O/S or N/S) with Pinch Bolt
4	GD966—3	Lining for Brake-shoe	45	V1113A	Pinch Bolt, Nut and Washer for Lever
5	GD967	Bush for Brake-shoe			
6	GD968A	Fulcrum Pin for Brake-shoe with Nut, Washer and Grip Piece			

Please state maker's CAR NUMBER and CHASSIS NUMBER when ordering. See note on Page 3. Prices of Spare Parts are shown on separate list.

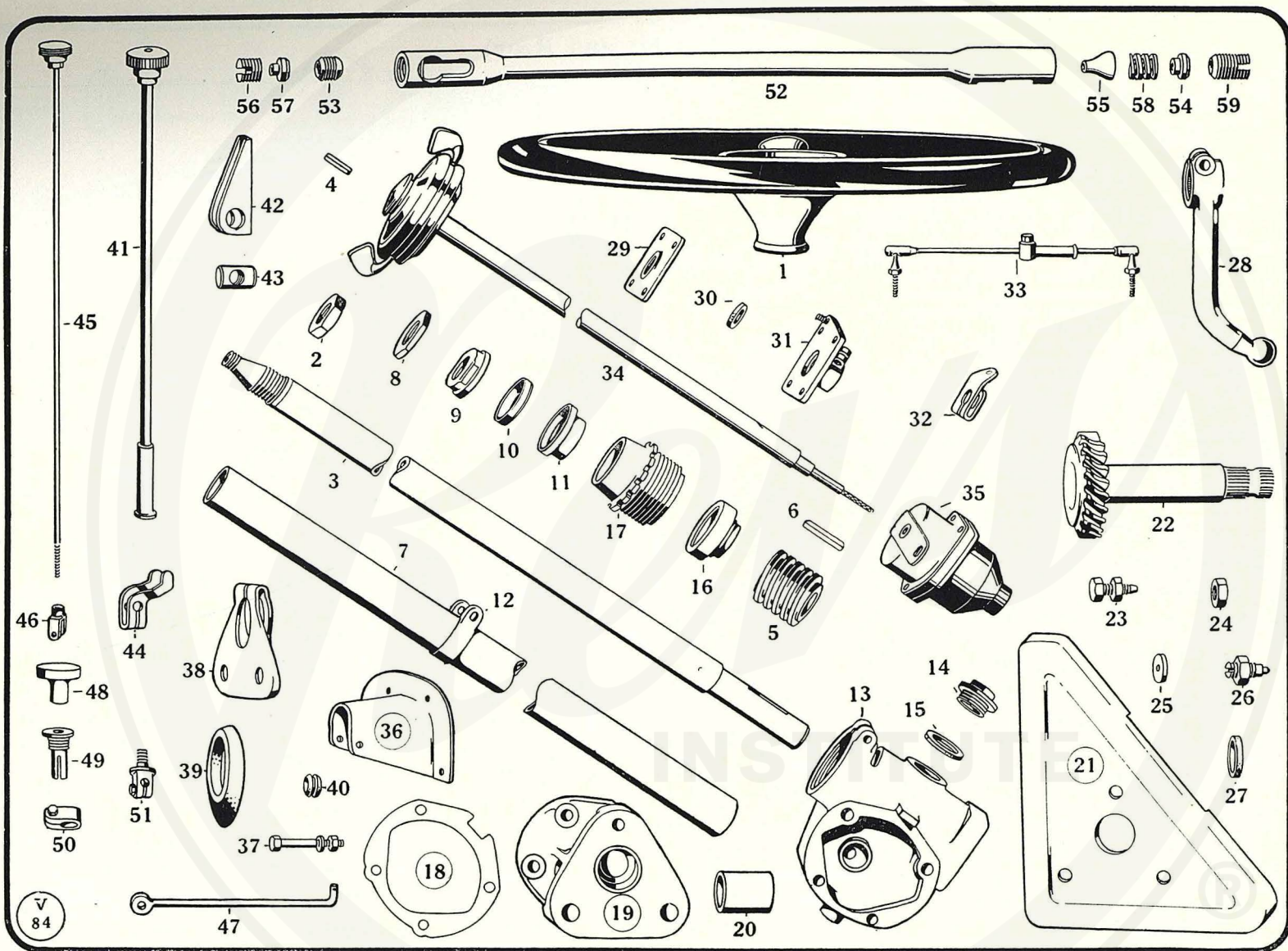

WOLSELEY 21/60 H.P. (SIX-CYLINDER) COUNTY MODEL

Control—Steering and Ignition

No. of Illustration.	Service No. for Ordering.	Description of Part.	No. of Illustration.	Service No. for Ordering.	Description of Part.
1	V4301	Steering Wheel			Ignition, Lamp and Horn Control
2	V4302	Retaining Nut for Steering Wheel	34	V6345	Steering Column Control complete (Lucas Model AA3)
3	V6303A	Steering Column Tube complete with Top End Piece	35	V4346	Switchbox complete (Lucas Model S.L.C.2)
4	M2853	Key for Steering Wheel			Steering Column Support Details
5	V4305	Steering Worm			Support Bracket for Steering Column
6	V4306	Key for Steering Worm	36	V6351A	Bolt, Nut and Washer (Column to Bracket)
7	V6307	Cover Tube for Steering Column	37	V4352A	
8	V4308	Lock Nut for Steering Ball Race			Controls on Steering Column
9	V4309	Upper Ball Race for Steering Column			Bracket on Steering Column for Throttle and Free
—	V4310	$\frac{3}{16}$ in. dia. Steel Balls (24 per Set)	38	V4361A	Wheel Controls
10	V4311	Lower Ball Race for Steering Column	—	V4362A	Bolt, Nut and Washer for Bracket
11	V4312	Housing for Lower Ball Race	39	V4363	Rubber Seal for Column
12	V1261	Link for Cover Tube	40	V4364	Bearing for Slow-running Tube
13	V4314A	Steering Box (Studded) with Bearings	41	V6365A	Slow-running Control complete with Knob, Nut and Adjusting Collar
14	M709	Filler Plug for Steering Box	42	V4366	Bracket for Slow-running Trunnion
15	M710	Washer for Filler Plug	43	V4367	Trunnion for Slow-running Control
—	V2215A	Pinch Bolt, Nut and Washer in Box for Bearing	44	V4368	Stop for Slow-running Control
16	V4318	Roller Bearing for Steering Worm [Adjustment]	45	V6369A	Jet Control Rod, Knob and Lock Nut
17	V2217	Adjusting Nut for Steering Worm Bearing	46	V4370A	Jaw End for Jet Control Rod with Pin
18	V2218	Shim for Steering Box	47	V6371A	Connecting Link for Jet Control
19	V4321A	Steering Box Bracket (Bushed)	48	V4372	Knob for Free Wheel Control
20	V2222	Bush for Steering Box Bracket	49	V4373A	Bearing for Free Wheel Control with Nut
21	V6323	Steering Box Frame Bracket	50	V4374A	Pinching Collar for Free Wheel Control with Bolt and Washer
—	V4324A	Bolt, Nut and Washer (Box Bracket to Frame Bracket)	—	V6375A	Free Wheel Flexible Control Rod (less Knob) with Jaw End
22	V4325	Steering Worm Wheel	51	V4376A	Eye Piece on Clutch Pit
—	V4326	Cup for Spring for Steering Box Bracket			Steering Draglink
—	V4327	Spring for Steering Box Bracket	52	V6381	Draglink Tube
23	V2227A	Adjusting Screw and Nut for Worm Wheel	53	V4382	Ball Cup for Draglink Tube
24	V2228	Lock Nut for Adjusting Screw	54	V4383	Spring Plunger
25	V2229	Thrust Washer for Steering Worm Wheel	55	V4384	Plunger Spring Seat
26	V2230A	Screw for Thrust Washer with Lock Nut	56	V4385	End Plug
27	V2231	Felt Washer for Worm Wheel	57	V4386	Spring Plunger
28	V6331A	Steering Drop Arm with Pinch Bolt, Nut, Washer and Split Pin	58	V4387	Ball Cup Spring
—	V2234A	Pinch Bolt, Nut, Washer and Split Pin for Drop Arm	59	V4388	End Cup
29	V4333	Retainer for Bottom Felt Washer	—	TG103	Greaser for Steering Draglink
30	V4334	Felt Washer	—	V6390A	Steering Draglink complete
31	V4335A	Bottom Cover for Steering Box with Stud, Pinch Bolt, Nut and Washer			
—	V4336A	Pinch Bolt, Nut and Washer for Bottom Cover			
32	V6337A	Ignition Control Lever with Pinching Screw			
33	V6338A	Ignition Control Rod complete			

Please state maker's CAR NUMBER and CHASSIS NUMBER when ordering. See note on Page 3. Prices of Spare Parts are shown on separate list.

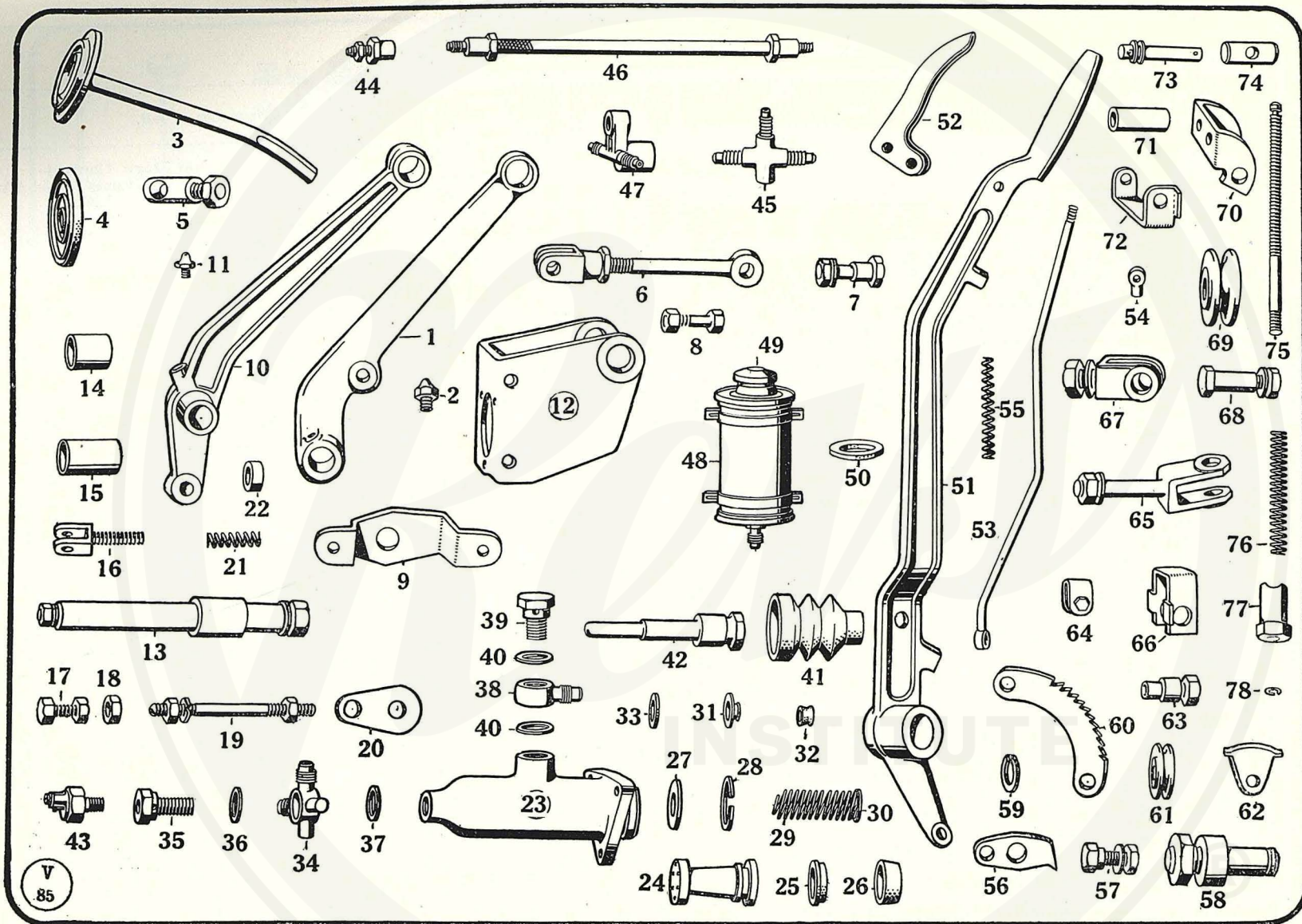

WOLSELEY 21/60 H.P. (SIX-CYLINDER) COUNTY MODEL

Brake Control (Hand and Foot Brakes) also Clutch Pedal

No. of Illustration.	Service No. for ordering.	Description of Part.	No. of Illustration.	Service No. for ordering.	Description of Part.
Clutch Pedal					
1	V6401	Clutch Pedal	—	V6445A	Pipe from Master Cylinder to Three-way (O/S)
2	TG101	Greaser for Pedal	—	V6446A	Pipe from Three-way Piece to O/S Front Wheel
3	V3743A	Adjusting Rod for Clutch Pedal with Pad	—	V6447A	Pipe from Three-way Piece to N/S Front Wheel
4	V3744	Rubber Pad for Pedal Top	—	V6448A	Pipe from Master Cylinder to Rear Hose
5	F734A	Locking Pin for Adjustable Rod with Nut and Washer	—	V6449A	Pipe from Rear Hose Bracket to O/S Rear Wheel
6	V6406A	Connecting Link for Clutch Pedal with Jaw Joint	—	V6450A	Pipe from Rear Hose Bracket to N/S Rear Wheel
7	V6407A	Pin, Nut and Washer (Link to Clutch Operating Lever)	44	GD1237A	Hose Connection with Nut and Washer
8	V6408A	Pin and Nut (Link to Clutch Pedal)	45	V6452	Three-way Piece (Front)
9	V6409	Bracket for Clutch Pedal	46	GD1239	Flexible Hose complete (Front or Rear)
		<i>Note :- For Clutch Operating Mechanism see Page 19.</i>	47	GD1244	Hose Bracket (Rear)
Brake Pedal					
10	V4401	Brake Pedal	—	GD1247	Clip for Pipe to Rear Axle
11	TG105	Greaser for Pedal	48	V1361A	Lockheed Supply Tank
12	V4402A	Adjustable Rod for Pedal with Pad	49	M1372A	Supply Tank complete with Fixing Brackets
13	F734A	Locking Pin for Adjustable Rod with Nut and Washer	50	M1373	Cap for Supply Tank complete with Baffles
14	V3744	Rubber Pad for Pedal	—	V6464A	Rubber Washer for Filler Cap
15	V4405	Bracket for Pedal and Lockheed Master Cylinder			Supply Pipe from Tank to Master Cylinder
16	V6415A	Pin for Brake and Clutch with Nuts and Washers	HAND BRAKE CONTROL		
17	M3306	Distance Piece for Brake Pedal Pin (Short)	Hand Brake Lever		
18	V4408	Distance Piece for Pedal Pin (Long)	51	V4471	Hand Brake Lever
19	V4409A	Eye Piece for Master Cylinder with Bolt, Nut and Lock Nut	52	V4472	Grip Lever
20	V1310A	Bolt and Nut for Eye Piece	53	V4473A	Pawl Rod with Eye Piece
21	V1311	Lock Nut for Eye Piece	54	M755	Eye Piece for Pawl Rod (Top)
22	M1209A	Stud for Master Cylinder and Brake Stop with Nuts and Washer	55	M756	Spring for Pawl Rod
23	V4413	Brake Stop Piece	56	V4476	Brake Pawl
24	M1311	Push-off Spring for Brake Pedal	57	V4477A	Bolt for Brake Pawl and Hand Brake Lever with Nut and Washer
25	V4415	Distance Piece for Master Cylinder	58	V4478A	Fulcrum Pin, Nuts and Washers
Lockheed Master Cylinder					
26	V4421	Master Cylinder	59	V1381	Spring Ring
27	V1322	Piston for Master Cylinder	60	V4480	Brake Quadrant
28	V1323	Secondary Cup for Master Cylinder	61	V4481A	Bolt, Nut and Washer for Quadrant
29	V1324	Cup for Master Cylinder	62	V4482	Cable Pulley on Hand Brake Lever
30	V4424	Piston Stop	63	V4483	Sheath for Cable Pulley on Lever
31	V4425	Retainer for Stop	64	V4484A	Spindle for Cable Pulley on Lever with Nut and Washer
32	V4426	Return Spring for Master Cylinder with Retainer	65	V4485	Cable for Hand Brake
33	V4427	Retainer for Return Spring	66	V4486A	Clip for Cable with Bolt and Nut
34	V4428	Valve Body	67	V6487A	Frame Bracket for Guide Pulley with Nut and Washer
35	V4429	Valve Cup	68	V6488	Retaining Plate for Cable
36	V4430	Valve Washer	69	V4489A	Bracket for Guide Pulley on Cross Member with Nut and Washer
37	V4431	Outlet Connection	70	V4490A	Pin for Pulley with Nut and Washers
38	V4432	Bolt for Outlet Connection	71	V4491	Guide Pulley
39	GD986	Gasket for Outlet Connection Banjo	72	V6492	Intermediate Frame Bracket for Guide Roller
40	V4433	Gasket for Outlet Connection	73	V6493	Guide Roller for Hand Brake Cable
41	V4434	Banjo Connection (Inlet)	74	V6494	Retaining Plate for Cable
42	V4435	Banjo Connection Fixing Bolt	75	V4494A	Pin for Guide Roller with Washers and Split Pin
43	V4436	Gasket for Inlet	76	G1216	Pin in Axle Operating Lever
44	V1337	Boot for Master Cylinder	77	G1213	Adjusting Screw for Brake Cable
45	V4437	Push Rod assembled with Cap	78	G1215	Spring for Adjusting Screw
46	V4438	Signal Lamp Switch		G1214	Adjusting Nut for Brake Cable
47	V4439A	Master Cylinder complete		G1217	Lock Ring for Adjusting Screw

Please state maker's CAR NUMBER and CHASSIS NUMBER when ordering. See note on Page 3. Prices of Spare Parts are shown on separate list.

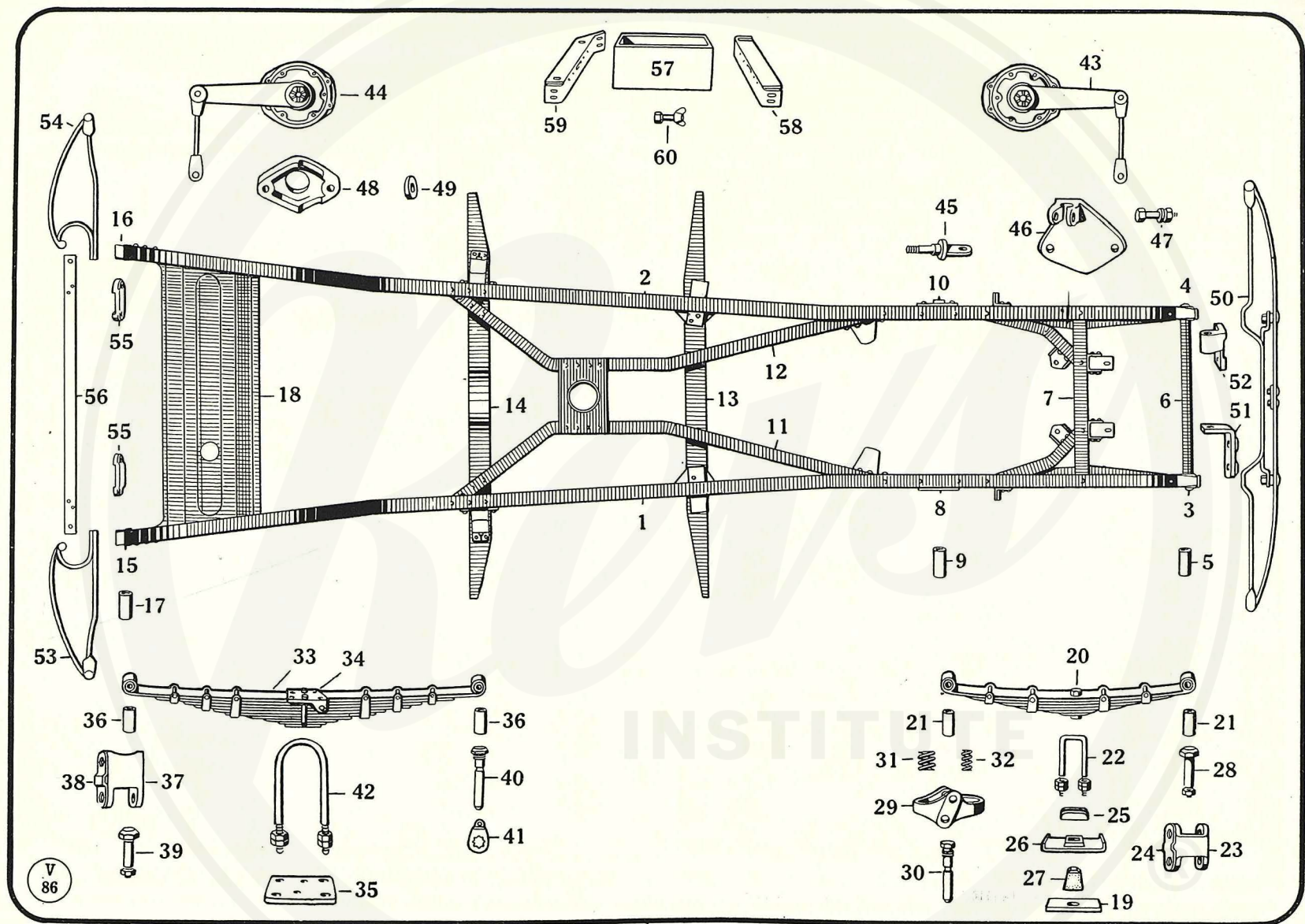

WOLSELEY 21/60 H.P. (SIX-CYLINDER) COUNTY MODEL

Frame Fittings and Spring Suspension

No. of Illustration.	Service No. for ordering.	Description of Part.	No. of Illustration.	Service No. for ordering.	Description of Part.
Frame					
1	V6501	Frame Side Member (O/S) (Drilled)	36	V4551	Bush for Spring Eye (Rear)
2	V6502	Frame Side Member (N/S) (Drilled)	37	V4552A	Rear Spring Shackle with Locking Plate
3	V6503A	Front Dumb-iron (O/S) (Bushed)	38	V4553	Locking Plate for Rear Spring Shackle
4	V6504A	Front Dumb-iron (N/S) (Bushed)	39	V4554A	Pin for Rear Spring Shackle with Nut and Split Pin
5	V6518	Bush for Front Dumb-iron	40	V6555A	Pin for Rear Spring Front Eye
6	V6505A	Front Cross Tube	41	V6556	Locking Plate for Rear Spring Front Eye Pin
7	V6506A	Front Cross Member with Radiator Support Brackets	42	V4557A	Clip for Rear Road Spring with Nuts
8	V6507A	Front Spring Rear Bracket (O/S) (Bushed)	—	V4560	Wick for Rear Dumb-iron
9	V6508	Bush for Front Spring Rear Bracket (O/S)			<i>Note :—Separate Spring Plates can be supplied to order. For Spring Greasers and Fittings see Page 37.</i>
10	V6509	Front Spring Rear Bracket (N/S)			
11	V6510	Intermediate Frame Member (O/S) (Drilled)			
12	V6511	Intermediate Frame Member (N/S) (Drilled)			
13	V6512	Front Main Cross Member and Running-board Support			
14	V6513	Rear Main Cross Member and Running-board Support	43	V6565	Front Shock Absorber (O/S)
15	V6514A	Rear Dumb-iron (O/S) (Bushed)	—	V6566	Front Shock Absorber (N/S)
16	V6515A	Rear Dumb-iron (N/S) (Bushed)	—	V6567	Rear Shock Absorber (O/S)
17	V4518	Bush for Rear Dumb-iron	44	V6568	Rear Shock Absorber (N/S)
18	V6517	Rear Cross Member	45	V6569	Bracket for Front Shock Absorber
			46	V6570A	Combined Headlamp and Shock Absorber Bracket (O/S)
			—	V6571A	Combined Headlamp and Shock Absorber Bracket (N/S)
			47	V6572A	Pinch Bolt with Nut and Washer
			48	V6573	Packing Piece for Rear Shock Absorber
			49	V6574	Taper Washer for Rear Shock Absorber
Road Springs and Suspension					
19	V6524	Packing for Front Axle Pad	50	V6575	Front Bumper
20	V6525A	Front Road Spring (O/S) (Bushed)	51	V4576	Clamp for Front Bumper (O/S)
—	V6526A	Front Road Spring (N/S) (Bushed)	52	V4577	Clamp for Front Bumper (N/S)
21	V4551	Bush for Front Spring Eye	53	V6578	Rear Bumper (O/S)
22	V6528A	Front Spring Clip with Nuts	54	V6579	Rear Bumper (N/S)
23	V6529	Front Spring Shackle (O/S or N/S)	55	V4582	Bracket Securing Rear Bumper
24	V6530	Locking Piece for Front Spring Shackle	56	V6580	Tie Bar for Rear Bumpers
25	V6531	Packing Piece for Front Spring Clip	—	V6581	Rear Bumper (Coupe)
26	V6532	Buffer Block Container			
27	GD1313	Buffer Block			
28	V4554A	Pin for Front Spring Shackle or Front Spring Rear (N/S) with Nut and Split Pin			
29	V6538A	Link for Front Spring Rear Support Bracket (O/S)	57	V4585A	Battery Carrier complete
30	V6540A	Link Pin (Front Spring Rear Support O/S)	58	V6586	Support for Battery Carrier (Front)
31	V6543	Damper Spring (Outer)	59	V6587	Support for Battery Carrier (Rear)
32	V6544	Damper Spring (Inner)	60	V4588A	Battery Securing Bolt with Wing Nut
—	V6545A	Rear Road Spring (O/S) (Bushed)			
33	V6546A	Rear Road Spring (N/S) (Bushed)			
—	V6547	Shock Absorber Bracket on Road Spring (O/S)			
34	V6548	Shock Absorber Bracket on Road Spring (N/S)			
35	V6549	Bottom Plate for Rear Road Spring	—	V6595A	Frame complete
—	V4550	Screw for Rear Road Spring	—	V6596A	Front Cross Tube assembled with Dumb-irons

Shock Absorbers and Fittings

Bumpers and Fittings

Battery Carrier and Details

Sub-Assemblies

Please state maker's CAR NUMBER and CHASSIS NUMBER when ordering. See note on Page 3. Prices of Spare Parts are shown on separate list.

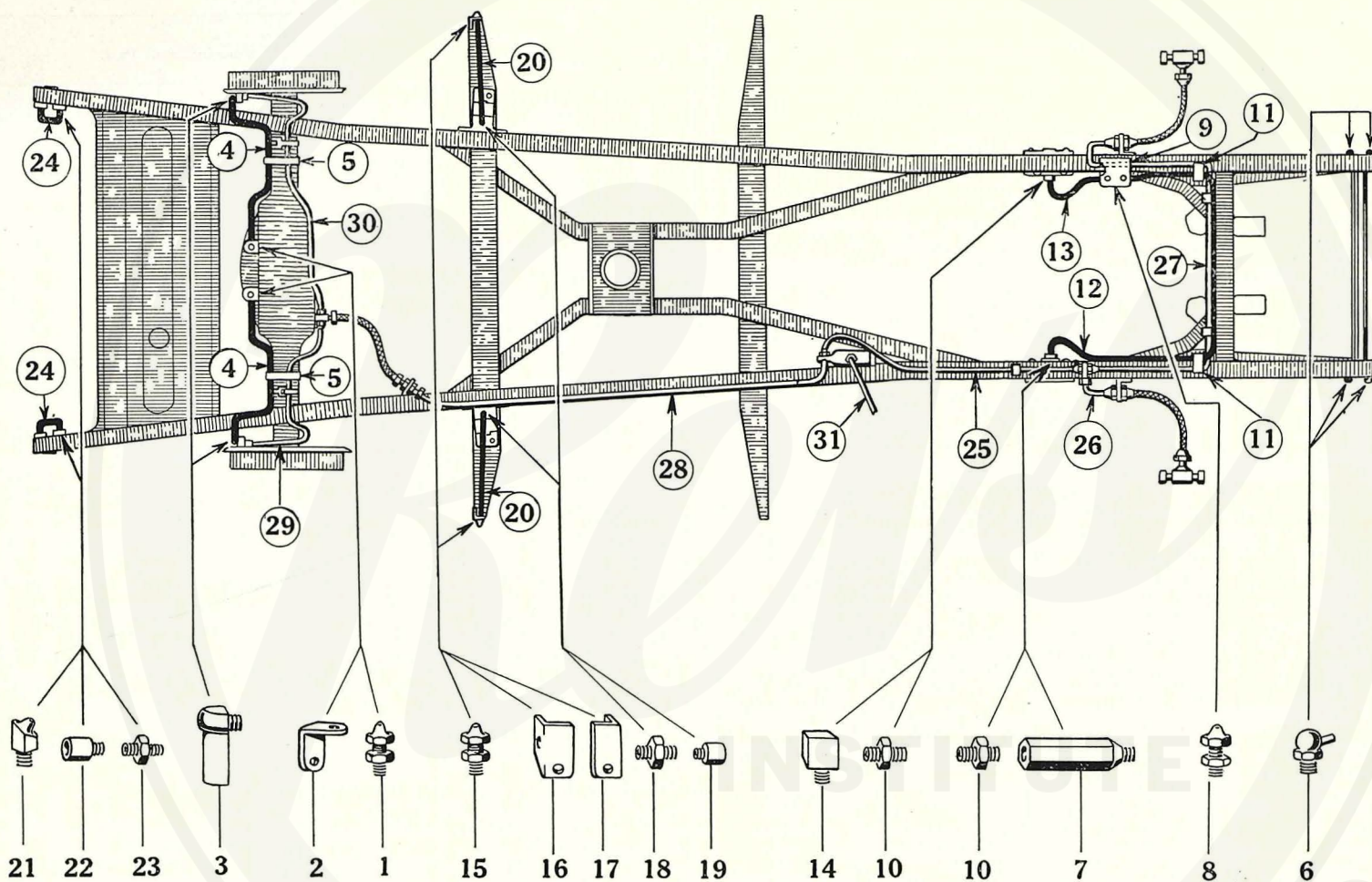

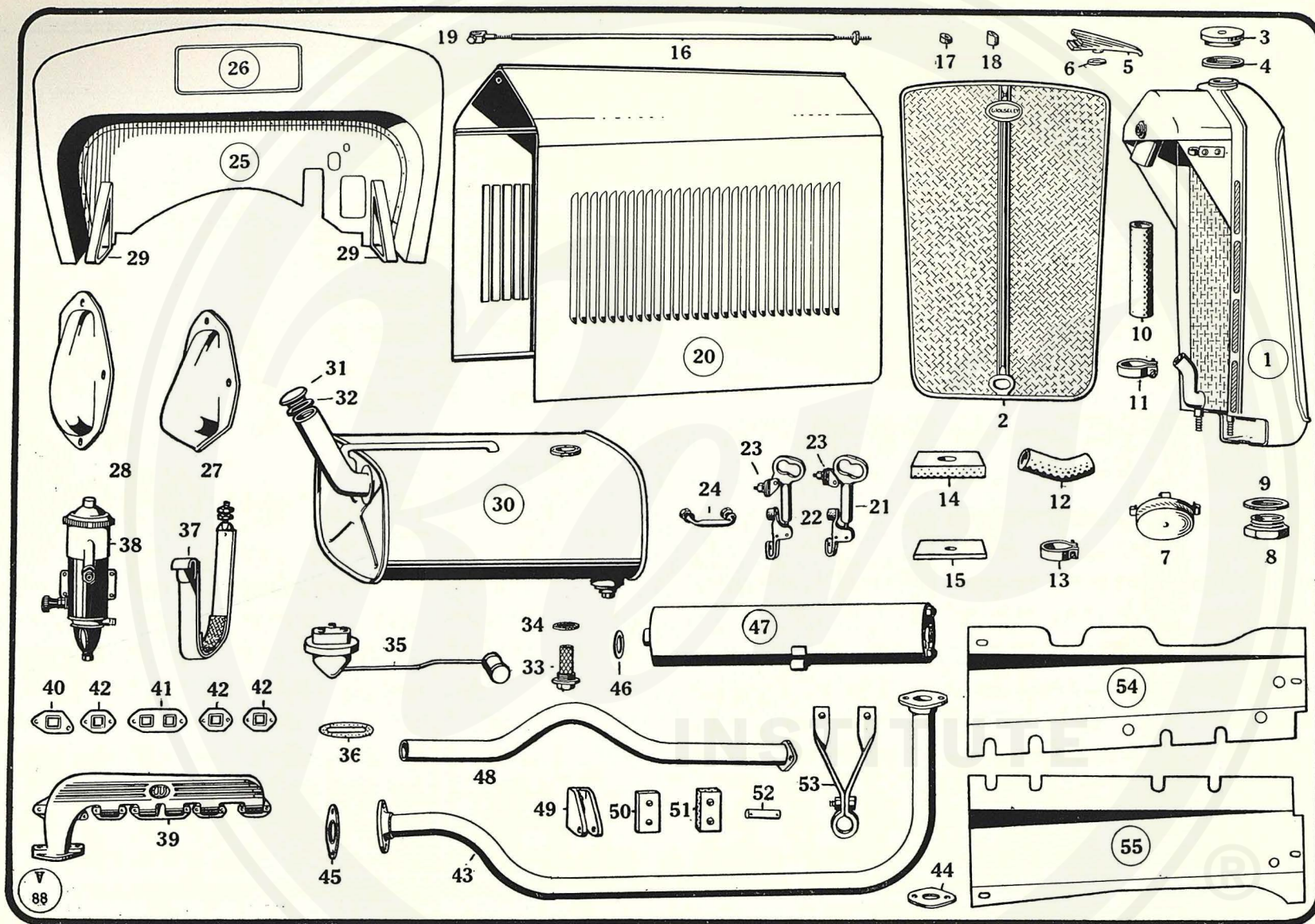

WOLSELEY 21/60 H.P. (SIX-CYLINDER) COUNTY MODEL

Radiator, Bonnet, Exhaust Pipes, Petrol Tank, etc.

No. of Illustration.	Service No. for ordering.	Description of Part.	No. of Illustration.	Service No. for ordering.	Description of Part.
Radiator and Details					
1	V6601A	Radiator complete with Stone Guard	—	V4652A	Petrol Tank Filler
2	V4602	Shell for Radiator	—	V4653	Joint (Filler to Tank)
3	V6603	Stone Guard for Radiator	—	V4654	Filler Cap for Petrol Tank } Coupé
4	V4604	Filler Cap for Radiator	33	V4655	Joint for Filler Cap
5	V4605	Rubber Washer for Filler Cap	34	G1463A	Cap for Petrol Tank Sump with Strainer Gauze
6	V4606	Crest for Radiator Filler Cap	35	GD1461	Washer for Sump Cap
7	V4607	Rubber Washer for Crest	—	V6656	Petrol Gauge (Tank Unit)
8	V4608	Guard for Starting Handle Hole	—	V4657	Cable for Petrol Gauge
9	V6608	Drain Plug for Radiator	36	V4658	Joint for Petrol Gauge
10	V6609	Washer for Drain Plug	37	V6659A	Strap for Petrol Tank
11	V6610	Rubber Hose (Top)	—	V4660	Rear Packing Piece (Rubber) between Tank and Frame
12	G1408	Smith's Thermostat complete	38	V4662	Petrolift complete
13	V6612	Clip for Top Rubber Hose	—	V6663A	Petrol Pipe (Main Feed to Tank) complete
14	M1509	Rubber Hose (Bottom)	—	V6664A	Petrol Pipe (Main Feed to Petrolift) complete
15	V4614	Clip for Bottom Rubber Hose	—	V6665A	Petrol Pipe (Petrolift to Carburetter) complete
16	V4615	Rubber Packing for Radiator Support	Silencer and Exhaust Pipes		
17	V6616A	Packing Washer for Radiator	39	V4675	Exhaust Branch
18	V4617	Radiator Tie Rod complete	40	V4676	Joint for Exhaust Branch (Front)
19	V4618	Washer for Tie Rod	41	V4677	Joint for Exhaust Branch (Centre)
	V4619	Distance Piece for Tie Rod	42	V4678	Joint for Exhaust Branch (Intermediate or Rear)
		Bolt for Jaw Joint	43	V6679A	Exhaust Pipe (Engine to Silencer) with Flanges
		<i>Note :—For Radiator Medallion see Page 15.</i>	44	H1211	Joint (Exhaust Pipe to Manifold)
Bonnet and Bonnet Catches			45	G1452	Joint (Exhaust Pipe to Silencer) (Front)
20	V6625A	Bonnet complete	46	G1454	Joint (Exhaust Pipe to Silencer) (Rear)
21	V6627	Front Bonnet Catch with Fixing Bracket	47	V4680A	Silencer complete
22	V6628	Rear Bonnet Catch with Fixing Bracket	48	V6681A	Exhaust Tail Pipe with Flange (Saloon)
23	V4629	Bonnet Catch Yoke with Nut (Front or Rear)	—	V6682A	Exhaust Tail Pipe (Front Half) with Flange (Coupé)
24	GD1418A—1	Bonnet Handle with Nuts and Washers	—	V6682A—1	Exhaust Tail Pipe (Rear Half) (Coupé)
Dashboard and Fixing Brackets			—	V6688A	Clip for Exhaust Tail Pipes with Pinch Bolt, Nut and Washer (Coupé)
25	V6641A	Dashboard and Shroud complete	49	V6683	Silencer Support Bracket on Frame
26	V6642A	Trap Door for Back Dashboard	50	V4684	Plate for Silencer Support Bracket
27	V4643	Cover for Clutch Pedal	51	V4685	Rubber Packing for Support Plate
28	V4644	Cover for Brake Pedal	52	G1457A	Pin for Silencer Support Bracket
29	V4645	Support Bracket for Dashboard and Toe Boards	53	V6686A	Rear Exhaust Pipe Support Bracket with Pinch Bolt and Nut (Saloon)
Petrol Tank and Petrol Pipes			—	V6687A	Rear Exhaust Pipe Support Bracket with Pinch Bolt and Nut (Coupé)
30	V6651A	Petrol Tank complete (Saloon)	54	V6691	Undershield (O/S)
31	V6651A—1	Petrol Tank complete (Coupé)	55	V6692	Undershield (N/S)
32	H1222—1	Filler Cap for Petrol Tank } Saloon	—	V4693	Support Bracket for Undershield
	M3549	Joint for Filler Cap	—	GD1447	Clip for Undershield

Please state maker's CAR NUMBER and CHASSIS NUMBER when ordering. See note on Page 3. Prices of Spare Parts are shown on separate list.

WOLSELEY 21/60 H.P. (SIX-CYLINDER) COUNTY MODEL

Wings and Stepboards, and Carriage Fittings

Service No. for Ordering.	Description of Part.	Service No. for Ordering.	Description of Part.
Front Wings and Stays			
V6701A	Front Wing (O/S) } Saloon	V6741	Packing Piece for Steady Pin
V6702A	Front Wing (N/S) } Saloon	V6742	Taper Rubber Washer for Steady Pin or Wing
V6701A—1	Front Wing (O/S) } Coupé	V6743	Taper Steel Washer for Wing
V6702A—1	Front Wing (N/S) } Coupé	V6744	Disc for Spare Wheel Bracket
V6703	Front Wing Make-up Piece (O/S)	V6745	Clamp Plate for Spare Wheel
V6704	Front Wing Make-up Piece (N/S)	V6746A	Stud for Spare Wheel with Nut and Washer
V6705A	Front Wing Front Stay (O/S)	V964	Cap Nut for Spare Wheel
V6706A	Front Wing Front Stay (N/S)	V6748	Spare Wheel Cover (Saloon or Coupé)
<i>Note :—For Headlamp Support see Page 15.</i>		Luggage Grille and Brackets (Saloon only)	
V6707	Front Wing Rear Stay (O/S)	V6751	Bracket for Luggage Grille (O/S)
V6708	Front Wing Rear Stay (N/S)	V6752	Bracket for Luggage Grille (N/S)
V6715	Bonnet Ledge (O/S)	V6753A	Bracket for Luggage Grille (Beaded)
V6716	Bonnet Ledge (N/S)	V6754A	Luggage Grille complete with Links
V6717	Bonnet Valance (O/S)	V6755A	Bolt, Nut and Washer (Link to Bracket)
V6718	Bonnet Valance (N/S)	V6756A	Bolt, Nut and Washer (Link to Side Support)
V6719	Front Apron	V6757A	Locking Pin for Grille with Nut and Washer
Rear Wings		V6758A	Spring Clip for Grille
V6721	Rear Wing (O/S) } Saloon	Carriage Fittings	
V6722	Rear Wing (N/S) } Saloon	V4761	Screen complete
V6721—1	Rear Wing (O/S) } Coupé	V4762	Glass for Front Screen
V6722—1	Rear Wing (N/S) } Coupé	V4763	Screen Wiper complete with Dual Arms
V6723	Rear Apron (Saloon only)	V4764	Front Door Glass } Saloon
Stepboards		V4765	Rear Door Glass } Saloon
V6731A	Stepboard (O/S) complete with Covering and Edging	V4764—1	Front Door Glass } Coupé
V6732A	Stepboard (N/S) complete with Covering and Edging	V4765—1	Rear Door Glass } Coupé
Spare Wheel Carriers (Saloons only)		V6766	Hinged Quarter Light (O/S) } Saloons
V6735A	Spare Wheel Steady Tube complete with Brackets	V6767	Hinged Quarter Light (N/S) }
V6736	Rubber Packing for Tyre Pad	V6768	Glass for Quarter Light }
V6737	Rubber Ferrule for Tyre Pad	V6769	Front Door Louvre (O/S) }
V6738	Screw for Ferrule and Packing	V6770	Front Door Louvre (N/S) }
V6739A	Spare Wheel Steady Pin with Nuts and Washers	V6771	Rear Door Louvre (O/S) }
V6740	Lug for Spare Wheel Steady Pin	V6772	Rear Door Louvre (N/S) }
		V4767	Back-light Glass (Saloon or Coupé)

Please state maker's CAR NUMBER when ordering. See note on Page 3. Prices of Spare Parts are shown on separate list.

WOLSELEY 21/60 H.P. (SIX-CYLINDER) COUNTY MODEL

Tools, etc.

Service No. for Ordering.	Description of Part.
M3727	Double-ended Spanner ($\frac{3}{16}" \times \frac{1}{4}"$)
M3728	Double-ended Spanner ($\frac{5}{16}" \times \frac{3}{8}"$)
M3729	Double-ended Spanner ($\frac{7}{16}" \times \frac{1}{2}"$)
M3724	Box Spanner ($\frac{3}{16}" \times \frac{1}{4}"$)
V4807	Box Spanner ($\frac{5}{16}" \times \frac{3}{8}"$)
V4808	Box Spanner ($\frac{7}{16}" \times \frac{1}{2}"$)
V4809	Box Spanner ($\frac{3}{8}" \times \frac{9}{16}"$)
M3730	Tappet Spanner
M3731	Feeler Gauge with .003" Feeler in Cage
M3723	Adjustable Spanner
V4815	Sparking Plug Spanner
V4817	Tommy Bar
M3739	Tommy Bar
G1666	Adaptor for Oil Drain Plug
E1254—1	Wheel Brace
E1269	Tyre Pump
V4802	Lifting Jack
V4803	Handle for Lifting Jack
G1665	Cross Bar for Handle
V1913	Tyre Levers (Pair)
V6822A	Starting Handle
M5714	Grease Gun
GD1603	Bleeder Wrench
GD1604	Drain for Bleeder Screw
GD1605	Drain Tube

} for Lockheed Brake

Please state maker's CAR NUMBER when ordering. See note on Page 3. Prices of Spare Parts are shown on separate list.