

The
WOLSELEY

21/60 H.P. SIX-CYLINDER CAR
“COUNTY” MODEL
(with Automatic Clutch Control)

SPARE PART LIST No. 983

WOLSELEY MOTORS (1927) LTD.
BIRMINGHAM, 8

WOLSELEY MOTORS (1927) LIMITED

Governing Director . . . LORD NUFFIELD

.....

The

WOLSELEY

21/60 H.P. SIX-CYLINDER CAR

"COUNTY" MODEL

(with Automatic Clutch Control)

SPARE PART LIST No. 983

Head Office and Works - - DREWS LANE, WARD END, BIRMINGHAM, 8

Telegrams : "EXACTITUDE, TELEX, BIRMINGHAM" *Telephone* : BIRMINGHAM EAST 1501 *Telex Telephone* : EAST TELEX 0404

London Repair Works - - - - EUSTACE WATKINS LTD., MANOR STREET, CHELSEA, S.W.

Telegrams & Telephone : FLAXMAN 8181 (10 lines)

CONTENTS

	Page		Page
AXLES AND WHEELS		ELECTRICAL EQUIPMENT	
Front Axle	25	Battery	15, 35
Front Hub	25	Dynamo	15
Rear Axle	27	Distributor	15
Rear Hub	27	Electric Horn	15, 31
Road Wheels	27	Instrument Panel	15
BUMPERS AND FITTINGS	35	Lamps	15, 31
BRAKES		Starter	15
Front Wheel Brake	29	Indicators	15
Rear Wheel Brake	29	FREE WHEEL	21, 23, 31
BONNET	39	FRAME AND FITTINGS	35
CARRIAGE FITTINGS	40	FOOT CONTROL	
CLUTCH	19	Accelerator	17
DASHBOARD	39	Brakes	33, 37
ENGINE		Clutch	19, 33
Air Cleaner	9	GREASERS AND FITTINGS	37
Crankcase and Cylinders	5	GEARBOX	
Cylinder Head	9	Bearings	21
Crankshaft and Bearings	7	Free Wheel	21, 23, 31
Camshaft and Bearings	9	Gearcase and Covers	19, 21
Connecting Rods and Pistons	7	Gears and Shafts	19, 21
Carburetter	17	HAND CONTROL	
Chains and Chain Wheels	11	Brake	33
Coil	15	Change Speed	23
Dynamo	15	Free Wheel	23, 31
Damper on Crankshaft	7	Ignition	31
Distributor	15	Jet	31
Exhaust Manifold	39	Throttle	31
Engine Support Details	5	IGNITION	15, 31
Fan	9	LOCKHEED PIPES	33, 37
Flywheel	19	LUGGAGE GRILLE	40
Ignition	15, 31	PROPELLER SHAFT AND UNIVERSAL JOINTS	23
Inlet Manifold	17	PETROL TANK	
Oil Base	5	Petrol Tank	39
Oil Pump	11	Petrol Pipes	39
Oil Strainer	13	ROAD SPRINGS AND SUSPENSION	35, 37
Oil Cleaner	13	RADIATOR AND FITTINGS	39
Oil Filler	13	STEERING	25, 31
Oil Pipes	13	SILENCER AND EXHAUST PIPES	39
Valves and Valve Springs	9	SHOCK ABSORBERS AND FITTINGS	35
Valve Rockers and Shaft	9	SPARE WHEEL CARRIER	40
Water Inlet Pipe	5	TOOL KIT	41
Water Pump	11	WINGS AND RUNNING-BOARDS	40
Water Outlet Pipe	9		

WOLSELEY 21/60 H.P. (SIX-CYLINDER) COUNTY MODEL
(with Automatic Clutch Control)

INTRODUCTION

THIS list of Spares for the Wolseley 21/60 h.p. Cars has been compiled in order to facilitate the ordering of parts which require replacement. The parts are grouped into components, and all the principal pieces are illustrated. When ordering, clients should quote the Service Number, together with the description of the part, in order to minimise the possibility of error.

We would particularly impress upon clients the importance of always quoting the MAKER'S CAR NUMBER (not Registration Number), which will be found on the metal name-plate on the near-side of the Dashboard Shroud under the Bonnet. The ENGINE NUMBER will be found on the Engine Case (Near-side Rear), and should be quoted in addition to the Car Number when ordering Engine spares. The CHASSIS NUMBER will be found on the Dashboard Shroud under the Bonnet or on the Near-side Frame Member under the Bonnet and should be quoted in addition to the Car Number when ordering Chassis spares.

We reserve to ourselves the right to alter any part as may be considered advantageous, and therefore it is possible that illustrations shown in this book may not in all cases exactly resemble the actual part required.

All parts sent to be repaired must be forwarded carriage paid. These may be forwarded to either of the addresses on the title page, and must bear the Sender's Name, Address, and Maker's Car Number.

All parts sent for repairs are acknowledged as soon as received.

To avoid delay, customers with whom we have no ledger account should send cash with order.

See separate Schedule for Prices.

Instruction Manual shows List of Service Stations for Proprietary Articles.

In order to assist customers who desire to send a telegram, we give below the telegraphic codes referring to service matters—

NMMAE	...	Wolseley 21/60 h.p. Car No.....
SEREB	...	Referring to your communication Service Manager dated.....
SEREM	...	Referring to your communication Estimating dated.....
SEREP	...	Referring to your communication General Office dated.....
SERFU	...	Despatch immediately per post and charge our account for Car No.....
SERGI	...	Despatch immediately per passenger train and charge our account for Car No.....
SERJO	...	Despatch per post direct to Customer and charge our account for Car No.....
SERKS	...	Despatch per passenger train direct to Customer and charge our account for Car No.....
SERMY	...	Advise delivery date for our Order No.....
SERNA	...	Please quote but do not supply pending official order for following spares for Car No.....
SEROT	...	Can you supply from stock for Car No.....
SERSK	...	Priced invoice to be sent with spares.
SERTE	...	Complete with all fittings.
SERUS	...	With studs and nuts only.
SERYL	...	Complete with bearings.
C.O.D.	...	Cash on Delivery.

WOLSELEY MOTORS (1927) LTD.

WOLSELEY 21/60 H.P. (SIX-CYLINDER) COUNTY MODEL (with Automatic Clutch Control)

INTRODUCTION

THIS list of Spares for the Wolseley 21/60 h.p. Cars has been compiled in order to facilitate the ordering of parts which require replacement. The parts are grouped into components, and all the principal pieces are illustrated. When ordering, clients should quote the Service Number, together with the description of the part, in order to minimise the possibility of error.

We would particularly impress upon clients the importance of always quoting the MAKER'S CAR NUMBER (not Registration Number), which will be found on the metal name-plate on the near-side of the Dashboard Shroud under the Bonnet. The ENGINE NUMBER will be found on the Engine Case (Near-side Rear), and should be quoted in addition to the Car Number when ordering Engine spares. The CHASSIS NUMBER will be found on the Dashboard Shroud under the Bonnet or on the Near-side Frame Member under the Bonnet and should be quoted in addition to the Car Number when ordering Chassis spares.

We reserve to ourselves the right to alter any part as may be considered advantageous, and therefore it is possible that illustrations shown in this book may not in all cases exactly resemble the actual part required.

All parts sent to be repaired must be forwarded carriage paid. These may be forwarded to either of the addresses on the title page, and must bear the Sender's Name, Address, and Maker's Car Number.

All parts sent for repairs are acknowledged as soon as received.

To avoid delay, customers with whom we have no ledger account should send cash with order.

See separate Schedule for Prices.

Instruction Manual shows List of Service Stations for Proprietary Articles.

In order to assist customers who desire to send a telegram, we give below the telegraphic codes referring to service matters—

NMMAE	...	Wolseley 21/60 h.p. Car No.....
SEREB	...	Referring to your communication Service Manager dated.....
SEREM	...	Referring to your communication Estimating dated.....
SEREP	...	Referring to your communication General Office dated.....
SERFU	...	Despatch immediately per post and charge our account for Car No.....
SERGI	...	Despatch immediately per passenger train and charge our account for Car No.....
SERJO	...	Despatch per post direct to Customer and charge our account for Car No.....
SERKS	...	Despatch per passenger train direct to Customer and charge our account for Car No.....
SERMY	...	Advise delivery date for our Order No.....
SERNA	...	Please quote but do not supply pending official order for following spares for Car No.....
SEROT	...	Can you supply from stock for Car No.....
SERSK	...	Priced invoice to be sent with spares.
SERTE	...	Complete with all fittings.
SERUS	...	With studs and nuts only.
SERYL	...	Complete with bearings.
C.O.D.	...	Cash on Delivery.

WOLSELEY MOTORS (1927) LTD.

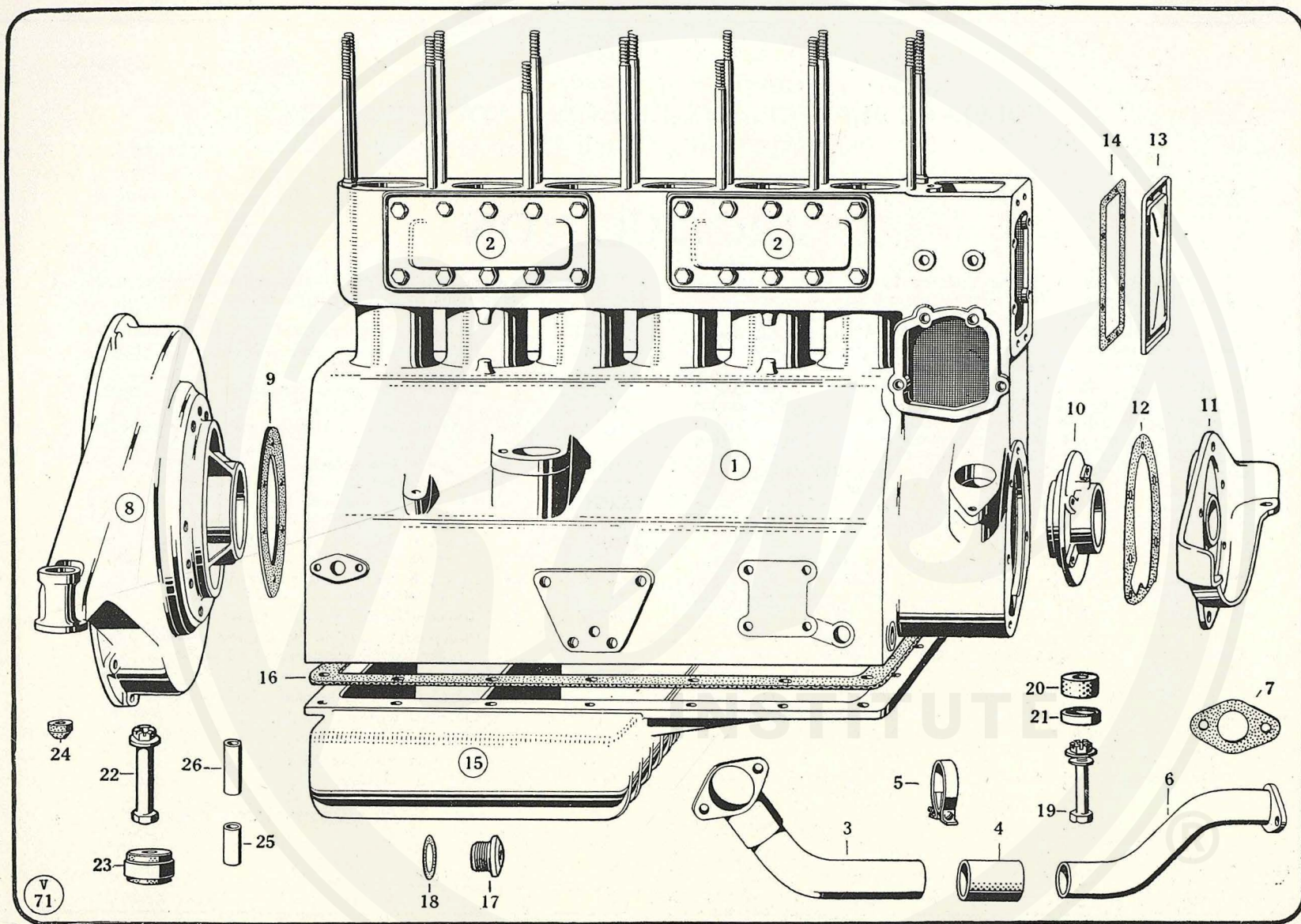

WOLSELEY 21/60 H.P. (SIX-CYLINDER) COUNTY MODEL

Crankcase, Oil Base and Engine Support Details

No. of Illustration.	Service No. for Ordering.	Description of Part.	No. of Illustration.	Service No. for Ordering.	Description of Part.
Crankcase and Cylinders					
1	V5001A	Crankcase and Cylinders complete with Water Jacket, Covers and Main Bearings ("A" Type)	13	V3019	Cover for Chain Case
	V5002A	Crankcase and Cylinders complete with Water Jacket, Covers and Main Bearings ("B" Type)	14	V3020	Joint for Chain Case Cover
			<i>Note :—For Engine Chains and Wheels see Page 11.</i>		
2	M7	Cover-plate for Cylinder Jacket (Front or Rear)	Oil Base		
—	M9—1	Joint for Cover-plates (Front or Rear)	15	V3031A	Oil Base complete
—	M10	Set Screw for Cover-plates	16	G27	Joint for Oil Base
—	V3007	Set Screw for Cover-plate and Ignition Coil	17	G29	Drain Plug for Oil Base
3	V3008A	Water Inlet Pipe (Rear Portion)	18	V3034	Washer for Drain Plug
4	V3009	Rubber Hose for Inlet Pipes	Engine Support Details		
5	M1511	Clip for Rubber Hose	19	V3041A	Front Engine Holding-down Bolt, Nut, Washer and Split Pin
6	V3011A	Water Inlet Pipe (Front Portion)	20	V42	Rubber Seating Block for Engine (Front)
7	M12	Joint for Water Inlet Pipe (Front or Rear)	21	V43	Cup for Seating Block (Front)
<i>Note :—For Rubber Hose to Radiator see Page 39.</i>			22	V3044A	Rear Engine Holding-down Bolt, Nut, Washer and Split Pin
8	V5013A	Bell Housing complete with Main Bearing	23	G46	Rubber Seating Block for Rear Engine Arm complete with Metal Ring
9	G11	Joint for Bell Housing	24	G48	Coned Rubber Seat for Rear Engine Holding-down Bolt
—	V3015	Set Screw for Bell Housing to Crankcase	25	V3047	Distance Piece for Bolt (Rear) (Short)
10	V3016	Housing for Front Crankshaft Bearing	26	V3048	Distance Piece for Bolt (Rear) (Long)
11	V5017A	Front Cover and Engine Front Support			
12	V3018	Joint for Front Cover			

Please state maker's CAR NUMBER and ENGINE NUMBER when ordering. See note on Page 3. Prices of Spare Parts are shown on separate list.

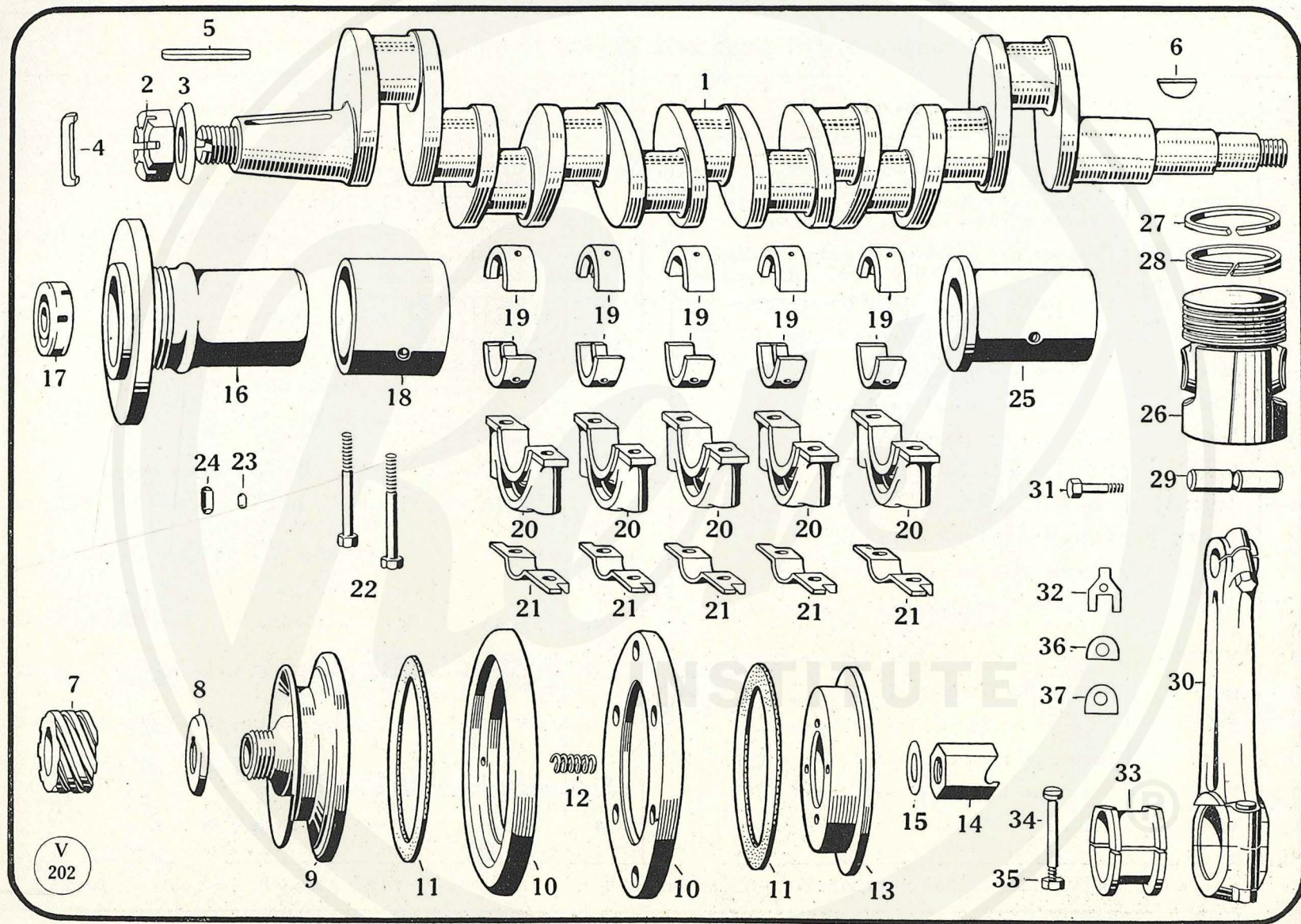

Crankshaft and Bearings, Damper, Connecting Rod and Piston

No. of Illustration.	Service No. for Ordering.	Description of Part.	No. of Illustration.	Service No. for Ordering.	Description of Part.
Crankshaft			Connecting Rod and Piston		
1	V3101A	Crankshaft complete with Keys and Flange Retaining Nut and Locking Wire	—	V5140A	Piston complete with Rings "A" Type
2	H52	Flange Retaining Nut	—	V5141A	Piston complete with Rings "B" Type
3	V3103	Washer for Retaining Nut	26	V5134—1	Piston only (less Rings) "A" Type
4	G21	Locking Wire for Retaining Nut		V5135—1	Piston only (less Rings) "B" Type
5	V104	Key for Driving Flange	27	G2073	Piston Ring "A" Type
6	M105	Key for Crankshaft (Front End)		G2074	Piston Ring "B" Type
7	V3107	Spiral Driving Gear for Oil and Water Pumps	28	V5147	Oil Control Ring "A" Type
8	M2122	Oil Thrower for Crankshaft (Front End)		V5148	Oil Control Ring "B" Type
9	V5108	Dynamo Pulley (Driver)	29	G2086—1	Gudgeon Pin
10	G2053—1	Damper Ring	30	V5165A	Connecting Rod with Small-end Pinch Bolt, Cap and Big-end Bearing
11	G2054	Friction Ring for Damper	31	G55	Pinch Bolt for Small-end
12	G2055—1	Spring for Damper	32	G56	Tab Locking Washer for Pinch Bolt
13	G2052	Clamping Flange for Damper	33	V3166A	Bearing Bush for Big-end (two halves)
14	V3110	Starting Dog	34	L167	Bolt for Connecting Rod
15	V3111	Packing Shim for Starting Dog	35	E71	Nut for Bolt
16	V119	Driving Flange for Crankshaft (Rear End)	36	V3153	"D" Washer for Bolt Head
17	G721	Ball Bearing in Driving Flange	37	V3154	"D" Washer for Nut
Bearings and Housings			Sub-Assemblies		
18	V120	Bearing Bush (in Bell Housing)	—	V5171A	Connecting Rod and Piston assembled complete "A" Type
19	V131A	Bearing Bush for Crankshaft (Intermediate) (two halves)	—	V5172A	Connecting Rod and Piston assembled complete "B" Type
20	V132	Cap for Intermediate Bearings	—	L174A	Bolt, Washers, Nut and Split Pin for Connecting Rod Big-end
21	V133	Lock Plate for Bearing Cap			
22	V3124	Set Screw for Bearing Cap			
23	V3125	Dowel for Intermediate Bearings			
24	V134	Dowel for Bearing Caps			
25	V3120	Bearing Bush (Crankshaft Front End)			

Please state maker's CAR NUMBER and ENGINE NUMBER when ordering. See note on Page 3. Prices of Spare Parts are shown on separate list.

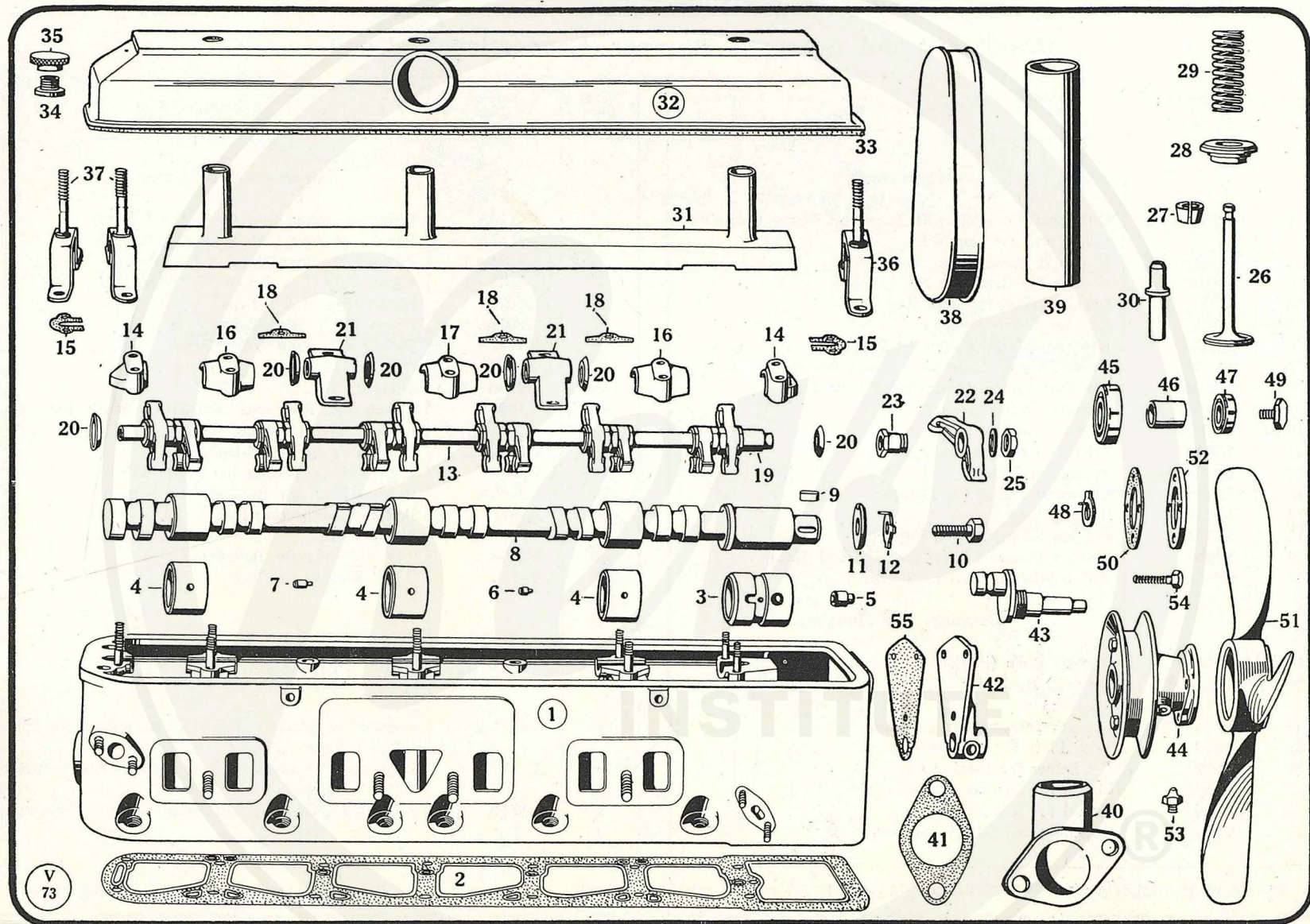

WOLSELEY 21/60 H.P. (SIX-CYLINDER) COUNTY MODEL

Cylinder Head, Camshaft, Valves, Air Cleaner and Fan

No. of Illus- tration.	Service No. for Ordering.	Description of Part.	No. of Illus- tration.	Service No. for Ordering.	Description of Part.
Cylinder Head and Camshaft					
1	V5201A	Cylinder Head (Studded)	33	V3247	Joint for Cylinder Head Cover
2	V5202	Joint for Cylinder Head	34	V3248	Cover Nut for Cylinder Head
3	V3203	Bearing Bush for Camshaft (Front End)	35	E97—1	Head for Cover Nut
4	V3204	Bearing Bush for Camshaft (Intermediate or Rear)	36	V3249A	Strap for Cylinder Head Cover (Front) with Stud
5	V3205	Dowel for Front Bearing Bush	37	V3250A	Strap for Cylinder Head Cover (Intermediate or Rear) with Stud
6	V3206	Dowel for Intermediate or Rear Bearing Bush	38	V3251A	Air Cleaner Banjo
7	V3206	Dowel for Centre Bearing Bush	39	V3252	Hot Air Pipe
8	V3208	Camshaft			
9	V3209	Key for Camshaft Chain Wheel			
10	V3210	Set Screw for Camshaft			
11	V3211	Washer for Camshaft	40	V5261	Water Outlet Pipe
12	V3212	Tab Washer for Camshaft	41	V3262	Joint for Water Outlet Pipe
		<i>Note :—For Camshaft Chain Wheel see Page 11.</i>			
Valves and Valve Rockers					
13	V3213	Shaft for Valve Rockers	42	V5265A	Fan Pulley Bracket
14	V3214	Cap for Rocker-shaft (Front or Rear)	43	V5266	Fan Spindle
15	V3215	Joint for Cap (Front or Rear)	44	V5267A	Fan Pulley complete
16	V3216	Cap for Rocker-shaft (Intermediate)	45	V5268	Rear Ball Bearing for Fan
17	V3218	Cap for Rocker-shaft (Centre)	46	V5269	Distance Piece for Fan Bearings
18	V3217	Joint for Cap (Intermediate or Centre)	47	V5270	Front Ball Bearing for Fan
19	V3219	Distance Piece for Rocker-shaft (Front End)	48	V5271	Locking Washer for Bolt
20	V3220	Belleville Washer for Rocker-shaft	49	V325	Bolt for Fan Spindle (Front End)
21	V3221A—1	Steady Bracket for Rocker-shaft	50	V380	Joint for Fan Centre
—	V3232	Packing Shim for Steady Bracket	51	V5274	Fan
22	V3222	Valve Rocker-arm (Inlet)	52	V5275	End Cover for Fan Centre
—	V3223A	Valve Rocker-arm (Exhaust)	—	V5276	Fan Belt
23	V3224	Eccentric Bush for Valve Rocker	53	TG101	Greaser for Fan
24	V3225	Locking Washer for Eccentric Bush	54	M817	Pinch Bolt for Fan Spindle
25	V3226	Locking Nut for Eccentric Bush	55	V3242	Joint for Fan Bracket
26	V3227	Inlet or Exhaust Valve			<i>Note :—For Fan Pulley on Dynamo see Page 15.</i>
27	V3228	Split Collar for Valve (two halves)			
28	V3229	Valve Spring Cup			
29	V3230	Valve Spring			
30	V3231	Valve Guide			
Cylinder Head Cover and Air Cleaner					
31	V3244A	Air Cleaner Cover-plate	—	V5281A	Cylinder Head complete with Camshaft, Valves, etc. (less Cover and Water Outlet Pipe)
32	V3246A	Cylinder Head Cover with Joint and Holding-down Nuts	—	V3282A	Valve Rocker complete with Eccentric Bush and Lock Nut (Inlet)
			—	V3283A	Valve Rocker complete with Eccentric Bush and Lock Nut (Exhaust)
			—	V5284A	Fan complete (less Bracket)

Please state maker's CAR NUMBER and ENGINE NUMBER when ordering. See note on Page 3. Prices of Spare Parts are shown on separate list.

WOLSELEY 21/60 H.P. (SIX-CYLINDER) COUNTY MODEL

Cylinder Head, Camshaft, Valves, Air Cleaner and Fan

No. of Illus- tration.	Service No. for Ordering.	Description of Part.	No. of Illus- tration.	Service No. for Ordering.	Description of Part.
Cylinder Head and Camshaft					
1	V5201A	Cylinder Head (Studded)	33	V3247	Joint for Cylinder Head Cover
2	V5202	Joint for Cylinder Head	34	V3248	Cover Nut for Cylinder Head
3	V3203	Bearing Bush for Camshaft (Front End)	35	E97—1	Head for Cover Nut
4	V3204	Bearing Bush for Camshaft (Intermediate or Rear)	36	V3249A	Strap for Cylinder Head Cover (Front) with Stud
5	V3205	Dowel for Front Bearing Bush	37	V3250A	Strap for Cylinder Head Cover (Intermediate or Rear) with Stud
6	V3206	Dowel for Intermediate or Rear Bearing Bush	38	V3251A	Air Cleaner Banjo
7	V3206	Dowel for Centre Bearing Bush	39	V3252	Hot Air Pipe
8	V3208	Camshaft			
9	V3209	Key for Camshaft Chain Wheel			
10	V3210	Set Screw for Camshaft			
11	V3211	Washer for Camshaft	40	V5261	Water Outlet Pipe Water Outlet Pipe
12	V3212	Tab Washer for Camshaft	41	V3262	Joint for Water Outlet Pipe
		<i>Note :—For Camshaft Chain Wheel see Page 11.</i>			
Valves and Valve Rockers					
13	V3213	Shaft for Valve Rockers	42	V5265A	Fan Pulley Bracket
14	V3214	Cap for Rocker-shaft (Front or Rear)	43	V5266	Fan Spindle
15	V3215	Joint for Cap (Front or Rear)	44	V5267A	Fan Pulley complete
16	V3216	Cap for Rocker-shaft (Intermediate)	45	V5268	Rear Ball Bearing for Fan
17	V3218	Cap for Rocker-shaft (Centre)	46	V5269	Distance Piece for Fan Bearings
18	V3217	Joint for Cap (Intermediate or Centre)	47	V5270	Front Ball Bearing for Fan
19	V3219	Distance Piece for Rocker-shaft (Front End)	48	V5271	Locking Washer for Bolt
20	V3220	Belleville Washer for Rocker-shaft	49	V325	Bolt for Fan Spindle (Front End)
21	V3221A—1	Steady Bracket for Rocker-shaft	50	V380	Joint for Fan Centre
—	V3232	Packing Shim for Steady Bracket	51	V5274	Fan
22	V3222	Valve Rocker-arm (Inlet)	52	V5275	End Cover for Fan Centre
—	V3223A	Valve Rocker-arm (Exhaust)	—	V5276	Fan Belt
23	V3224	Eccentric Bush for Valve Rocker	53	TG101	Greaser for Fan
24	V3225	Locking Washer for Eccentric Bush	54	M817	Pinch Bolt for Fan Spindle
25	V3226	Locking Nut for Eccentric Bush	55	V3242	Joint for Fan Bracket
26	V3227	Inlet or Exhaust Valve			<i>Note :—For Fan Pulley on Dynamo see Page 15.</i>
27	V3228	Split Collar for Valve (two halves)			
28	V3229	Valve Spring Cup			
29	V3230	Valve Spring			
30	V3231	Valve Guide			
Cylinder Head Cover and Air Cleaner					
31	V3244A	Air Cleaner Cover-plate	—	V5281A	Sub-Assemblies Cylinder Head complete with Camshaft, Valves, etc. (less Cover and Water Outlet Pipe)
32	V3246A	Cylinder Head Cover with Joint and Holding-down Nuts	—	V3282A	Valve Rocker complete with Eccentric Bush and Lock Nut (Inlet)
			—	V3283A	Valve Rocker complete with Eccentric Bush and Lock Nut (Exhaust)
			—	V5284A	Fan complete (less Bracket)

Please state maker's CAR NUMBER and ENGINE NUMBER when ordering. See note on Page 3. Prices of Spare Parts are shown on separate list.

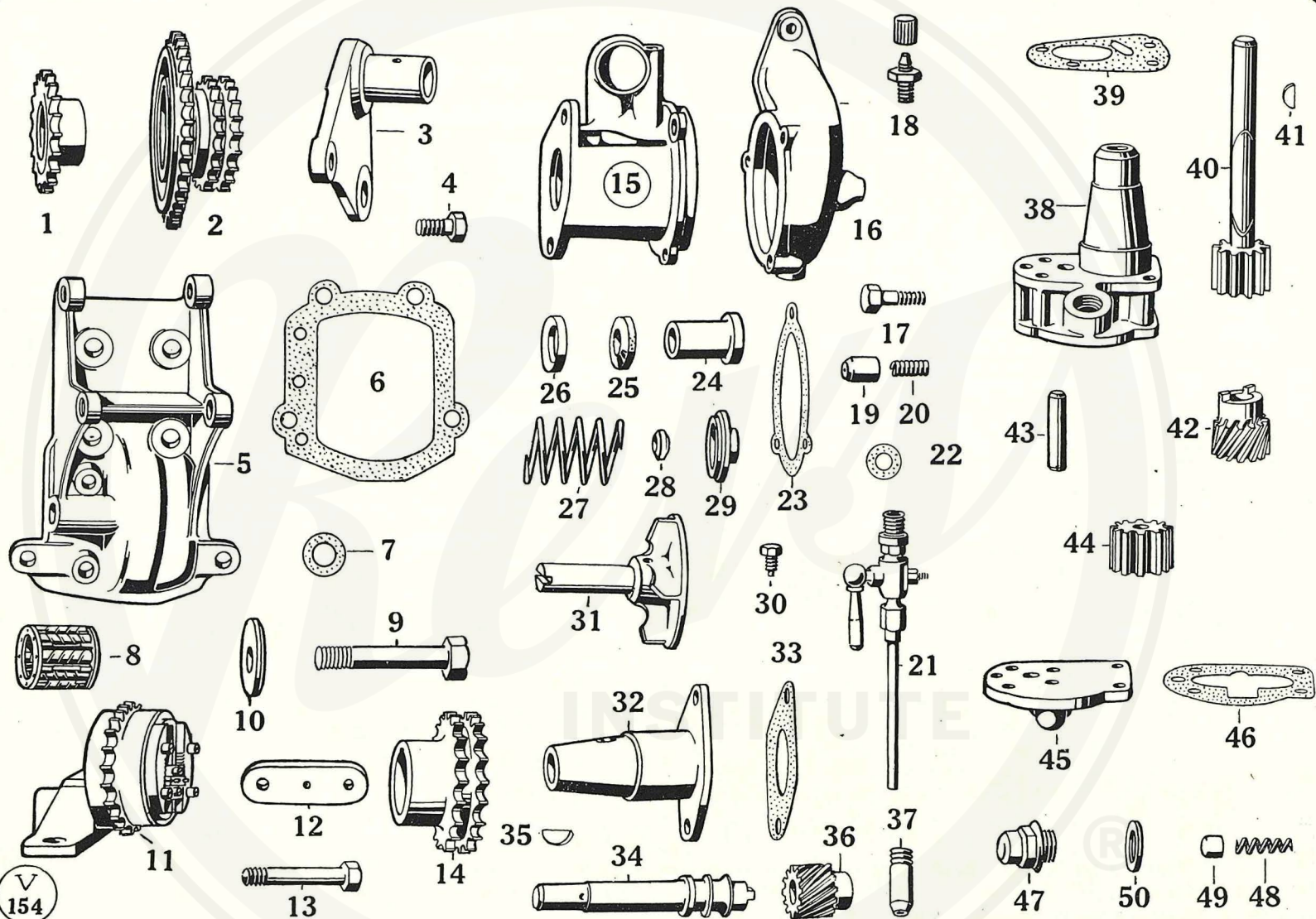

WOLSELEY 21/60 H.P. (SIX-CYLINDER) COUNTY MODEL

Engine Chains, Chain Wheels and Fittings, Water Pump and Oil Pump Details

No. of Illustration.	Service No. for Ordering.	Description of Part.	No. of Illustration.	Service No. for Ordering.	Description of Part.
Engine Chains and Wheels					
1	M2301—1	Crankshaft Chain Wheel	25	M6332	Gland for Pump Body
—	V3302	Single Roller Chain (Endless)	26	M6333	Gland Collar
2	M2303A	Countershaft Chain Wheel complete	27	M6334	Spring for Pump Gland
3	V3304	Support Bracket for Countershaft Chain Wheel	28	M6335	Gland Ring
4	V3305	Set Screw for Support Bracket	29	M6336	Gland for Pump Spindle
5	V3306A	Bracket for Chain Tensioner and Dynamo	30	F125	Locking Screw for Bush
6	M2025	Joint for Bracket	31	M2345A—1	Pump Spindle assembled with Rotor
7	M2026	Shim for Bracket	32	M2346	Bracket for Water Pump Spindle
8	V3309	Hyatt Roller Bearing for Countershaft Chain Wheel	33	M2347	Joint for Bracket
9	M2308	Locking Bolt for Countershaft Chain Wheel	34	M2348	Driving Shaft for Water Pump
10	V3311	Thrust Washer for Locking Bolt	35	H189	Key for Driven Gear
—	M2310	Tensioner Chain Wheel	36	M2350	Spiral Driven Gear for Water Pump
11	M2318A	Chain Tensioner complete with Wheel and Bracket	37	V3322	Adaptor for Thermostat
—	V3313	Joint for Chain Tensioner Packing Block	—	M2351A	Driving Shaft complete with Spiral Gear
12	V5314	Packing Block for Chain Tensioner	—	V3320A—1	Water Pump complete
13	V5315	Bolt for Tensioner Bracket	Oil Pump		
—	V5316	Duplex Roller Chain	38	V3361	Oil Pump Body
—	M2315	Connecting Link and Spring Clip for Duplex Chain	39	V3362	Joint for Oil Pump Body
—	M2317	Spring Clip for Connecting Link	40	V3363	Oil Pump Spindle
14	V5319	Camshaft Chain Wheel	41	H189	Key for Spindle
Water Pump			42	V3365	Oil Pump Spiral Driven Gear. (This Gear also drives Distributor)
15	V3321A	Water Pump Body (Bushed)	43	V347	Idle Spindle for Driven Gear
16	M2332A	Cover for Water Pump Body (Studded)	44	E2031	Oil Pump Driven Gear
17	M2333	Bolt for Water Outlet Flange	45	V3368—1	Oil Pump Cover
18	M2334	Greaser Nipple for Body or Cover	46	V3369	Joint for Oil Pump Cover
19	M2336	Plunger for Pump Rotor	47	M361—1	Relief Valve
20	M2337—1	Spring for Plunger	48	M362	Spring for Relief Valve
21	M1504	Drain Tap for Water Pump Cover	49	V3372—1	Plug for Relief Valve
22	GD12	Washer for Drain Tap	50	E24	Washer for Plug
23	M2339	Joint for Pump Body and Cover	—	V3381A	Oil Pump complete with Relief Valve and Spiral Gear
24	M6331	Bush in Pump Body	<i>Note :—For Oil Pipes see Page 13.</i>		

Please state maker's CAR NUMBER and ENGINE NUMBER when ordering. See note on Page 3. Prices of Spare Parts are shown on separate list.

Diagrammatic View of Offside of Engine.

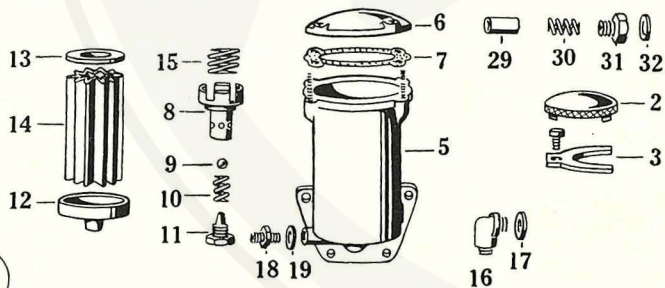
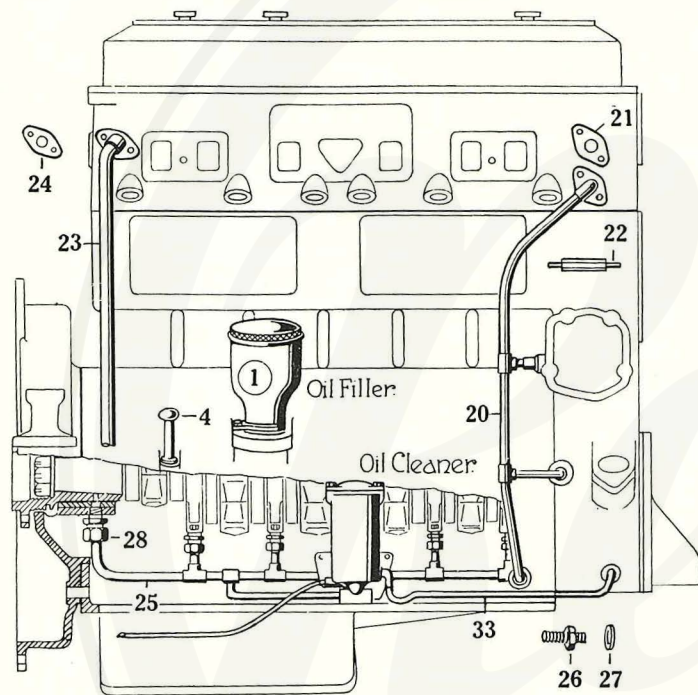

V
155

Diagrammatic View of Nearside of Engine.

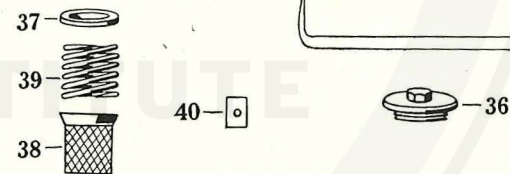
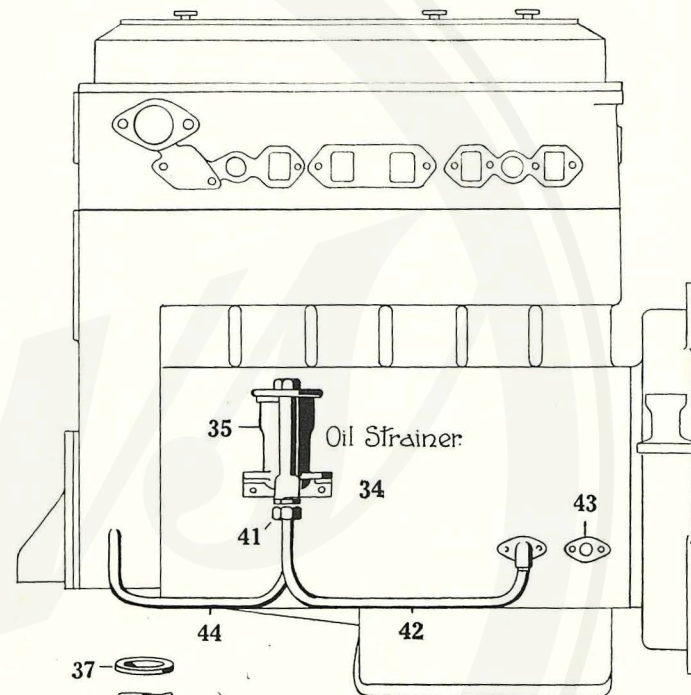

WOLSELEY 21/60 H.P. (SIX-CYLINDER) COUNTY MODEL

Oil Strainer, Oil Filler, Oil Cleaner and Oil Pipes

No. of Illustration.	Service No. for Ordering.	Description of Part.	No. of Illustration.	Service No. for Ordering.	Description of Part.
OFF-SIDE OF ENGINE					
Oil Filler					
1	V3401A	Oil Filler complete with Cap	24	V426	Joint for Drain Pipe Flanges
2	V3402	Cap for Oil Filler complete	25	V3440A	Main Feed Oil Pipe complete with Equalising Valve, Tee Pieces, Nuts and Nipples
3	V3403	Clamp Plate for Oil Filler	26	V3441	Union in Crankcase for Main Feed
—	M271	Set Screw for Oil Filler	—	V3442	Joint (Equalising Valve Body)
			27	V3427	Washer for Main Feed Pipe Union
			28	V3443	Union in Bell Housing for Main Feed (also forms Dowel for Bearing)
Dipstick			29	V3444	Control Plunger
4	V5410	Oil Level Dipstick	30	M2381	Spring for Plunger
			31	V3446	Plug
Oil Cleaner			32	V451	Washer for Plug
—	V3413	Joint (Cleaner Case to Crankcase)	33	V3448A—1	Oil Pipe (Pump to Cleaner) with Nuts and Nipples
5	V3415A	Oil Cleaner Case (Studded)	NEAR-SIDE OF ENGINE		
6	V3416—1	Cap for Oil Cleaner	Oil Strainer		
7	V3417	Joint for Cap	34	V3451	Bracket for Strainer
8	V3418	Oil Relief Valve Body	—	E192	Screw for Bracket
9	M2467	Bronze Ball ($\frac{5}{16}$ in. dia.)	—	E29A—1	Oil Strainer complete
10	V3371	Spring for Relief Valve	35	E30—2	Oil Strainer Body
11	M2469	Plug for Relief Valve	36	E31—3	Cover for Oil Strainer
12	M2470	Socket for Cleaner Element	37	E32	Washer for Cover
13	V3423	Plate for Cleaner	38	E37A—2	Oil Strainer Gauze
14	V3424	Oil Cleaner Element	39	E39	Spring for Strainer
15	M2473	Spring for Element Location	40	E83	Locking Plate for Union
16	V3431	Elbow for Filter	41	G305—1	Union for Strainer
17	V3427	Washer for Elbow	—	V3461A	Bolt, Nut and Washer (Strainer to Bracket)
18	M422	Union for Pressure Gauge Pipe	—	M442	Screw for Locking Plate
19	V3429	Washer for Union	Oil Pipes		
—	V3430A	Oil Cleaner complete	42	V3465A	Oil Suction Pipe (Strainer to Crankcase) complete with Nut and Flange
Oil Pipes			43	V464	Joint for Oil Suction Pipe Flange (one inside Crankcase)
20	V5435A	Cylinder Head Oil Feed Pipe complete with Pipe to Chain Tensioner, Top Flange, Nuts and Nipples	—	V3467A	Oil Suction Pipe (inside Crankcase) with Flange
21	G317	Joint for Feed Pipe Flange	44	V3468A	Oil Suction Pipe (Strainer to Pump) complete with Nuts
22	V437	Oil Feed Restrictor			
23	V5438A	Cylinder Head Oil Drain Pipe complete with Flanges			

Please state maker's CAR NUMBER and ENGINE NUMBER when ordering. See note on Page 3. Prices of Spare Parts are shown on separate list.

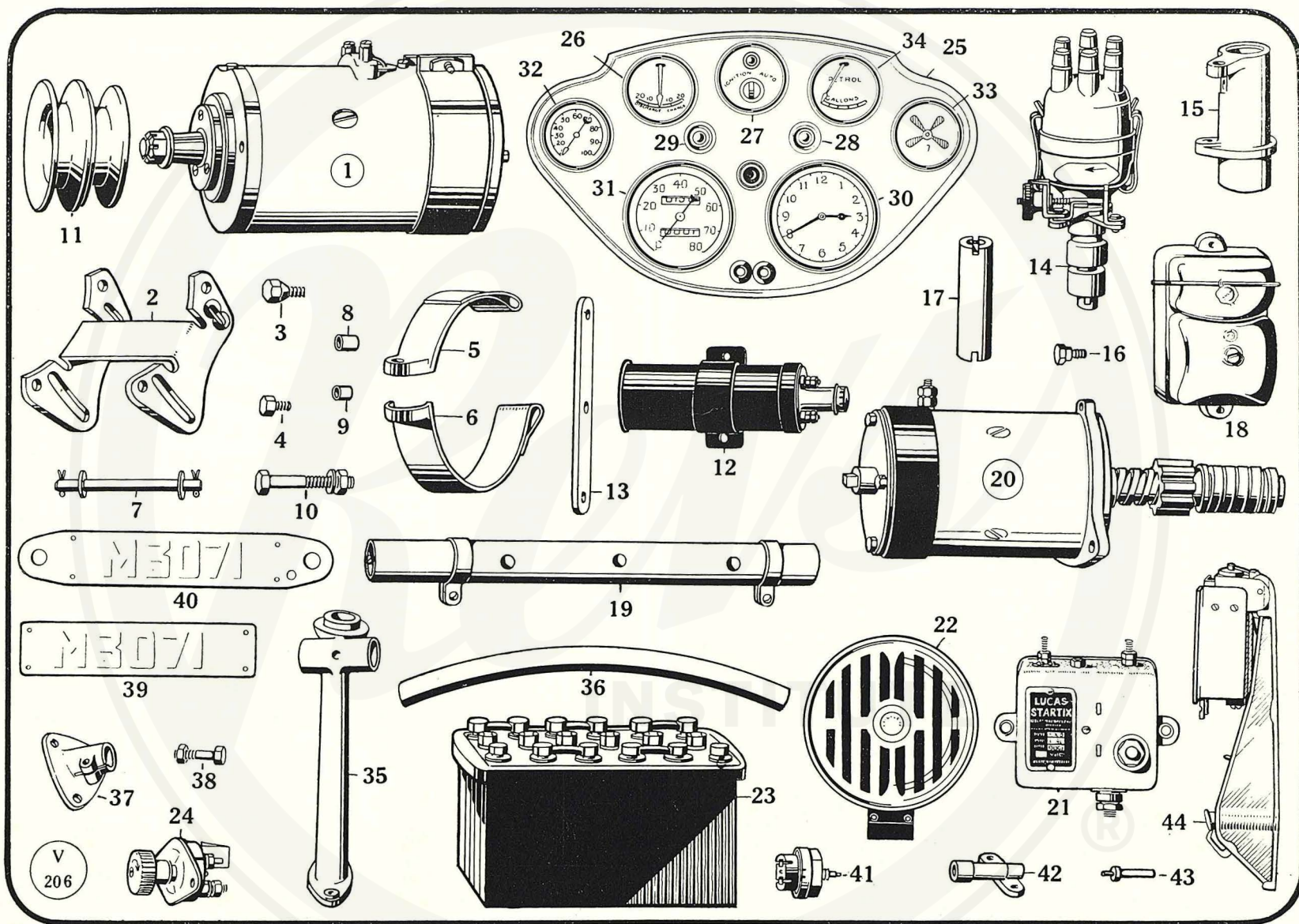

WOLSELEY 21/60 H.P. (SIX-CYLINDER) COUNTY MODEL

Electrical Equipment, also Instrument Board Fittings

No. of Illustration.	Service No. for Ordering.	Description of Part.	No. of Illustration.	Service No. for Ordering.	Description of Part.
Dynamo and Fittings			26	V3542	Ammeter
1	V5501	Dynamo (Type C45A) (12-volt)	27	V3543—1	Combined Ignition and Starter Switch
2	V5502	Dynamo Cradle	28	V3544	Fog Lamp Switch
3	V3503	Set Screw for Cradle (Top)	29	V3545	Panel Light Switch
4	V3504	Set Screw for Cradle (Bottom)	30	V3546	Clock
5	V5504	Strap for Dynamo	31	V5547	Speedometer Head (Smith's "Nemag")
6	V5505	Strap for Dynamo	32	V3548	Thermometer complete with 6 ft. of Tube
7	V3506A	Pin for Dynamo Straps with Washers and Split Pins	33	V3549	Oil Pressure Indicator
8	V3507	Distance Piece for Strap Pin	34	V5550	Petrol Gauge
9	V3508	Distance Piece for Strap Pin	—	V3551	Flexible Drive for Speedometer 5 ft. long
10	V3509A	Pinch Bolt, Nut and Washer for Straps	—	M2550	Bulb for Warning Light (3.5-volt .15 amp.)
11	V5510—1	Pulley on Dynamo	—	M554	Bulb for Panel Light (B.A.S.10S) (12-volt 6 watt)
—	V5511	Dynamo Driving Belt	Lighting Equipment		
—	V5276	Fan Driving Belt	—	V5561—1	Headlamp (Off-side)
<i>Note :—For Dynamo Driving Pulley see Page 7.</i>			—	V5561—2	Headlamp (Near-side)
Distributor and Coil and Ignition Wires			—	V5587	Bulb for Headlamp (12-volt 48 watt) Diffused Bulb
12	V3520	Ignition Coil (Model Q/12) 12-volt (Flat Clip Mounting)	—	V5564A	Bracket for Headlamp (Off-side)
13	V3521	Bracket for Ignition Coil	—	V5565A	Bracket for Headlamp (Near-side)
14	V5522	Distributor (D.J.6A) complete with Lever	35	V5566	Headlamp Cross Tube
15	V3523—1	Adaptor for Distributor	—	V5567A	Wing Bracket for Headlamp Cross Tube (Off-side)
—	M432	Set Screw for Adaptor	—	V5568A	Wing Bracket for Headlamp Cross Tube (Near-side)
16	V3526	Securing Screw for Distributor	36	G713—1	Pinching Screw for Wing Bracket
17	V3525	Driving Piece for Distributor	—	V3569	Sidelamp with Ruby Glass
—	V3527A—1	Set of Ignition Wires (High-tension)	—	M554	Bulb for Sidelamp (B.A.S.10S) (12-volt 6 watt)
18	V3528—1	Control Box (R.J.R.)	—	V3572—1	Fog Lamp complete with Bracket
19	V3529—1	Ignition Wire Tube	—	M2563	Bulb for Fog Lamp (B.A.S.10S No. 4) (12-v. 36 watt)
Starter and Details			—	M7712	Front Number-plate
20	V5531	Starter (Type M41842) (12-volt)	—	V3586	Tail-lamp
21	V3532—2	"Startix" Unit (Model SX5) (12-volt)	—	V3587	Reverse Lamp
Electric Horn and Battery			—	M554	Bulb for Tail or Stop Light (B.A.S.10S) (12-volt 6 watt)
22	V3535—1	Electric Horn (Type HF722) (12-volt)	—	M552	Bulb for Reverse Light (B.A.S. No. 3) (12-volt 24 watt)
23	M519—1	Battery (Type STW11A/12)	40	V5576—1	Rear Number-plate
24	M6535	Master Battery Switch	41	V3583	Switch for Reverse Light
Instrument Board Fittings			42	V5584	Bracket for Reverse Light Switch
25	V3541—1	Instrument Panel complete with Ammeter, combined Ignition and Starter Switch, Red Warning Light, Fog Lamp Switch, Panel Lights and Switch, and Inspection Lamp Sockets	43	V5585	Plunger for Reverse Light Switch
			—	M4584	Medallion for Radiator
			—	M4585	Bulb for Medallion (6 watt 12-volt Festoon)
			44	M6579	Trafficator
			—	M6580	Bulb for Trafficator

Please state maker's CAR NUMBER and ENGINE NUMBER when ordering. See note on Page 3. Prices of Spare Parts are shown on separate list.

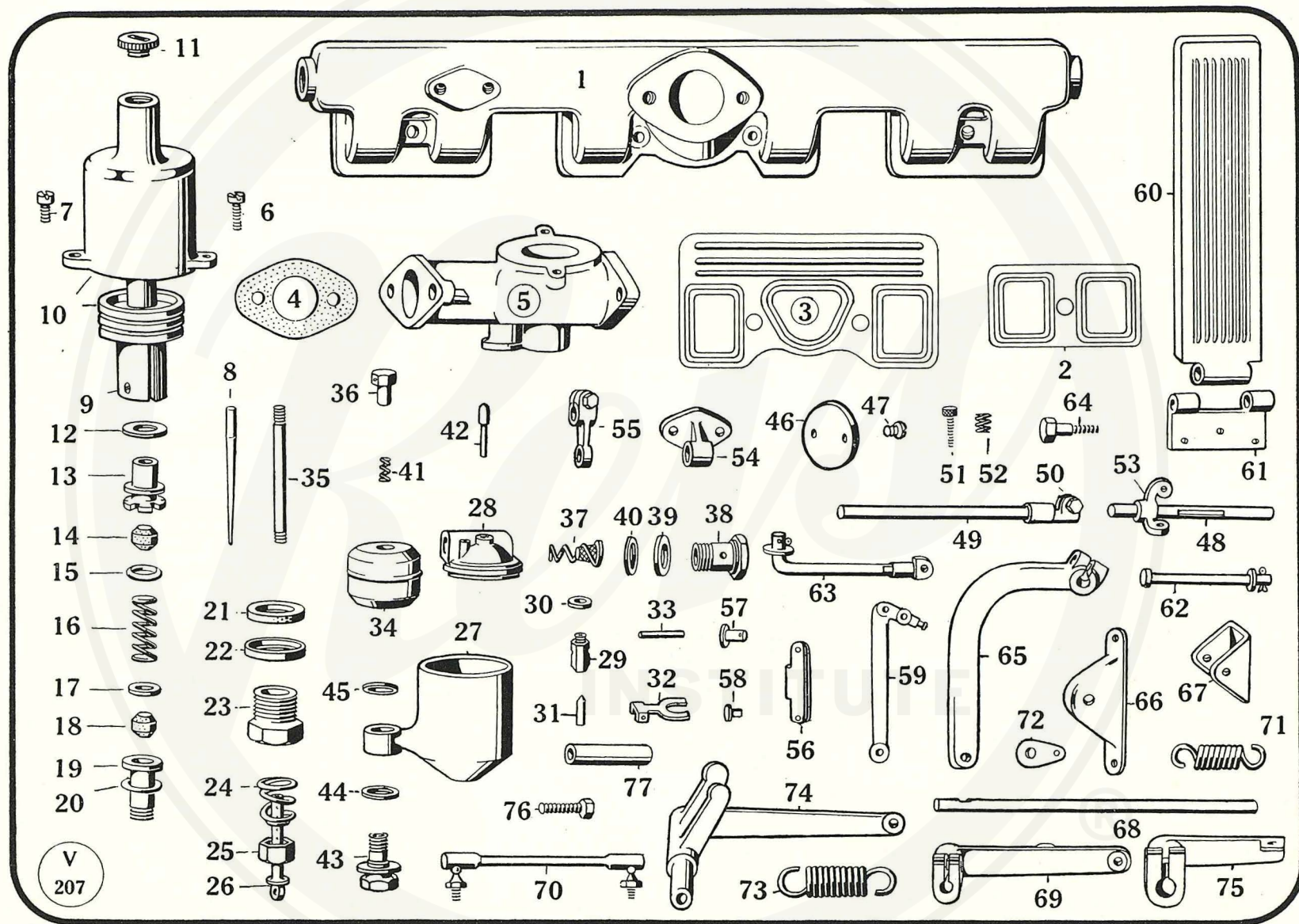

S.U. Carburetter (Adjustable Jet) and Accelerator Pedal

No. of Illustration.	Service No. for Ordering.	Description of Part.	No. of Illustration.	Service No. for Ordering.	Description of Part.
Inlet Branch and Joints					
1	V3601A—1	Inlet Branch	40	G474	Washer for Banjo Pin (Inner)
2	V3602	Joint for Inlet Branch (Front or Rear Ports)	41	M4640	Spring for Float Tickler
3	V3603	Joint for Inlet Branch (Centre)	42	M4641	Float Tickler
4	M605	Joint for Carburetter Body	43	M639	Holding-up Bolt for Float-chamber
Carburetter					
—	V3605A	Carburetter complete	44	M640	Washer for Holding-up Bolt (Outer)
5	V3606—1	Carburetter Body	45	H397	Washer for Holding-up Bolt (Inner)
6	E394	Screw for securing Dashpot Cover (Long)	46	G510	Throttle Disc
7	E426	Screw for securing Dashpot Cover (Short)	47	E427	Screw for Throttle Disc
8	V5609	Carburetter Needle	48	V3648	Throttle Spindle
9	G483	Screw for Needle	49	V3649	Throttle Spindle Extension Rod
10	V3611A	Dashpot Piston and Dashpot	50	V3647A	Coupling for Extension Rod with Bolt and Nut
11	E398	Oil Cap	51	V3650	Throttle Stop Screw
12	E424	Copper Washer (Top of Jet)	52	M635	Spring for Throttle Stop Screw
13	E399	Jet Bearing (Top Half)	53	G469	Throttle Stop Lever
14	E400	Cork Gland Washer (Top)	54	V3651	Throttle Shaft Bracket
15	E401	Brass Gland Washer (Top)	55	G470A	Throttle Control Lever
16	E402	Bronze Gland Spring	56	M644	Connecting Link for Jet Operating Lever
17	E401	Brass Gland Washer (Bottom)	57	V3653	Pin for Connecting Link (Long)
18	E400	Cork Gland Washer (Bottom)	58	E422	Pin for Connecting Link (Short)
19	E403	Jet Bearing (Bottom Half)	59	V3655—1	Jet Operating Lever
20	E425	Copper Packing Washer for Bottom Bearing	—	V3656	Return Spring for Jet Operating Lever
21	E404	Jet Sealing Washer (Cork)	Accelerator Pedal		
22	E405	Jet Sealing Washer (Brass)	60	V3671A	Accelerator Pedal
23	E406	Jet Screw	61	V3672	Hinge for Accelerator Pedal
24	E407	Jet Adjusting Spring	62	V3673A	Hinge Pin for Pedal with Washer
25	E408	Jet Adjusting Nut	63	V5674A	Control Rod (Pedal to Pedal Lever) with Eye Piece, Nut, Washer and Split Pin
26	E409	Jet	64	V3675A	Bolt for Eye Piece with Nut and Washer
27	V3628	Float-chamber	65	V5676A	Accelerator Pedal Lever with Pinch Bolt and Nut
28	V3629	Lid for Float-chamber	66	V3677	Dash Bracket for Throttle Control (Off-side)
29	V3630	Float Needle Seat	67	V3678	Dash Bracket for Throttle Control (Near-side)
30	V3631	Copper Washer for Needle Seat	68	V3679	Throttle Control Shaft
31	V3632	Float Needle	69	V5680A—1	Throttle Shaft Operating Lever with Pinch Bolt and Nut
32	V3633	Hinged Lever for Float	70	V5681A	Throttle Connecting Link with Nuts [Nut
33	V3634	Pin for Hinged Lever	71	V3682	Throttle Control Return Spring
34	V3635	Float	72	V3683—1	Anchor for Return Spring
35	V3636	Fixing Stud for Float-chamber Lid	73	E784—1	Return Spring for Intermediate Lever
36	M4635	Fixing Nut for Lid	74	V3680A—2	Throttle Operating Lever
37	G472A	Strainer Gauze and Spring	75	V3686A	Intermediate Throttle Lever with Pinch Bolt
38	M4637	Banjo Pin for Float-chamber	76	V3687A	Adjusting Screw and Nut for Intermediate Lever
39	M4638	Washer for Banjo Pin (Outer)	77	V3688	Distance Piece for Control Shaft

Note :—For Throttle and Jet Controls see Page 31.
For Automatic Clutch Control see Page 19.

Please state maker's CAR NUMBER and ENGINE NUMBER when ordering. See note on Page 3. Prices of Spare Parts are shown on separate list.

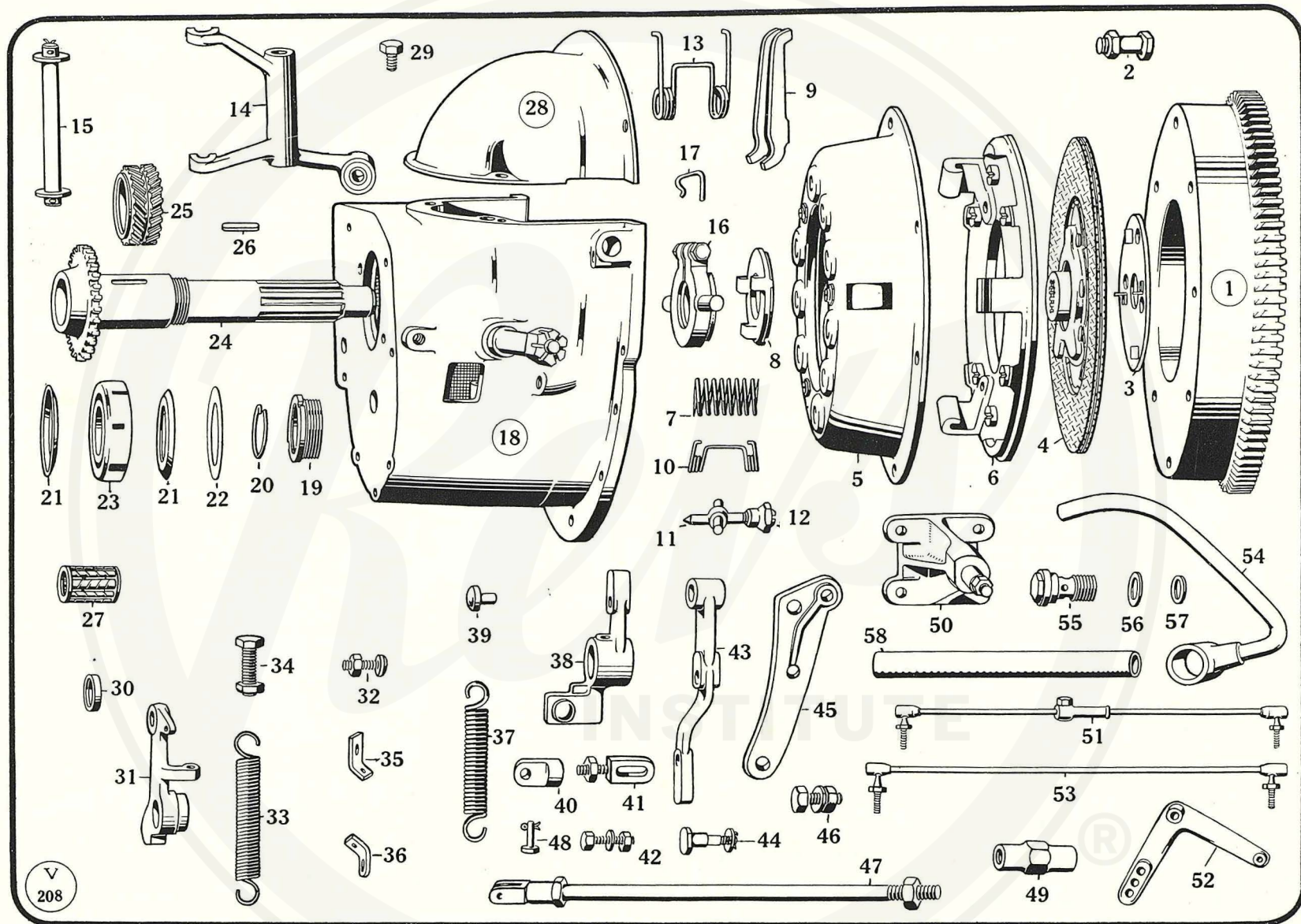

Flywheel, Clutch Pit and First Motion Shaft, also Automatic Clutch Control

No. of Illustration.	Service No. for Ordering.	Description of Part.	No. of Illustration.	Service No. for Ordering.	Description of Part.
Flywheel and Clutch			Clutch Operating Mechanism		
1	V3701	Flywheel	31	V9082A	Clutch Pedal Intermediate Lever (Bushed)
2	G701A	Bolt and Nut for Flywheel	32	V9056A	Stop Pin and Nut for Clutch Pedal
3	G702	Lock Plate for Flywheel Bolts	33	M679	Return Spring for Clutch Pedal
4	V3702A	Clutch Plate complete with Centre and two Fabrics	34	V9058A	Adjusting Screw and Nut for Clutch Pedal
—	V3703A	Clutch Cover complete with Springs, Finger Levers and Friction Plate	35	V3748	Spring Eye for Adjusting Screw
5	V3704	Clutch Cover	36	V3749	Spring Anchor on Clutch Pit
6	V3705	Clutch Pressure Plate	37	V3750	Return Spring for Clutch Operating Lever
7	V3706	Clutch Spring	38	V9062A—1	Clutch Operating Lever (Bushed)
8	V9007	Clutch Release Lever Plate	39	V9082	Thrust Button for Clutch Operating Lever
9	V3708	*Clutch Release Lever (Set of 3)	40	V9083	Eye Piece for Operating Link (Short)
10	V3709	Release Lever Retaining Wire	41	V9084A	Eye Piece for Operating Link (Long) with Lock Nut
11	V3710	*Clutch Release Lever Pin and Eye Bolt (Set of 3)	42	V9064A	Pin for Link with Nut and Washer
12	V3711	Nut for Clutch Eye Bolt	43	V9065	Intermediate Lever
13	V3712	Clutch Anti-Rattle Spring	44	V9066A	Fulcrum Pin for Intermediate Lever with Washer and
14	V3716—1	Clutch Operating Fork	45	V9067	Stop Bracket for Intermediate Lever [Split Pin
15	V3717A	Pin for Clutch Operating Fork with Washers and Split Pins	46	V9068A	Stop Pin and Nut for Intermediate Lever
16	V9022A	Release Bearing with Retainer	47	V9069A	Main Connecting Rod to Bendix Cylinder with Jaw Joint and Nuts
17	V9024	Release Bearing Retainer	48	V9070A	Pin, Washer and Split Pin for Jaw Joint
		<i>*Note :—Either of these parts are only supplied in sets (3 per set).</i>	49	V9071	Barrel Nut for Main Connecting Rod
			—	V9072A	Bendix Automatic Clutch Control Unit complete
			50	V9073A	Support Bracket for Bendix Unit (Studded)
Clutch Pit and First Motion Shaft			51	V9074A—1	Operating Rod for Bendix Valve with Nuts and
18	V9031A—1	Clutch Pit with Pedal Fulcrum Pin	52	V9075	Control Lever for Bendix Valve [Washers
19	V9032	Bearing Adjusting Nut	53	V9076A	Intermediate Control Rod for Bendix Valve with Nuts and Washers
20	V3724	Spring Ring for Adjusting Nut	54	V9077A	Suction Pipe for Bendix Cylinder
21	V3725	Oil Thrower for First Motion Shaft	55	V9078	Pin for Suction Pipe to Inlet Pipe
22	V3726	Packing Shim for Ball Bearing	56	G321	Fibre Washer for Pin
23	F656	Ball Bearing for First Motion Shaft	57	V9080	Fibre Washer for Pin
24	V9037	First Motion Shaft	58	V9081	Suction Pipe Connecting Hose
25	V9038	Constant Mesh Wheel on First Motion Shaft			<i>Note :—For Hand Control see Page 31.</i>
26	V9039	Key for Constant Mesh Wheel			<i>For Clutch Pedal see Page 33.</i>
27	GD737	Spigot Bearing in First Motion Shaft			
28	V3733—1	Cover for Clutch Pit			
29	V3734	Set Screw for Cover			
30	V9044	Distance Piece for Spigot Bearing			

Please state maker's CAR NUMBER and CHASSIS NUMBER when ordering. See note on Page 3. Prices of Spare Parts are shown on separate list.

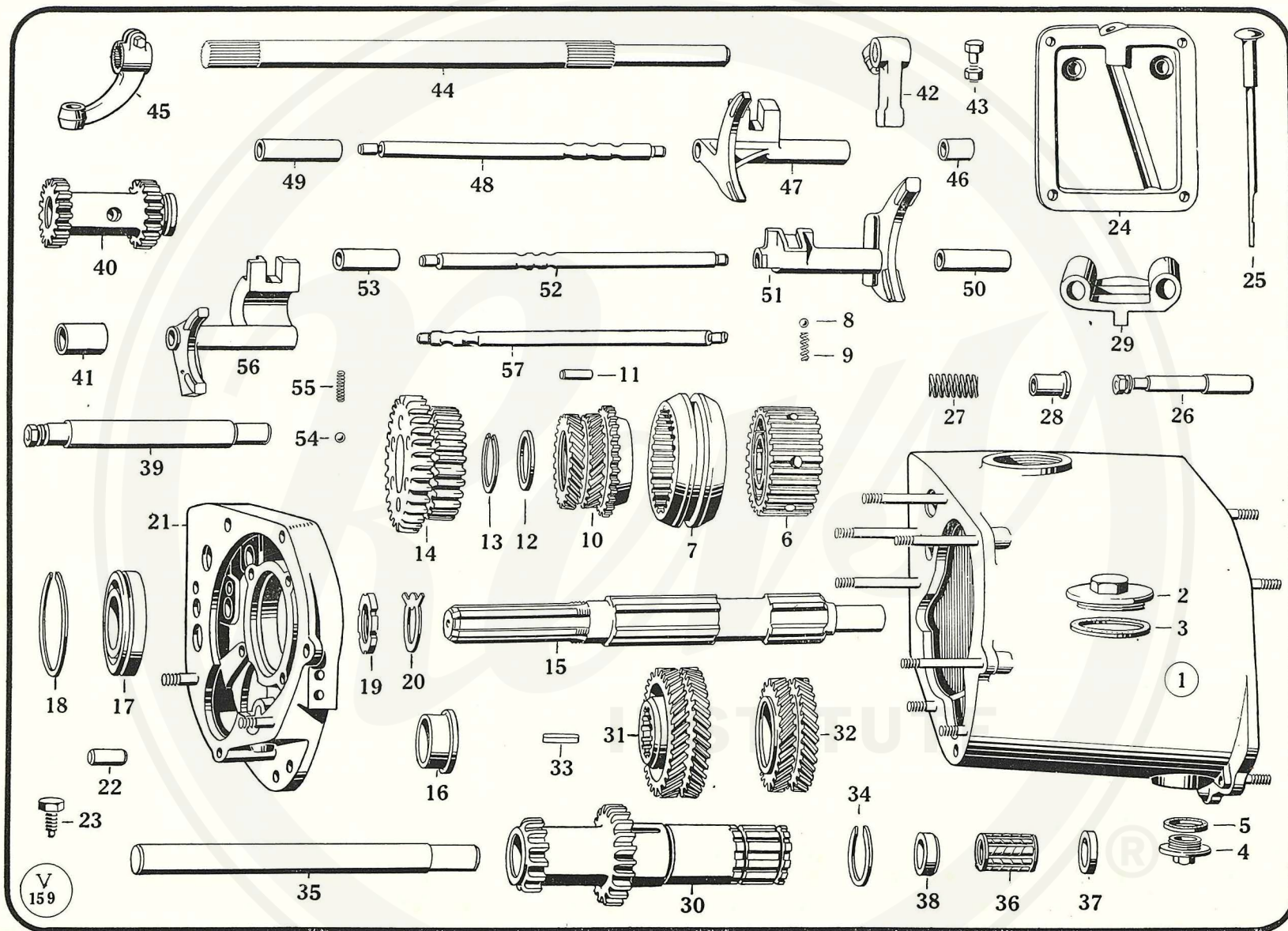

WOLSELEY 21/60 H.P. (SIX-CYLINDER) COUNTY MODEL

Gearcase and Gears, Change Speed Rods and Forks

No. of Illus- tration.	Service No. for Ordering.	Description of Part.	No. of Illus- tration.	Service No. for Ordering.	Description of Part.
Gearcase and Mainshaft			Layshaft and Layshaft Gears		
1	V9101A	Gearcase (Studded)	30	V9141	Layshaft Gear
2	E81—1	Filler Plug for Gearcase	31	V9142	Constant Mesh Gear
3	E32	Washer for Filler Plug	32	V9143	Third Speed Constant Mesh Gear
4	M709	Drain Plug for Gearcase	33	V9144	Key for Third Speed Constant Mesh
5	M710	Washer for Drain Plug	34	V3805	Spring Ring for Constant Mesh Gears
6	V9105A	Sliding Dog (Inner) with Clutch Rings	35	V9146	Layshaft
7	V9106	Third and Fourth Speed Sliding Hub	36	V828	Roller Bearing for Layshaft
8	M6805	Steel Ball for Sliding Dog	37	V9148	Distance Piece for Layshaft (Outer)
9	V9108	Spring for Ball	38	V9149	Distance Piece for Layshaft (Inner)
10	V9109A	Third Speed Dog and Clutch with Constant Mesh Wheel	Reverse Shaft and Gear		
11	M4847	Roller for Third Speed Dog	39	V9151A	Reverse Shaft with Nut and Washer
12	V9111	Washer for Rollers in Third Speed Dog	40	V9152A	Reverse Gear (Bushed)
13	V9112	Spring Ring in Third Speed Dog	41	M6843	Bush for Reverse Gear
14	V9113A	First and Second Speed Sliding Gear	Change Speed Rods and Forks		
15	V9114	Mainshaft	42	V9161A	Finger Lever on Operating Tube (inside Gearcase) with Pinch Bolt
16	V9115	Sleeve for Mainshaft Bearing		M26	Pinch Bolt for Finger Lever
17	V9116	Ball Bearing for Mainshaft		V9163A—1	Change Speed Operating Tube
18	V9117	Spring Ring for Mainshaft Bearing		V3933A	Lever on Operating Tube (Outer) with Pinch Bolt and Nut
19	V9118	Lock Nut for Mainshaft Bearing		V3934A	Pinch Bolt and Nut for Outer Lever
20	V9119	Locking Washer for Lock Nut	43	V9164	Distance Piece for Change Speed Rod (First Speed)
Gearbox Rear Cover			44	V9165	First and Second Change Speed Fork
21	V9125A	Rear Cover for Gearbox (Studded)	45	V9166	First and Second Change Speed Rod
22	V9126	Dowel for Rear Cover	46	V9167	Distance Piece for Change Speed Rod (Second Speed)
23	V9127	Locking Screw for Layshaft	47	V9168	Distance Piece for Change Speed Rod (Fourth Speed)
Gearbox Side Door and Change Speed Lock			48	V9169	Third and Fourth Change Speed Fork
24	V9131	Side Door for Gearbox	49	V9170	Third and Fourth Change Speed Rod
25	V3915A	Dipstick for Gearbox	50	V9171	Distance Piece for Change Speed Rod (Third Speed)
26	V9133A	Pin for Change Speed Lock with Nut and Washer	51	M734	Plunger Ball
27	V3911	Spring for Change Speed Lock	52	M738—1	Plunger Spring
28	V3912	Distance Piece for Change Speed Lock	53	V9174	Reverse Fork
29	V9136	Change Speed Lock	54	V9175	Rod for Reverse Fork
			55		Note :—For Change Speed Hand Lever see Page 23.
			56		
			57		

Please state maker's CAR NUMBER and CHASSIS NUMBER when ordering. See note on Page 3. Prices of Spare Parts are shown on separate list.

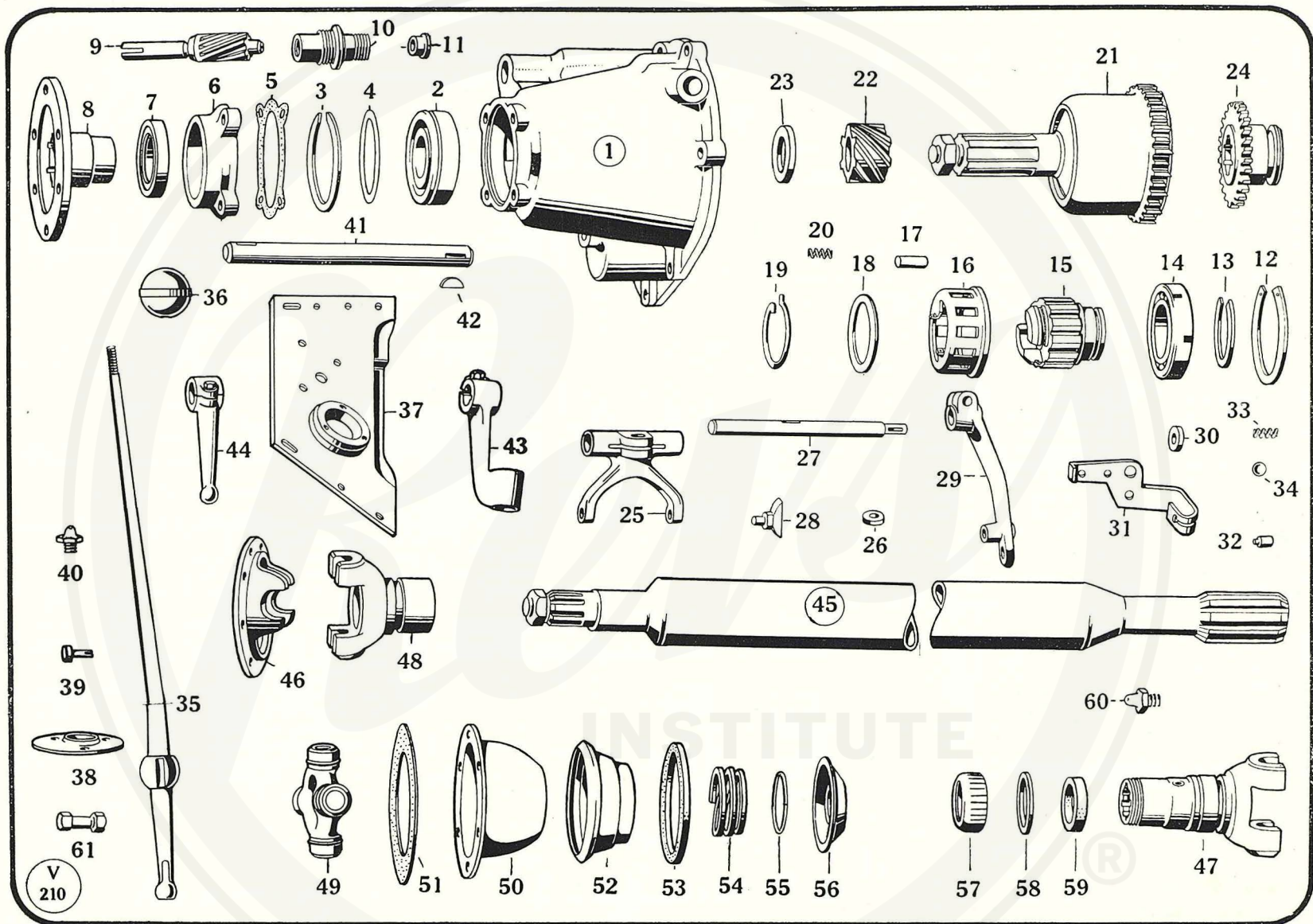

Free Wheel and Control, Change Speed Hand Lever Unit, also Propeller Shaft

No. of Illus- tration.	Service No. for Ordering.	Description of Part.	No. of Illus- tration.	Service No. for Ordering.	Description of Part.
Free Wheel Casing and Support			Change Speed Hand Lever and Rods		
1	V9201A—1	Casing for Free Wheel (Studded)	35	V9261A—1	Change Speed Hand Lever with Knob
2	V9202	Tailshaft Ball Bearing	36	M6853	Knob for Change Speed Hand Lever
3	M6823	Spring Ring in Tailshaft Bearing	37	V5923A	Cover for Change Speed complete with Cross Shaft and Bracket
4	M6909	Packing Shim for Tailshaft Bearing	38	V3925	Cover for Change Speed Lever Ball
5	V9205	Joint for Cap	39	V3926	Locking Rivet for Ball
6	V9206	Cap for Free Wheel Casing	40	TG101	Greaser for Change Speed Cross Shaft
7	V9207	Perfect Oil Seal	41	V9266	Change Speed Cross Shaft
8	V9208—1	Universal Joint Flange	42	G227	Key for Cross Shaft
9	V9209—1	Speedometer Driven Gear	43	V3930A	Lever on Cross Shaft (Off-side) with Pinch Bolt
10	M706	Bearing for Speedometer Driven Gear	—	V3931	Pinch Bolt for Levers on Cross Shaft
11	M707	Thrust Button for Speedometer Driven Gear	44	V3932A	Lever on Cross Shaft (Near-side) with Pinch Bolt
Tailshaft and Free Wheel			<i>Note :—For Change Speed Operating Tube and Levers see Page 21.</i>		
12	M6931	Spring Ring in Tailshaft	—	V9268A—1	Change Speed Hand Lever assembled with Cross Shaft, Levers and Cover
13	M6932	Spring Ring for Cam (Front)			
14	M6933	Ball Bearing for Cam			
15	M6934	Free Wheel Cam			
16	M6935A	Free Wheel Roller Cage			
17	M6936	Free Wheel Roller			
18	M6937	Slip Ring for Roller Cage			
19	M6938	Spring Ring for Cam (Rear)			
20	M6939	Spring for Free Wheel			
21	V9240A	Tailshaft with Nut and Washer	45	V9274A—1	Propeller Shaft and Universal Joint
22	V9241—1	Speedometer Driving Gear	46	V5955	Propeller Shaft with Splined Ends
23	V9242	Washer for Speedometer Driving Gear	47	V5956	Universal Joint Flange Yoke (Front or Rear)
Hand Control for Free Wheel			48	V5957	Universal Joint Sleeve Yoke (Front)
24	V9250	Free Wheel Dog	49	V5958	Universal Joint Ball Yoke (Rear)
25	M6951A	Operating Fork for Free Wheel with Pinch Bolt	50	V5960	Universal Joint Journal (Bushed) (Front or Rear)
—	V3931	Pinch Bolt for Operating Fork	51	V5961	Inner Casing (Front or Rear)
26	M6953	Key Washer for Operating Fork	52	V5962	Gasket for Yoke and Inner Casing (Front or Rear)
27	M6954	Operating Shaft for Free Wheel	53	V5963	Outer Casing (Front or Rear)
28	M6955	Monkey Block for Free Wheel Dog	54	V5964	Packing for Casing
29	M6956A	Free Wheel Control Lever (Outer) with Pinch Bolt	55	V3966	Retaining Spring for Outer Casing (Front or Rear)
—	V3931	Pinch Bolt for Control Lever	56	V5966	Baffle Spring (Front or Rear)
30	M6953	Key Washer for Control Lever	57	V5967	Baffle Cup (Front or Rear)
31	V9259	Bracket for Arens Control	58	V5968	Dust Cap for Splined Yoke (Front)
32	M6960	Dowel for Control Bracket	59	V5969	Steel Washer
33	V3908	Plunger Spring for Control Lever	—	V9293A—1	Felt Ring
34	M6962	Plunger Ball for Control Lever	60	TG108	Propeller Shaft complete
			61	V5975A	Greaser for Propeller Shaft
					Bolt, Nut and Washer for Universal Joints

Please state maker's CAR NUMBER and ENGINE NUMBER when ordering. See note on Page 3. Prices of Spare Parts are shown on separate list.

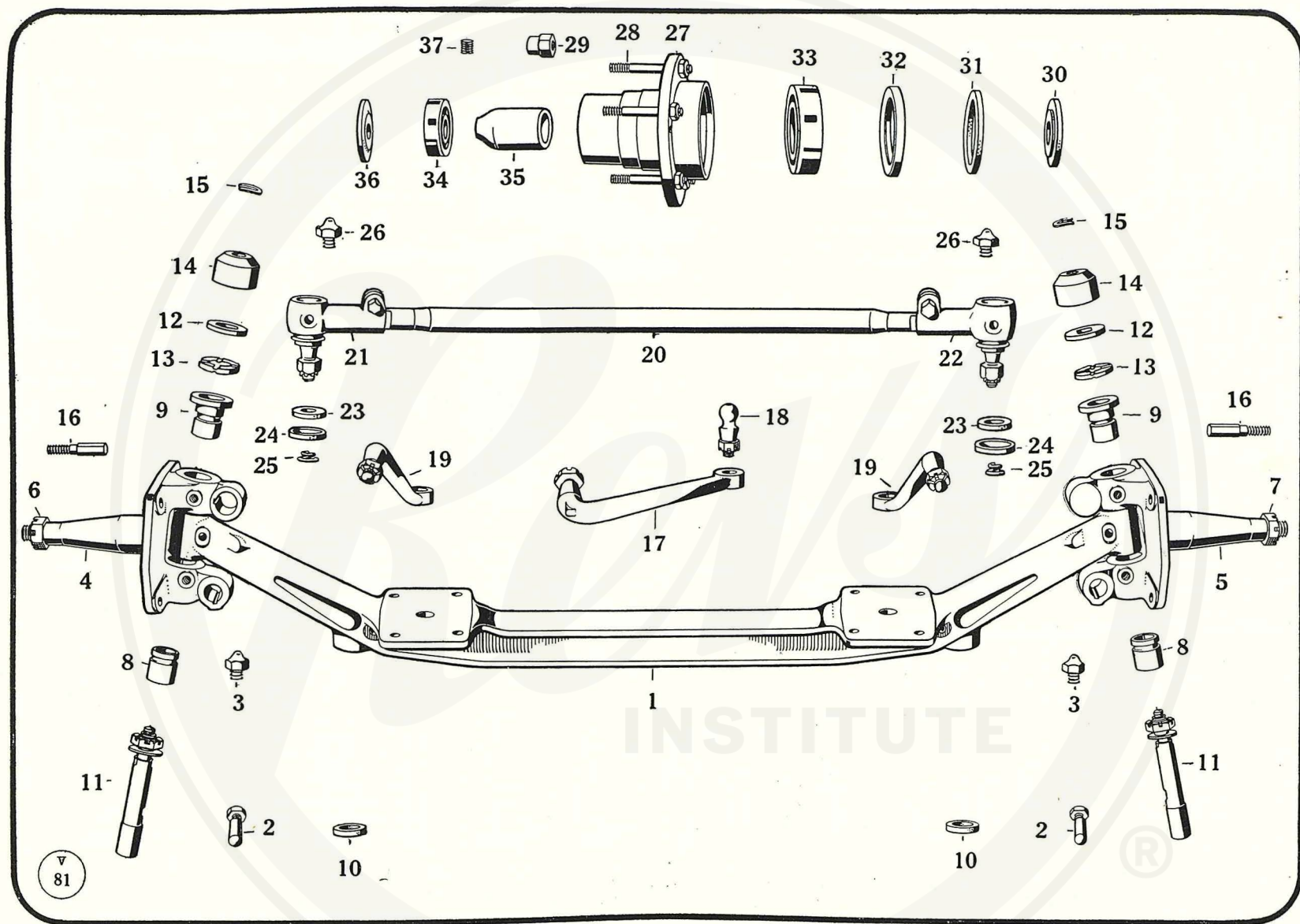

Front Axle, Front Hub and Steering Track Rod

No. of Illus- tration.	Service No. for Ordering.	Description of Part.	No. of Illus- tration.	Service No. for Ordering.	Description of Part.
Front Axle			21	V4023A	End for Track Rod (R.H. Thread) complete with Ball Pin
1	V6001	Front Axle Beam	22	V4024A	End for Track Rod (L.H. Thread) complete with Ball Pin
2	E1503A	Cotter Pin and Nut for Swivel Pin	23	V4025	Felt Washer
3	TG101	Greaser for Swivel Bushes	24	V4026	Dust Cover for Felt Washer
4	GD1005A	Swivel Axle (Off-side) (Bushed) with Nut and Greasers	25	V4027	Spring for Dust Cover
5	GD1006A	Swivel Axle (Near-side) (Bushed) with Nut and Greasers	26	TG102	Greaser for Track Rod
6	DG1022	Nut for Swivel Arm (Off-side)	Front Hub		
7	GD1023	Nut for Swivel Arm (Near-side)	27	V6034A	Front Hub (Studded)
8	GD1007	Bush for Swivel Axle (Bottom)	28	V6035A	Stud for Front Hub with Nut
9	V6008	Bush for Swivel Axle (Top)	29	V964—1	Nut for Road Wheel
10	G1042	Leather Washer for Swivel Pin	—	TG105	Greaser for Front Hub (loose in Tool Kit)
11	V6009A	Swivel Pin, with Nut and Washer	—	GD1036	Plug for Grease Hole in Front Hub
12	V6010	Lock Washer for Swivel Pin	30	GD1015	Distance Washer for Swivel Arm
13	V6011	Thrust Washer for Swivel Pin	31	GD1016	Felt Washer for Swivel Arm
14	V6012	Cover for Swivel Pin	32	GD1017	Retainer for Felt Washer
15	GD1013	Grip Piece for Cover	33	G735	Ball Bearing for Hub (Large)
16	GD1014A	Steering Lock Stop with Nut	34	GD1019	Ball Bearing for Hub (Small)
17	V6015A	Steering Lever (Off-side only) with Nut, Split Pin and Key	35	GD1020	Distance Tube between Bearings
18	V6016A	Ball Pin and Nut for Steering Lever	36	GD1021	Bearing Retaining Washer
19	V6017A	Steering Arm (Off-side or Near-side) with Nut, Split Pin and Key	<i>Note :—For Front Wheel Brake see Page 29. For Road Wheels see Page 27.</i>		
Steering Track Rod					
—	V6021A	Track Rod complete			
20	V6022	Track Rod			

Please state maker's CAR NUMBER and CHASSIS NUMBER when ordering. See note on Page 3. Prices of Spare Parts are shown on separate list.

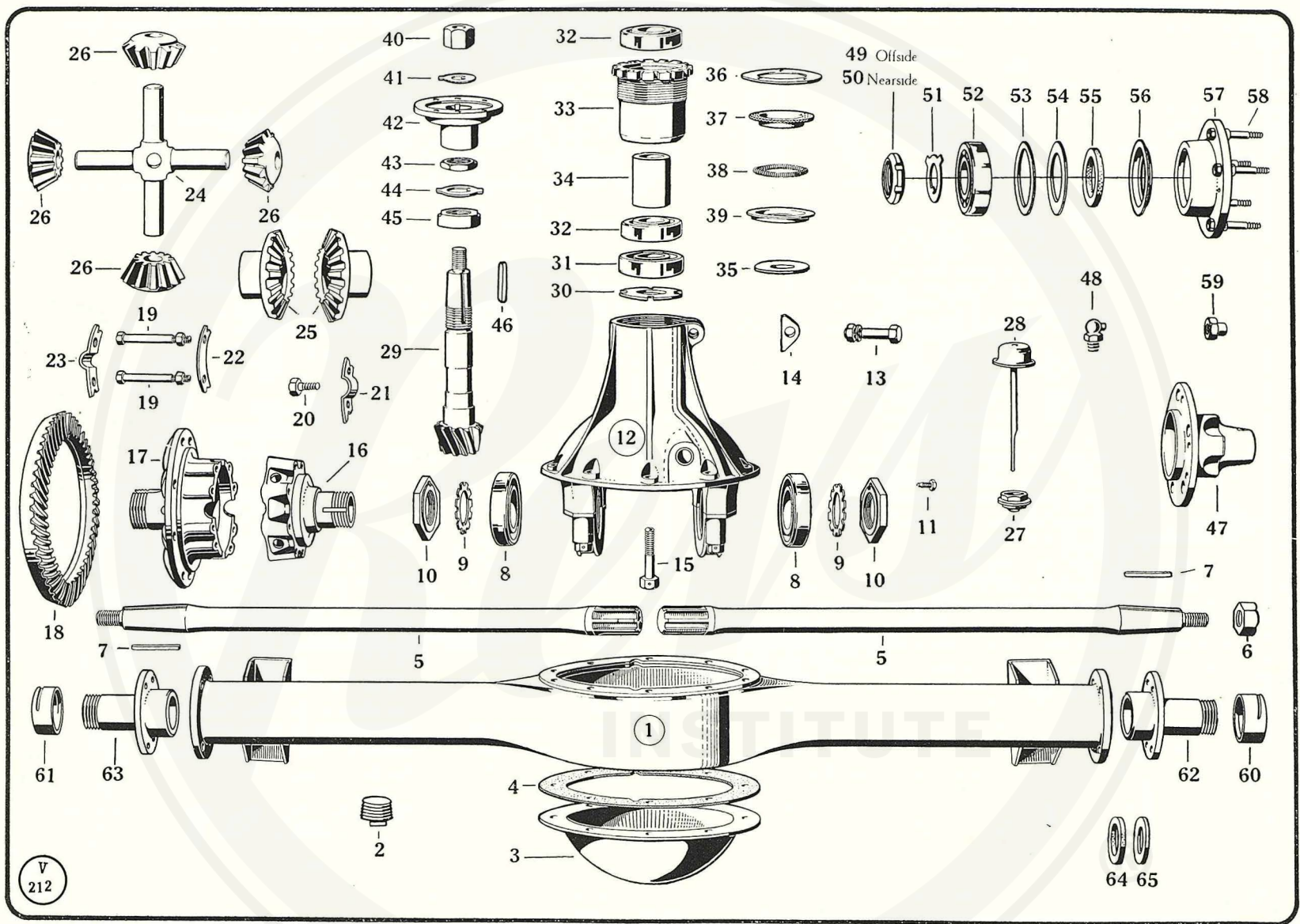

Rear Axle, Rear Hub and Road Wheels

No. of Illustration.	Service No. for Ordering.	Description of Part.	No. of Illustration.	Service No. for Ordering.	Description of Part.
Rear Axle					
1	GD902A	Axle Banjo complete with Spring Seats	39	GD938	Retainer for Endless Spring
2	G809	Drain Plug for Axle Banjo	40	V6151	Nut for Bevel Pinion
3	V6103	Rear Cover for Axle Banjo	41	V6152	Washer for Bevel Pinion Nut
4	G2807	Joint for Covers (Front or Rear)	42	V6153	Universal Flange on Bevel Pinion
Differential Shaft					
5	G2810A	Differential Shaft with Nut and Washer	43	G2840	Lock Nut for Adjusting Nut
6	V911	Nut for Differential Shaft	44	G2839	Locking Washer for Pinion Adjusting Nut
7	G811	Key for Differential Shaft	45	GD933	Pinion Adjusting Nut
Front Cover, Differential Cage and Bearings					
8	GD912	Ball Bearing for Differential Housing	46	G843	Key on Bevel Pinion for Universal Spider
9	G2817	Adjusting Washer for Differential Cage Bearing	47	GD946A	Rear Hub
10	G2816	Adjusting Nut for Differential Cage Bearing	48	TG105	Rear Hub with Greaser
11	G2818	Locking Screw for Adjusting Nut	49	GD948	Greaser for Rear Hub
12	V6119A	Front Cover complete with Differential Bearing Caps (less Dipstick)	50	GD949	Lock Nut for Wheel Bearing (Off-side)
13	GD919A	Pinch Bolt, Nut and Washer for Front Cover	51	GD950	Lock Nut for Wheel Bearing (Near-side)
14	GD920	Locking Piece for Pinch Bolt	52	GD951	Locking Plate for Lock Nut
15	G2823	Bolt for Differential Bearing Cap	53	GD951	Ball Bearing for Rear Hub
16	GD923	Differential Cage (Off-side)	54	GD998	Spacing Washer for Ball Bearing
17	V6124	Differential Cage (Near-side)	55	GD999	Packing Shim for Ball Bearing
18	V6125	Crown Wheel (11/53 ratio)	56	GD953	Oil Retaining Plate
19	V6126A	Bolt and Nut for Differential Cage	57	GD954	Cork Washer for Oil Retainer
20	V6131	Set Screw for Bevel Wheel	58	GD955	Oil Retainer Cup
21	V6132	Locking Plate for Bevel Wheel Set Screw	59	V6162A—1	Housing for Wheel Bearing assembled with Wheel Studs
22	GD927	Lock Washer for Differential Cage Bolts	60	V6164A—1	Wheel Stud with Nut
23	V6133	Locking Plate for Differential Cage Bolts	61	V964—1	Nut for Road Wheel
24	G2833	Differential Star Piece	62	V6166	Distance Piece for Wheel Bearing (Off-side)
25	G2831	Differential Wheel	63	V6167	Distance Piece for Wheel Bearing (Near-side)
26	G2832	Differential Pinion	64	GD961	Support for Wheel Bearing (Off-side)
27	V6129	Filler Plug	65	GD962	Support for Wheel Bearing (Near-side)
28	V6130A	Oil Level Dipstick with Knob and Spring	66	V6170	Oil Retaining Washer
Bevel Pinion and Bearings					
29	GD932	Bevel Pinion (11 teeth)	67	V4177	Oil Retaining Plate
30	GD942	Washer for Bevel Pinion	Road Wheels		
31	GD940	Pinion Roller Bearing	—	V6175	Road Wheel
32	V6143	Pinion Ball Bearing	—	V6176	Hub Cap
33	V6144	Housing for Pinion Bearings	Sub-Assemblies		
34	GD941	Distance Piece for Pinion Bearings	—	V6185A—1	Front Cover complete with Crown Wheel, Pinion and Differential Gears and Universal Joint Flange
35	V932	Shim for Distance Piece	—	V6186A	Front Cover complete with Pinion and Bearings and Universal Flange (less Crown Wheel and Differential Gears)
36	V6147	Cover-plate for Oil Retainer	—	V6187A	Differential Cage with Crown Wheel and Differential Gears
37	GD936	Oil Retaining Felt Ring	—	V6188A	Differential Cage with Crown Wheel (less Differential Gears)
38	GD937	Endless Spring for Oil Retainer			

Please state maker's CAR NUMBER and CHASSIS NUMBER when ordering. See note on Page 3. Prices of Spare Parts are shown on separate list.

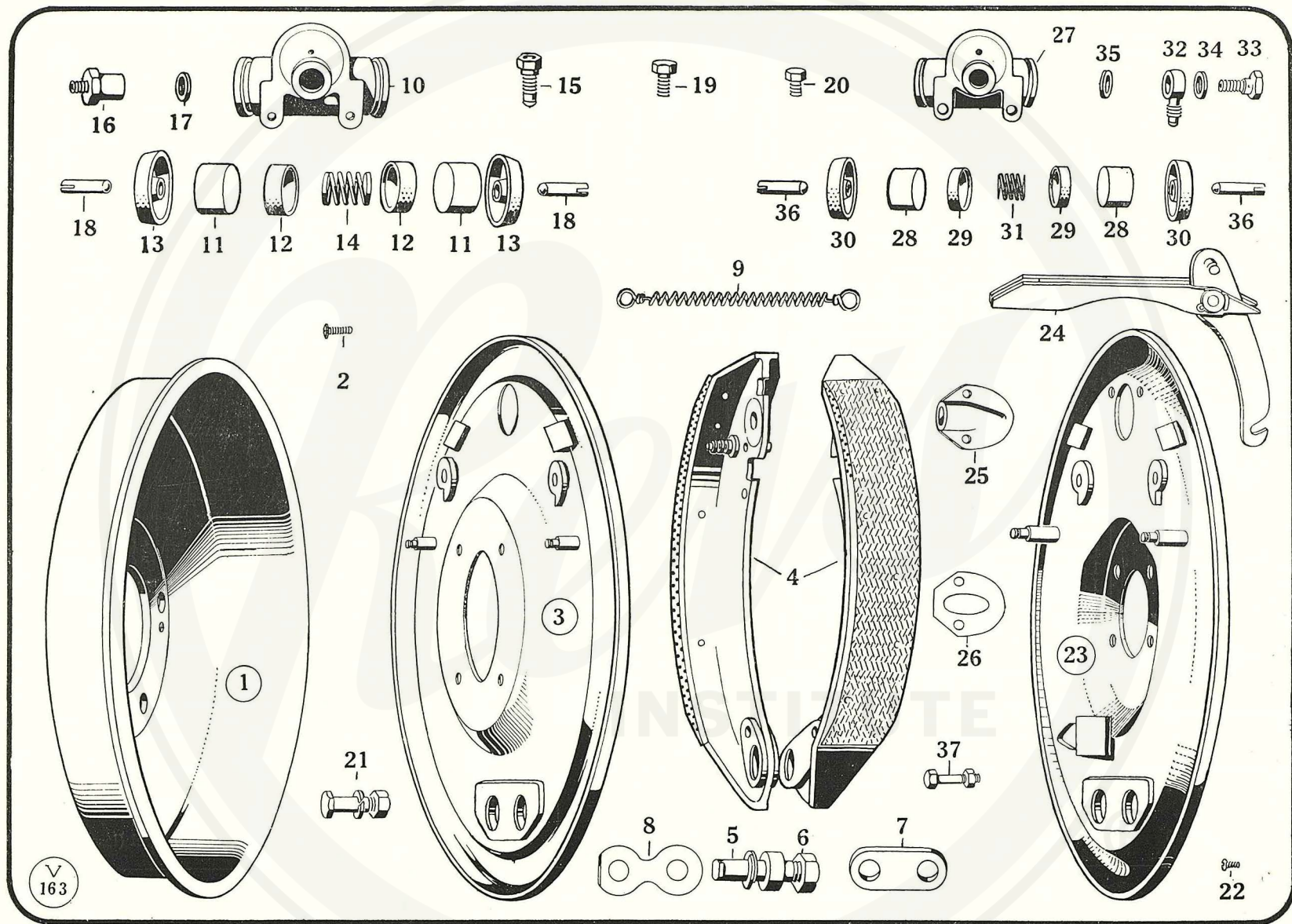

WOLSELEY 21/60 H.P. (SIX-CYLINDER) COUNTY MODEL

Brakes : Foot Brake (Lockheed Hydraulic) and Hand Brake

No. of Illustration.	Service No. for Ordering.	Description of Part.	No. of Illustration.	Service No. for Ordering.	Description of Part.
Front Wheel Brake (Foot only)			Rear Wheel Brake (Hand and Foot)		
1	V9301—1	Brake-drum	1	V9301—1	Brake-drum
2	G2878	Screw for Brake-drum	22	GD964	Screw for Brake-drum
3	V9303A—1	Back Plate assembled with Adjuster Cams and Steady Pins	23	V9333A	Back Plate assembled with Adjuster Cams and Steady Pins (Off-side)
4	V9304A	Brake-shoe assembled with Linings (Pair)	—	V9334A	Back Plate assembled with Adjuster Cams and Steady Pins (Near-side)
5	V9305	Anchor Pin for Brake-shoes	4	V9304A	Brake-shoe assembled with Lining (Pair)
6	V9306	Nut for Brake Anchor Pin	5	V9305	Anchor Pin for Brake-shoes
7	V9307	Link for Brake Anchor Pins	6	V9306	Nut for Brake Anchor Pin
8	V9308	Locking Plate for Brake Anchor Pin Nut	7	V9307	Link for Brake Anchor Pins
—	V9309	Thackeray Washer for Brake Anchor Pin	8	V9308	Locking Plate for Brake Anchor Pin Nut
9	V9310	Pull-off Spring for Brake-shoes	—	V9309	Thackeray Washer for Brake Anchor Pin
Front Wheel Cylinder			9	V9310	Pull-off Spring for Brake-shoe
10	V9315	Wheel Cylinder	24	V9343A	Hand Brake Lever Assembly (Off-side)
11	V9316	Piston for Wheel Cylinder	—	V9344A	Hand Brake Lever Assembly (Near-side)
12	V9317	Cup for Wheel Cylinder	25	V9345	Bracket for Brake Cable
13	V9318	Boot for Wheel Cylinder	26	M7246	Joint for Bracket
14	V9319	Spring for Wheel Cylinder with Retainer	Rear Wheel Cylinder		
15	V9320	Retainer for Spring	27	M7215	Wheel Cylinder
16	GD990	Bleeder Screw	28	GD983	Piston for Wheel Cylinder
17	GD1057	Inlet Connection	29	GD982	Cup for Wheel Cylinder
18	GD986	Gasket for Inlet Connection	30	GD984	Boot for Wheel Cylinder
19	V9323	Push Rod for Wheel Cylinder	31	GD981A	Spring for Wheel Cylinder with Retainer
20	GD991	Set Screw for Bleeder Screw	15	GD990	Bleeder Screw
—	GD992	Spring Washer for Set Screw	32	GD988	Inlet Connection
21	GD993	Fixing Screw for Wheel Cylinder	33	GD989	Bolt for Inlet Connection
—	V9324A	Front Wheel Cylinder complete	34	GD987	Gasket for Inlet Connection
22	V6215A	Brake Anchor Plate Bolt with Nut and Split Pin	35	GD986	Gasket for Inlet Connection
—	V9325A—1	Front Brake Assembly with Wheel Cylinders	36	V9323	Push Rod for Wheel Cylinder
—	V9326A—1	Front Brake Assembly less Wheel Cylinders	19	GD991	Set Screw for Bleeder Screw
			—	GD992	Spring Washer for Set Screw
			20	GD993	Fixing Screw for Wheel Cylinder
			—	V9377A	Rear Wheel Cylinder complete
			37	GD1073A	Brake Anchor Plate Bolt, Nut and Split Pin
			—	V9379A	Rear Brake Assembly (Off-side) with Wheel Cylinder
			—	V9380A	Rear Brake Assembly (Off-side) less Wheel Cylinder
			—	V9381A	Rear Brake Assembly (Near-side) with Wheel Cylinder
			—	V9382A	Rear Brake Assembly (Near-side) less Wheel Cylinder

Please state maker's CAR NUMBER and CHASSIS NUMBER when ordering. See note on Page 3. Prices of Spare Parts are shown on separate list.

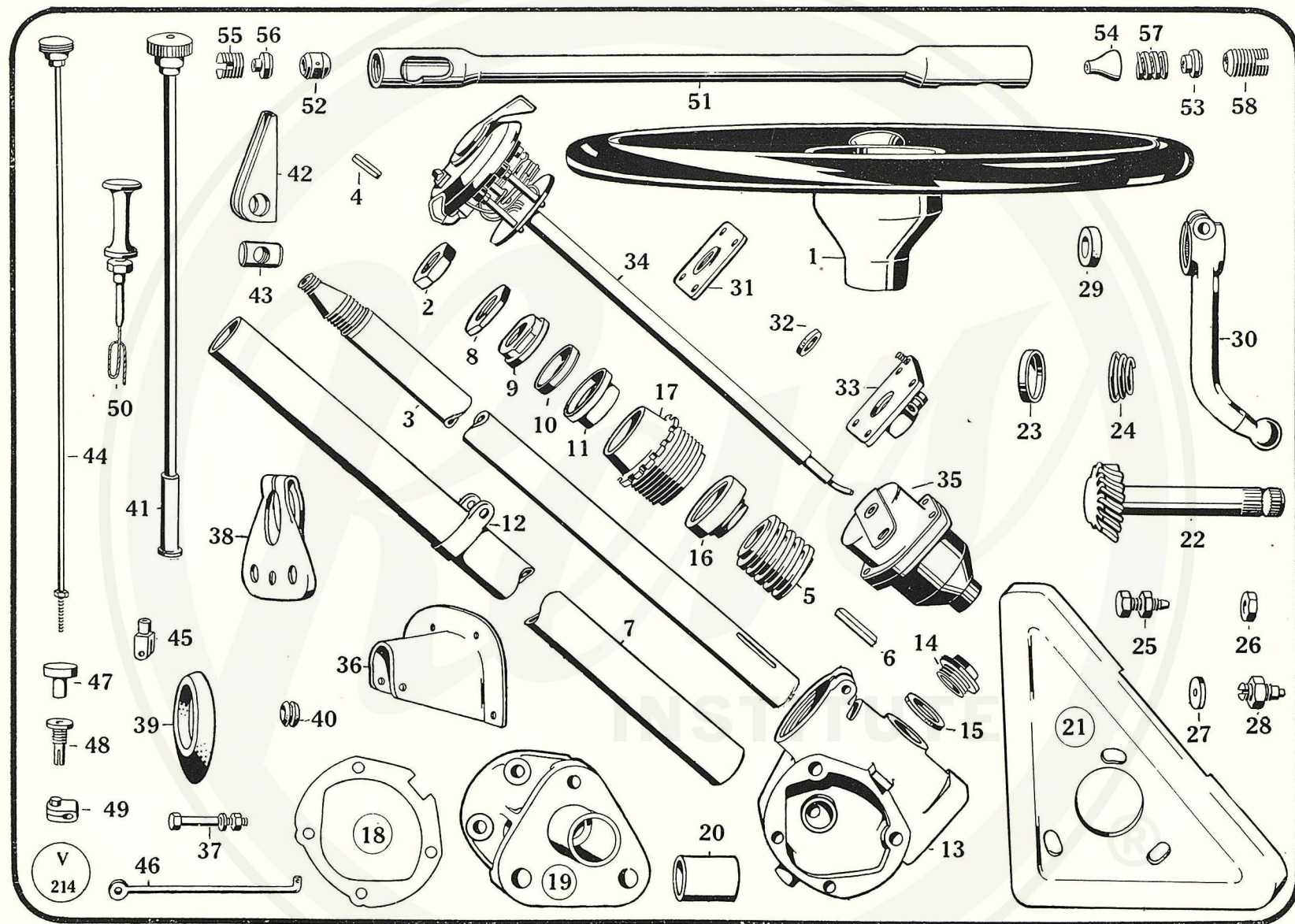

WOLSELEY 21/60 H.P. (SIX-CYLINDER) COUNTY MODEL

Control—Steering, Throttle, Jet, Free Wheel and Automatic Clutch

No. of Illus- tration.	Service No. for Ordering.	Description of Part.	No. of Illus- tration.	Service No. for Ordering.	Description of Part.
1	V4301—1	Steering Wheel			Ignition, Lamp and Horn Control
2	V4302	Retaining Nut for Steering Wheel	34	V6347A	Trafficator, Horn Press and Lighting Control Unit
3	V6303A—1	Steering Column Tube complete with Top End Piece	35	V4346—1	Switchbox complete (Lucas Model SLC2)
4	M2853	Key for Steering Wheel			Steering Column Support Details
5	V4305	Steering Worm			Support Bracket for Steering Column
6	V4306	Key for Steering Worm	36	V6351A	Bolt, Nut and Washer (Column to Bracket)
7	V6307	Cover Tube for Steering Column	37	V4352A	
8	V4308	Lock Nut for Steering Ball Race			Controls on Steering Column
9	V4309	Upper Ball Race for Steering Column			Bracket on Steering Column for Throttle and Free
—	V4310	$\frac{3}{16}$ in. dia. Steel Balls (24 per Set)	38	V4361A—1	Wheel Controls
10	V4311	Lower Ball Race for Steering Column			Bolt, Nut and Washer for Bracket
11	V4312	Housing for Lower Ball Race	—	V4362A	Rubber Seal for Column
12	V1261	Link for Cover Tube	39	V4363	Bearing for Slow Running Tube
13	V4314A	Steering Box (Studded) with Bearings	40	V4364	Slow Running Control complete with Knob, Nut
14	M709	Filler Plug for Steering Box	41	V6365A	and Adjusting Collar
15	M710	Washer for Filler Plug			Bracket for Slow Running Trunnion
—	V2215A	Pinch Bolt, Nut and Washer in Box for Bearing	42	V4366	Trunnion for Slow Running Control
16	V4318	Roller Bearing for Steering Worm [Adjustment	43	V4367	Jet Control Rod, Knob and Lock Nut
17	V2217	Adjusting Nut for Steering Worm Bearing	44	V6369A	Jaw End for Jet Control Rod with Pin
18	V2218	Shim for Steering Box	45	V4370A	Connecting Link for Jet Control
19	V4321A—1	Steering Box Bracket (Bushed)	46	V6371A	Knob for Free Wheel Control
20	V2222	Bush for Steering Box Bracket	47	M7352	Bearing for Free Wheel Control with Nut
21	V6323	Steering Box Frame Bracket	48	V4373A	Pinching Collar for Free Wheel Control with Bolt
—	V4324A	Bolt, Nut and Washer (Box Bracket to Frame Bracket)	49	V4374A	and Washer
22	V4325	Steering Worm Wheel			Free Wheel Flexible Control Rod (less Knob) with
23	V4326	Cup for Spring for Steering Box Bracket	—	V6375A—1	Jaw End
24	V4327	Spring for Steering Box Bracket			Control for Automatic Clutch complete
25	V2227A	Adjusting Screw and Nut for Worm Wheel	50	V6377	
26	V2228	Lock Nut for Adjusting Screw			Steering Draglink
27	V2229	Thrust Washer for Steering Worm Wheel			Draglink Tube
28	V2230A	Screw for Thrust Washer with Lock Nut	51	V6381	Ball Cup for Draglink Tube
29	V2231	Felt Washer for Worm Wheel	52	V4382	Spring Plunger
30	V6331A	Steering Drop Arm with Pinch Bolt, Nut, Washer	53	V4383	Plunger Spring Seat
—		and Split Pin	54	V4384	End Plug
—	V2234A	Pinch Bolt, Nut, Washer and Split Pin for Drop Arm	55	V4385	Spring Plunger
31	V4333	Retainer for Bottom Felt Washer	56	V4386	Ball Cup Spring
32	V4334—1	Felt Washer	57	V4387	End Cup
33	V4335A—1	Bottom Cover for Steering Box with Stud, Pinch	58	V4388	Greaser for Steering Draglink
—		Bolt, Nut and Washer	—	TG103	Steering Draglink complete
—	V4336A	Pinch Bolt, Nut and Washer for Bottom Cover	—	V6390A	

Please state maker's CAR NUMBER and CHASSIS NUMBER when ordering. See note on Page 3. Prices of Spare Parts are shown on separate list.

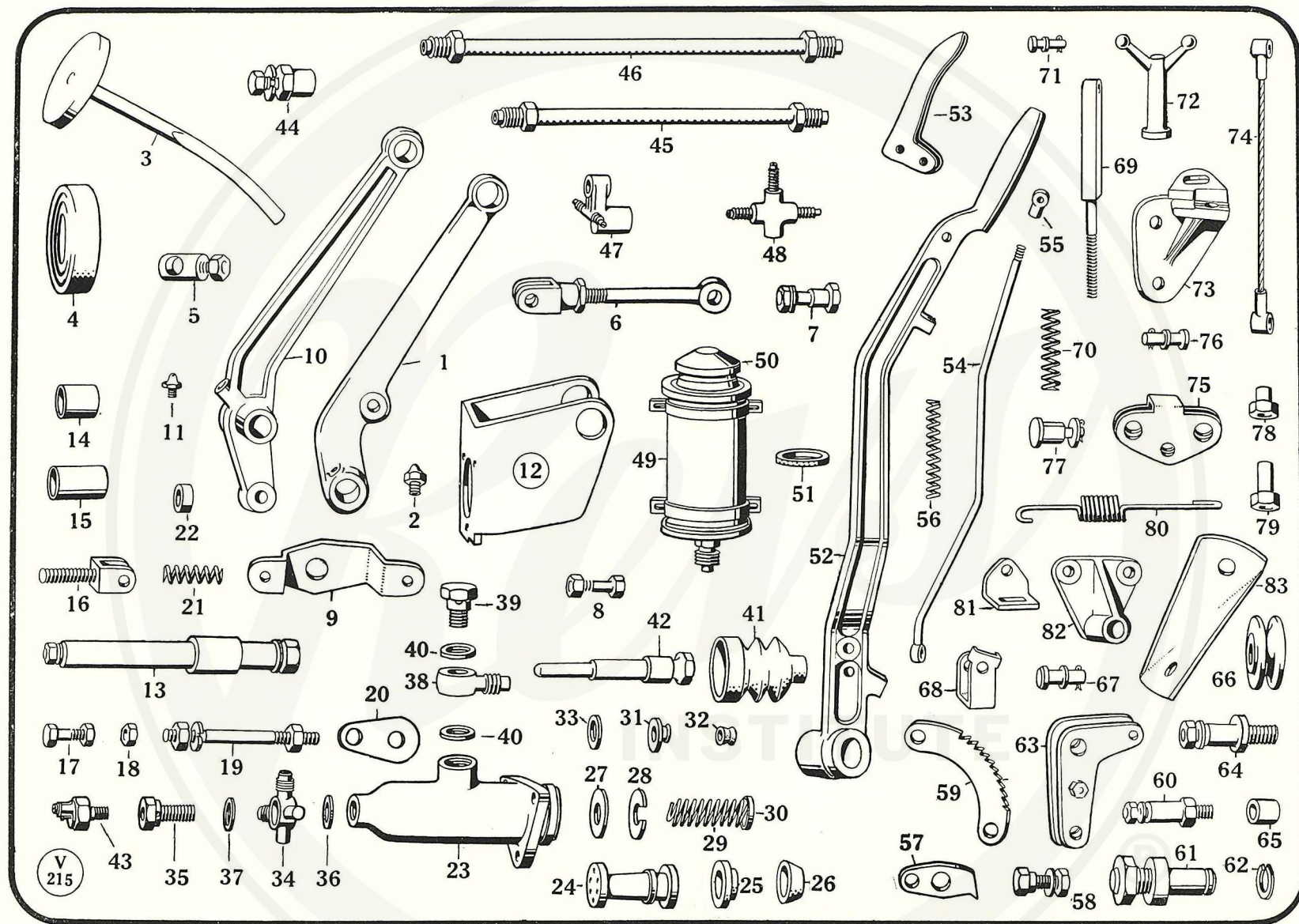

Brake Control (Hand and Foot Brakes)

No. of Illustration.	Service No. for Ordering.	Description of Part.	No. of Illustration.	Service No. for Ordering.	Description of Part.
Clutch Pedal			Lockheed Pipe Line		
1	V6401	Clutch Pedal	—	V6445A	Pipe from Master Cylinder to Three-way (O/S)
2	TG101	Greaser for Pedal	—	V6446A	Pipe from Three-way Piece to O/S Front Wheel
3	V3743A	Adjusting Rod for Clutch Pedal with Pad	—	V6447A	Pipe from Three-way Piece to N/S Front Wheel
4	V3744	Rubber Pad for Pedal Top	—	V6448A	Pipe from Master Cylinder to Rear Hose
5	F734A	Locking Pin for Adjustable Rod with Nut and Washer	—	V6449A	Pipe from Rear Hose Bracket to O/S Rear Wheel
6	V6406A	Connecting Link for Clutch Pedal with Jaw Joint	—	V6450A	Pipe from Rear Hose Bracket to N/S Rear Wheel
7	V6407A	Pin, Nut and Washer (Link to Clutch Operating Lever)	44	GD1237A	Front Hose Connection with Nut and Washer
8	V6408A	Pin and Nut (Link to Clutch Pedal)	45	V6457	Flexible Hose complete (Front Wheels)
9	V6409	Bracket for Clutch Pedal	46	V6458	Flexible Hose complete (Rear only)
		<i>Note :—For Clutch Operating Mechanism see Page 19.</i>	47	GD1244	Hose Bracket (Rear)
			48	V6452	Three-way Piece
Brake Pedal			Lockheed Supply Tank		
10	V4401	Brake Pedal	49	V1361A	Supply Tank complete with Fixing Brackets
11	TG105	Greaser for Pedal	50	M1372A	Cap for Supply Tank complete with Baffles
12	V4402A	Adjustable Rod for Pedal with Pad	51	M1373	Rubber Washer for Filler Cap
13	F734A	Locking Pin for Adjustable Rod with Nut and Washer	—	V6464A	Supply Pipe from Tank to Master Cylinder
14	V3744	Rubber Pad for Pedal			Hand Brake Control
15	V4405	Bracket for Pedal and Lockheed Master Cylinder	52	V9461	Hand Brake Lever
16	V6415A	Pin for Brake and Clutch with Nuts and Washers	53	V4472	Grip Lever
17	M3306	Distance Piece for Brake Pedal Pin (Short)	54	V9463A	Pawl Rod with Eye Piece
18	V4408	Distance Piece for Pedal Pin (Long)	55	M755	Eye Piece for Pawl Rod (Top)
19	V4409A	Eye Piece for Master Cylinder with Bolt, Nut and Lock Nut	56	E1035	Spring for Pawl Rod
20	V1310A	Bolt and Nut for Eye Piece	57	V4476	Brake Pawl
21	V1311	Lock Nut for Eye Piece	58	V4477A	Bolt for Pawl and Hand Brake Lever with Nut and Washer
22	M1309A	Stud for Master Cylinder and Brake Stop with Nuts and Washer	59	V4480	Brake Quadrant
	V4413	Brake Stop Piece	60	V9469A	Shoulder Stud, Nut and Washer for Quadrant
	M1311	Push-off Spring for Brake Pedal	61	V9472A	Fulcrum Pin for Hand Brake Lever with Nut and Washer
	V4415	Distance Piece for Master Cylinder	62	V1381	Spring Ring for Fulcrum Pin
			63	V9474A	Adjusting Lever for Hand Brake
			64	V9475A	Fulcrum Pin, Nut and Washer for Adjusting Lever
			65	V9476	Distance Piece for Adjusting Lever
			66	V9477	Pulley for Adjusting Lever
			67	V9478A	Pin, Washer and Split Pin for Pulley
			68	V9479	Cable Guard for Pulley
			69	V9480—1	Adjusting Screw for Hand Brake
			70	M7480	Spring for Adjusting Screw
			71	V9481A	Pin, Washer and Split Pin for Adjusting Screw
			72	M7482	Adjusting Nut for Hand Brake
			73	V9498	Bracket for Hand Brake Adjusting Nut
			74	V9484—1	Brake Cable to Hand Brake Lever
			75	M7485	Bridle for Hand Brake Cables
			76	M7486A	Pin, Washer and Split Pin for Bridle
			77	M7487A	Trunnion for Bridle with Washer and Split Pin
			78	M7488	Adjusting Nut (Short) for Brake Cable
			79	M7489	Adjusting Nut (Long) for Brake Cable
			80	V9490	Spring for Bridle
			81	V9491	Anchor Plate for Spring
			82	V9492	Frame Bracket for Cable (Off-side)
			—	V9493	Frame Bracket for Cable (Near-side)
			—	V9494A	Brake Cable complete (Near-side)
			—	V9495A	Brake Cable complete (Off-side)
			83	V9496	Bracket for Brake Cable Hose (Off-side)
			—	V9497	Bracket for Brake Cable Hose (Near-side)
Lockheed Master Cylinder					
23	V4421	Master Cylinder			
24	V1322	Piston for Master Cylinder			
25	V1323	Secondary Cup for Master Cylinder			
26	V1324	Cup for Master Cylinder			
27	V4424	Piston Stop			
28	V4425	Retainer for Stop			
29	V4426	Return Spring for Master Cylinder with Retainer			
30	V4427	Retainer for Return Spring			
31	V4428	Valve Body			
32	V4429	Valve Cup			
33	V4430	Valve Washer			
34	V4431	Outlet Connection			
35	V4432	Bolt for Outlet Connection			
36	GD986	Gasket for Outlet Connection Banjo			
37	V4433	Gasket for Outlet Connection			
38	V4434	Banjo Connection (Inlet)			
39	V4435	Banjo Connection Fixing Bolt			
40	V4436	Gasket for Inlet			
41	V1337	Boot for Master Cylinder			
42	V4437	Push Rod assembled with Cap			
43	M7434	Signal Lamp Switch			
—	V4439A	Master Cylinder complete			

Please state maker's CAR NUMBER and CHASSIS NUMBER when ordering. See note on Page 3. Prices of Spare Parts are shown on separate list.

WOLSELEY 21/60 H.P. (SIX-CYLINDER) COUNTY MODEL

Frame Fittings and Spring Suspension

No. of Illustration.	Service No. for Ordering.	Description of Part.	No. of Illustration.	Service No. for Ordering.	Description of Part.
Frame					
1	V6501	Frame Side Member (Off-side) (Drilled)	—	V4550	Screw for Rear Road Spring
2	V6502	Frame Side Member (Near-side) (Drilled)	36	V4551	Bush for Spring Eye (Rear)
3	V6503A	Front Dumb-iron (Off-side) (Bushed)	37	V4552A	Rear Spring Shackle with Locking Plate
4	V6504A	Front Dumb-iron (Near-side) (Bushed)	38	V4553	Locking Plate for Rear Spring Shackle
5	V6518	Bush for Front Dumb-iron	39	V4554A	Pin for Rear Spring Shackle with Nut and Split Pin
6	V6505A	Front Cross Tube	40	V6553A	Pin for Rear Spring Front Eye
7	V6506A	Front Cross Member with Radiator Support Brackets	41	V6556	Locking Plate for Rear Spring Front Eye Pin
8	V6507A	Front Spring Rear Bracket (Off-side) (Bushed)	42	V4557A	Clip for Rear Road Spring with Nuts
9	V6508	Bush for Front Spring Rear Bracket (Off-side)	—	V4560	Wick for Rear Dumb-iron
10	V6509	Front Spring Rear Bracket (Near-side)	<i>Note :—Separate Spring Plates can be supplied to order. For Spring Greasers and Fittings see Page 37.</i>		
11	V6510	Intermediate Frame Member (Off-side) (Drilled)	Shock Absorbers and Fittings		
12	V6511	Intermediate Frame Member (Near-side) (Drilled)	43	V6565	Front Shock Absorber (Off-side)
13	V6512	Front Main Cross Member and Running-board Support	—	V6566	Front Shock Absorber (Near-side)
14	V6513—1	Rear Main Cross Member and Running-board Support	—	V6567—1	Rear Shock Absorber (Off-side)
15	V6514A	Rear Dumb-iron (Off-side) (Bushed)	44	V6568—1	Rear Shock Absorber (Near-side)
16	V6515A	Rear Dumb-iron (Near-side) (Bushed)	45	V6569	Bracket for Front Shock Absorber
17	V4518	Bush for Rear Dumb-iron	46	V6570A	Combined Headlamp and Shock Absorber Bracket (Off-side)
18	V6517	Rear Cross Member	—	V6571A	Combined Headlamp and Shock Absorber Bracket
Road Springs and Suspension			47	V6572A	Pinch Bolt with Nut and Washer [(Near-side)]
19	V6524	Packing for Front Axle Pad	48	V6573	Packing Piece for Rear Shock Absorber
20	V6525A—1	Front Road Spring (Off-side) (Bushed)	49	V6574	Taper Washer for Rear Shock Absorber
—	V6526A—1	Front Road Spring (Near-side) (Bushed)	Bumpers and Fittings		
21	V4551	Bush for Front Spring Eye	50	V6575—1	Front Bumper
22	V6528A	Front Spring Clip with Nuts	51	V4576	Clamp for Front Bumper (Off-side)
23	V6529	Front Spring Shackle (Off-side or Near-side)	52	V4577	Clamp for Front Bumper (Near-side)
24	V6530	Locking Piece for Front Spring Shackle	53	V6578—1	Rear Bumper
25	V6531	Packing Piece for Front Spring Clip	54	V4582	Bracket securing Rear Bumper
26	V6532	Buffer Block Container	55	V6580	Tie Bar for Rear Bumpers
27	GD1313	Buffer Block	Battery Carrier and Details		
28	V4554A	Pin for Front Spring Shackle or Front Spring Rear (Near-side) with Nut and Split Pin	56	V4585A	Battery Carrier complete
29	V6538A	Link for Front Spring Rear Support Bracket (Off-side)	57	V6586	Support for Battery Carrier (Front)
30	V6540A	Link Pin (Front Spring Rear Support Off-side)	58	V6587	Support for Battery Carrier (Rear)
31	V6543	Damper Spring (Outer) } Front Spring Rear Support	59	V4588A	Battery securing Bolt with Wing Nut
32	V6544	Damper Spring (Inner) } (Off-side)	Sub-Assemblies		
—	V6545A	Rear Road Spring (Off-side) (Bushed)	—	V6595A—1	Frame complete
33	V6546A	Rear Road Spring (Near-side) (Bushed)	—	V6596A	Front Cross Tube assembled with Dumb-irons
—	V6547	Shock Absorber Bracket on Road Spring (Off-side)			
34	V6548	Shock Absorber Bracket on Road Spring (Near-side)			
35	V6549	Bottom Plate for Rear Road Spring			

Please state maker's CAR NUMBER and CHASSIS NUMBER when ordering. See note on Page 3. Prices of Spare Parts are shown on separate list.

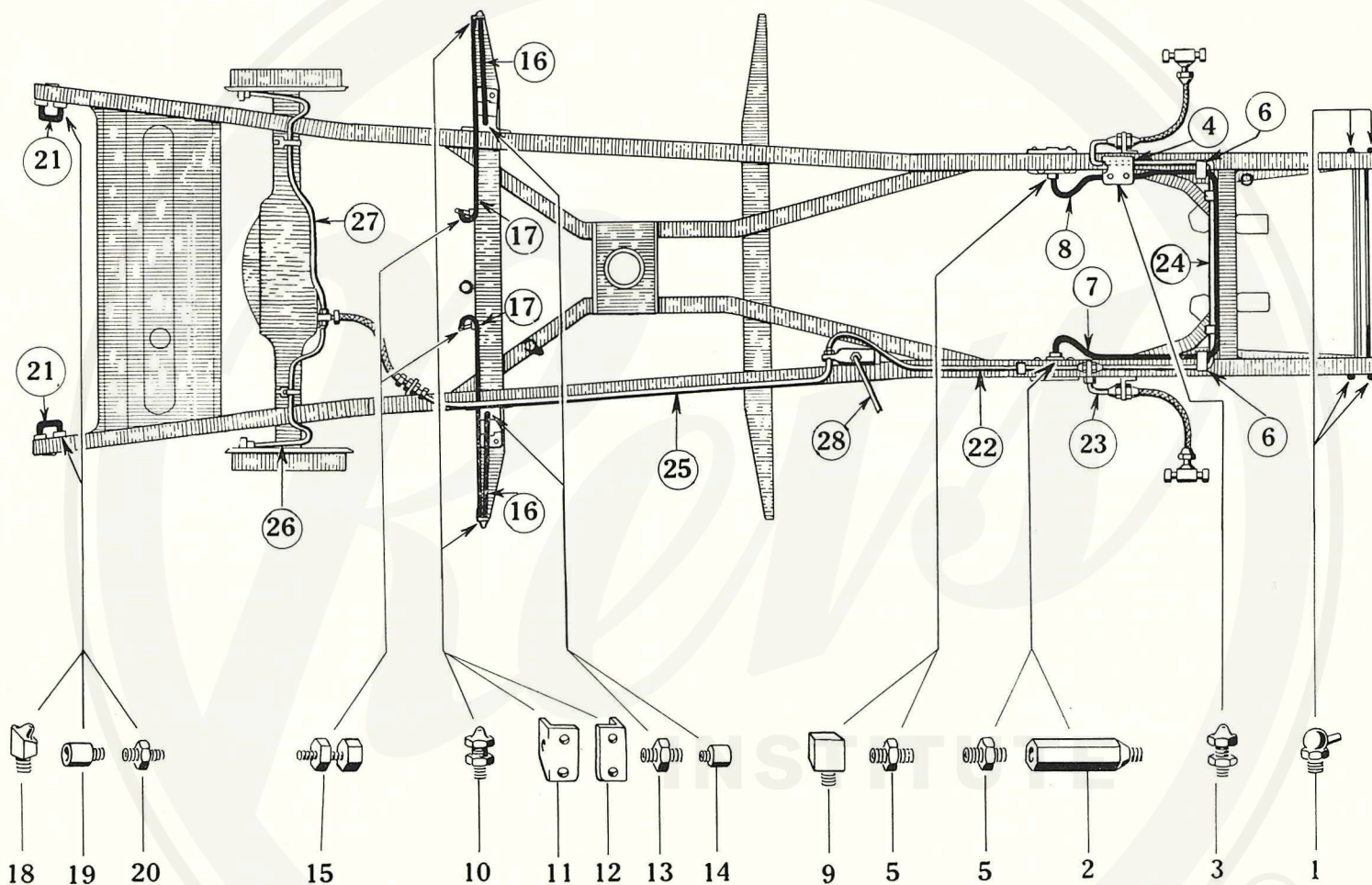

V
217

WOLSELEY 21/60 H.P. (SIX-CYLINDER) COUNTY MODEL

Grouped Greasers and Lockheed Pipes

No. of Illustration.	Service No. for Ordering.	Description of Part.	No. of Illustration.	Service No. for Ordering.	Description of Part.
GREASERS					
Road Spring Greasers					
1	TG105	Grease Plug for Front Spring Shackle	17	TG166—1	Brass Tube (Hand Brake Cable)
2	TG156	Adaptor O/S	18	TG105	Grease Plug
3	TG109	Greaser Plate Fitting	19	TG130	Extension Piece
4	TG129	Greaser Plate	20	TG124	Straight Connection
5	TG124	Straight Connection	21	TG137	Brass Tube
6	TG120	Pipe Support	<div> <div></div> <div>Rear Spring</div> <div>Shackles</div> </div>		
7	TG135	Brass Tube (Long)			
8	TG147	Brass Tube (Short)			
9	TG155	Elbow N/S	Lockheed Pipe Line		
10	TG109	Greaser Plate Fitting	22	V6445A	Pipe from Master Cylinder to Front Hose Three-way (O/S)
11	TG121—1	Greaser Plate (Off-side)	23	V6446A	Pipe from Front Hose Three-way to O/S Front Wheel
12	TG122—1	Greaser Plate (Near-side)	24	V6447A	Pipe from Front Hose Three-way to N/S Front Wheel
13	TG124	Straight Connection	25	V6448A	Pipe from Master Cylinder to Rear Hose
14	TG130	Extension Piece	26	V6449A	Pipe from Rear Hose Bracket to O/S Rear Wheel
15	TG165	Connection	27	V6450A	Pipe from Rear Hose Bracket to N/S Rear Wheel
16	TG136	Brass Tube (Spring)	28	V6464A	Supply Pipe from Tank to Master Cylinder

Please state maker's CAR NUMBER and CHASSIS NUMBER when ordering. See note on Page 3. Prices of Spare Parts are shown on separate list.

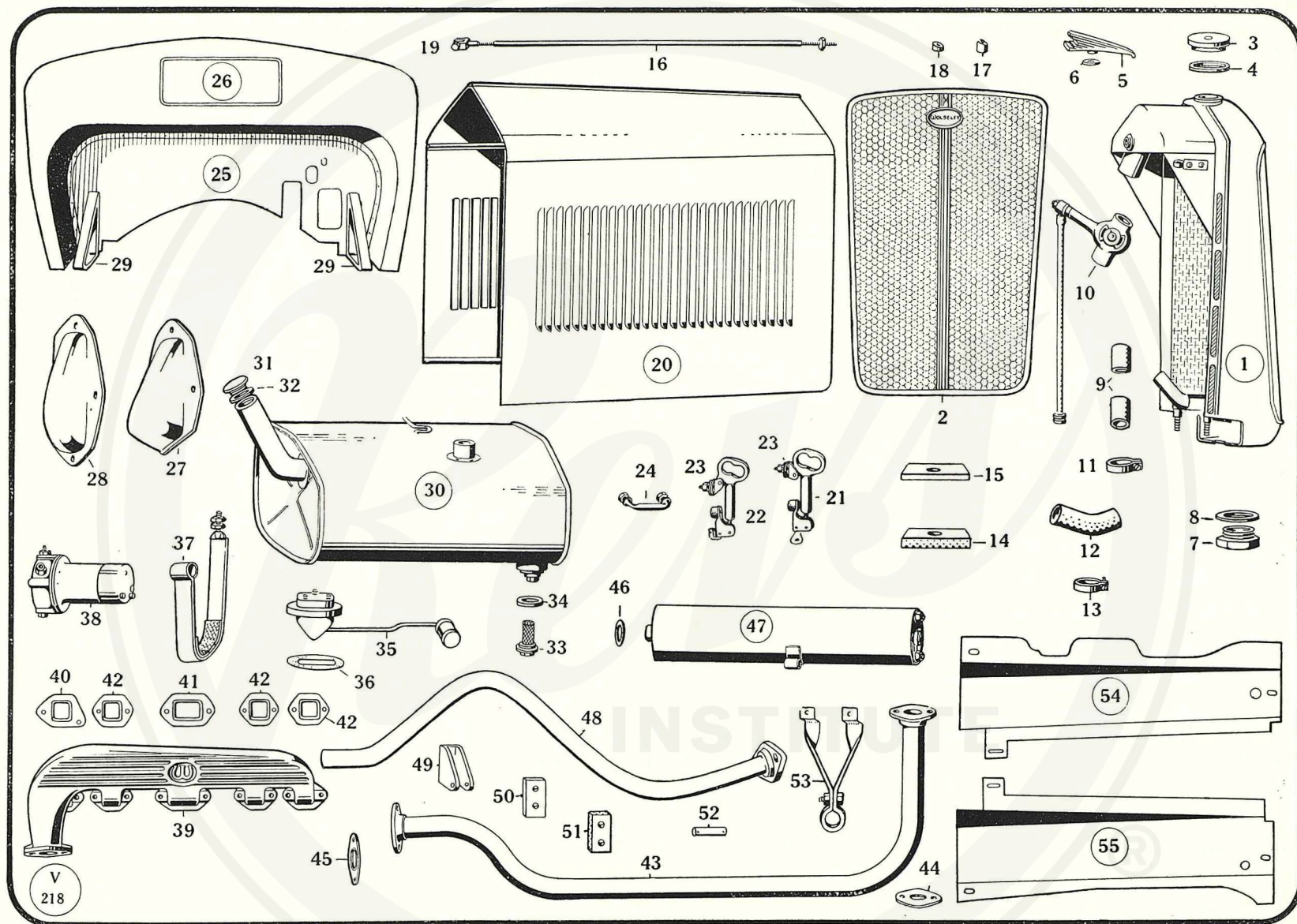

WOLSELEY 21/60 H.P. (SIX-CYLINDER) COUNTY MODEL

Radiator, Bonnet, Exhaust Pipes, Petrol Tank, etc.

No. of Illus- tration.	Service No. for Ordering.	Description of Part.	No. of Illus- tration.	Service No. for Ordering.	Description of Part.
		Radiator and Details			Petrol Tank and Petrol Pipes
1	V6601A	Radiator complete with Stone Guard	30	V6651A	Petrol Tank complete
—	V4602	Shell for Radiator	31	H1222—1	Filler Cap for Petrol Tank
2	V6603	Stone Guard for Radiator	32	M3549	Joint for Filler Cap
3	V4604	Filler Cap for Radiator	33	G1463A	Cap for Petrol Tank Sump with Strainer Gauze
4	V4605	Rubber Washer for Filler Cap	34	GD1461	Washer for Sump Cap
5	V4606	Crest for Radiator Filler Cap	35	V6656	Petrol Gauge (Tank Unit)
6	V4607	Rubber Washer for Crest	—	V4657	Cable for Petrol Gauge
7	E19	Drain Plug for Radiator	36	V4658	Joint for Petrol Gauge
8	GD12	Washer for Drain Plug	37	V6659A	Strap for Petrol Tank
9	V6610	Rubber Hose (Top)	—	V4660	Rear Packing Piece (Rubber) between Tank and Frame
10	V6611	Smith's Thermostat complete	38	M7665	Petrol Pump complete
11	G1408	Clip for Top Rubber Hose	—	V6663A	Petrol Pipe (Main Feed to Tank) complete
12	V6612	Rubber Hose (Bottom)	—	V6666A	Petrol Pipe (Main Feed to Pump) complete
13	M1509	Clip for Bottom Rubber Hose	—	V6667A	Petrol Pipe (Pump to Carburetter) complete
14	V4614	Rubber Packing for Radiator Support			
15	V4615	Packing Washer for Radiator			
16	V6616A	Radiator Tie Rod complete			
17	V4617	Washer for Tie Rod			
18	V4618	Distance Piece for Tie Rod			
19	V4619	Bolt for Jaw Joint			
		<i>Note :—For Radiator Medallion see Page 15.</i>			
		Bonnet and Bonnet Catches			Silencer and Exhaust Pipes
20	V6625A	Bonnet complete	39	V4675	Exhaust Branch
21	V6627	Front Bonnet Catch with Fixing Bracket	40	V4676	Joint for Exhaust Branch (Front)
22	V6628	Rear Bonnet Catch with Fixing Bracket	41	V4677	Joint for Exhaust Branch (Centre)
23	V4629	Bonnet Catch Yoke with Nut (Front or Rear)	42	V4678	Joint for Exhaust Branch (Intermediate or Rear)
24	GD1418A—1	Bonnet Handle with Nuts and Washers	43	V6679A	Exhaust Pipe (Engine to Silencer) with Flanges
			44	H1211	Joint (Exhaust Pipe to Manifold)
			45	G1452	Joint (Exhaust Pipe to Silencer) (Front)
			46	G1454	Joint (Exhaust Pipe to Silencer) (Rear)
			47	V4680A	Silencer complete
			48	V6681A—1	Exhaust Tail Pipe with Flange
			49	V6683	Silencer Support Bracket on Frame
			50	V4684	Plate for Silencer Support Bracket
			51	V4685	Rubber Packing for Support Plate
			52	G1457A	Pin for Silencer Support Bracket
			53	V6686A	Rear Exhaust Pipe Support Bracket with Pinch Bolt and Nut
		Dashboard and Fixing Brackets			Undershields
25	V6641A—1	Dashboard and Shroud complete	54	V6691	Undershield (Off-side)
26	V6642A	Trap Door for Back Dashboard	55	V6692	Undershield (Near-side)
27	V4643	Cover for Clutch Pedal			
28	V4644	Cover for Brake Pedal			
29	V4645A—1	Support Bracket for Dashboard and Toe Boards			

Please state maker's CAR NUMBER and CHASSIS NUMBER when ordering. See note on Page 3. Prices of Spare Parts are shown on separate list.

Wings and Stepboards, and Carriage Fittings

Service No. for Ordering.	Description of Part.	Service No. for Ordering.	Description of Part.
Front Wings and Stays V6701A Front Wing (Off-side) V6702A Front Wing (Near-side) V6703 Front Wing Make-up Piece (Off-side) V6704 Front Wing Make-up Piece (Near-side) V6705A Front Wing Front Stay (Off-side) V6706A Front Wing Front Stay (Near-side) <i>Note:—For Headlamp Support see Page 15.</i> V6707 Front Wing Rear Stay (Off-side) V6708 Front Wing Rear Stay (Near-side) V6715 Bonnet Ledge (Off-side) V6716 Bonnet Ledge (Near-side) V6717 Bonnet Valance (Off-side) V6718 Bonnet Valance (Near-side) V6719 Front Apron		Carriage Fittings V4761 Screen complete V4762 Glass for Front Screen V4763 Screen Wiper complete with Dual Arms V4764 Front Door Glass V4765 Rear Door Glass V6766 Hinged Quarter-light (Off-side) V6767 Hinged Quarter-light (Near-side) V6768 Glass for Quarter-light V6769 Front Door Louvre (Off-side) V6770 Front Door Louvre (Near-side) V6771 Rear Door Louvre (Off-side) V6772 Rear Door Louvre (Near-side) V4767 Back-light Glass	
Rear Wings V6721—2 Rear Wing (Off-side) V6722—2 Rear Wing (Near-side) V6723 Rear Apron		Door Locks, Hinges, etc. V9808 Door Dovetail complete V9809 Door Buffer V9810 Front Door Lock and Garnish Rail, also Window Winder (Off-side) V9811 Front Door Lock and Garnish Rail, also Window Winder (Near-side) V9812 Rear Door Lock and Garnish Rail, also Window Winder (Off-side) V9813 Rear Door Lock and Garnish Rail, also Window Winder (Near-side) V9814 Window Winder Mechanism (less Handle) (Front Off-side) V9815 Window Winder Mechanism (less Handle) (Front Near-side) V9816 Window Winder Mechanism (less Handle) (Rear Off-side) V9817 Window Winder Mechanism (less Handle) (Rear Near-side) V9818 Door Handle (Plain) V9819 Door Handle (with Private Lock) V9843 Handle for Window Winder V9820 Front Door Top Hinge (Off-side) V9821 Front Door Top Hinge (Near-side) V9822 Front Door Centre Hinge (Off-side) V9823 Front Door Centre Hinge (Near-side) V9824 Front Door Bottom Hinge (Off-side) V9825 Front Door Bottom Hinge (Near-side) V9826 Rear Door Top Hinge (Off-side) V9827 Rear Door Top Hinge (Near-side) V9828 Rear Door Centre Hinge (Off-side) V9829 Rear Door Centre Hinge (Near-side) V9830 Rear Door Bottom Hinge (Off-side) V9831 Rear Door Bottom Hinge (Near-side) V9832 Striking Plate for Door Lock V9833—1 Door Check Strap V9834 Buckle for Door Check Strap	
Stepboards V6731A Stepboard (Off-side) complete with Covering and Edging V6732A Stepboard (Near-side) complete with Covering and Edging			
Spare Wheel Carriers V6735A Spare Wheel Steady Tube complete with Brackets V6736 Rubber Packing for Tyre Pad V6737 Rubber Ferrule for Tyre Pad V6738 Screw for Ferrule and Packing V6739A Spare Wheel Steady Pin with Nuts and Washers V6740 Lug for Spare Wheel Steady Pin V6741 Packing Piece for Steady Pin V6742 Taper Rubber Washer for Steady Pin or Wing V6743 Taper Steel Washer for Wing V6744 Disc for Spare Wheel Bracket V6745 Clamp Plate for Spare Wheel V6746A Stud for Spare Wheel with Nut and Washer V964—1 Cap Nut for Spare Wheel V6748 Spare Wheel Cover			
Luggage Grille and Brackets V6751 Bracket for Luggage Grille (Off-side) V6752 Bracket for Luggage Grille (Near-side) V6753A Bracket for Luggage Grille (Beaded) V6754A—1 Luggage Grille complete with Links V6755A Bolt, Nut and Washer (Link to Bracket) V6756A Bolt, Nut and Washer (Link to Side Support) V6757A Locking Pin for Grille with Nut and Washer V6758 Spring Clip for Grille		Scuttle Ventilators M7785A Scuttle Ventilator (Off-side) M7786A Scuttle Ventilator (Near-side)	

Please state maker's CAR NUMBER when ordering. See note on Page 3. Prices of Spare Parts are shown on separate list.

WOLSELEY 21/60 H.P. (SIX-CYLINDER) COUNTY MODEL

Tools, etc.

Service No. for Ordering.	Description of Part.
M3727	Double-ended Spanner ($\frac{3}{16}$ in. \times $\frac{1}{4}$ in.)
M3728	Double-ended Spanner ($\frac{5}{16}$ in. \times $\frac{3}{8}$ in.)
M3729	Double-ended Spanner ($\frac{7}{16}$ in. \times $\frac{1}{2}$ in.)
M3724	Box Spanner ($\frac{3}{16}$ in. \times $\frac{1}{4}$ in.)
V4807	Box Spanner ($\frac{5}{16}$ in. \times $\frac{3}{8}$ in.)
V4808	Box Spanner ($\frac{7}{16}$ in. \times $\frac{1}{2}$ in.)
V4809	Box Spanner ($\frac{5}{8}$ in. \times $\frac{9}{16}$ in.)
M3730	Tappet Spanner
M3731	Feeler Gauge with .003 in. Feeler in Cage
M3723	Adjustable Spanner
V4815	Sparking Plug Spanner
V4817	Tommy Bar
M3739	Tommy Bar
G1666	Adaptor for Oil Drain Plug
E1254—1	Wheel Brace
E1269	Tyre Pump
V4802	Lifting Jack
V4803	Handle for Lifting Jack
G1665	Cross Bar for Handle
V1913	Tyre Levers (Pair)
V6822A	Starting Handle
M5714	Grease Gun
GD1603	Bleeder Wrench
GD1604	Drain for Bleeder Screw
GD1605	Drain Tube

} for Lockheed Brake

Please state maker's CAR NUMBER when ordering. See note on Page 3. Prices of Spare Parts are shown on separate list.